



Craig Snodgrass, CPA, CGFM  
Lorain County Auditor  
Lorain County Admin. Building  
226 Middle Ave., 2nd Floor  
Elyria, OH 44035  
Phone: (440) 329-5207

#### Owner Information

Parcel Number	01-00-003-101-009
Owner Name & Address	LUKUCH PATRICIA M & LUKUCH EDWARD M
Tax Bill Mailed to	LUKUCH PATRICIA M 3722 EDGEWATER DR VERMILION, OH 44089

#### Property Information

Location Address	3722 EDGEWATER BLVD VERMILION, OH 44089
Property Description	VER ON LAKE 1 FRNT 0045.07 DPTH 0133.00
Tax District	16 - BROWNHelm TWP / VERMILION CITY / VERMILION LSD
Land Use	510 - SINGLE FAM DW PLAT LOT
Neighborhood	20100 - VERMILION CITY - LAKEFRONT
Acres	0.0000
Instrument Number	990641146

#### Value Information:

Market Land Value	\$75,240
Market Building Value	\$129,250
Market Total Value	\$204,490
Market CAUV	\$0
Assessed Land Value	\$26,330
Assessed Building Value	\$45,240
Assessed Total Value	\$71,570
Assessed CAUV	\$0

#### Residential Information, Structure #652247

Year Built	1950
Finished Sqft	2298
Total Rooms (excludes bathrooms)	8
Bedrooms	5
Full Bath	1
Half Bath	1
Fireplace	Yes
Basement, Crawl Space, Slab	See Sketch
Central AC	Yes

#### Improvement: Attached/Integral Garage

Attribute	Frame Construction
Square Feet	782

#### Improvement: Porches

Attribute	Enclosed Frame Porch
Square Feet	340

#### Improvement: Porches

Attribute	Enclosed Masonry Porch
Square Feet	150

#### Improvement: Porches

Attribute	
Square Feet	121

### 2013 Full Year Tax Information

Full Year Tax Before Adjustments	\$7,275.60
-State Credit	\$2,710.90
Subtotal	\$4,564.70
-Non-business Credit	\$452.18
-Owner Occupancy Credit	\$110.00
-Homestead Credit	\$0.00
Annual Real Estate Tax	\$4,002.52
Current Special Assessments	\$0.00
Delinquent Special Assessments	\$0.00
Unpaid Taxes	\$0.00
Full Year Tax (includes any unpaid taxes & special assessments)	\$4,002.52
Total Taxes Paid to Date	\$0.00
Special Assessments (YES/NO)	NO

### Tax Disclaimer

Your 2013 taxes were certified on December 30, 2013. The full year tax includes all unpaid taxes and special assessments. Please verify the actual tax amount due through the Lorain County Treasurer's Office at 440-329-5787. Taxes and payments are listed for Tax Year 2013, payable in 2014.

### Property Photo: 1





0100003101009



Building Sketch: 1

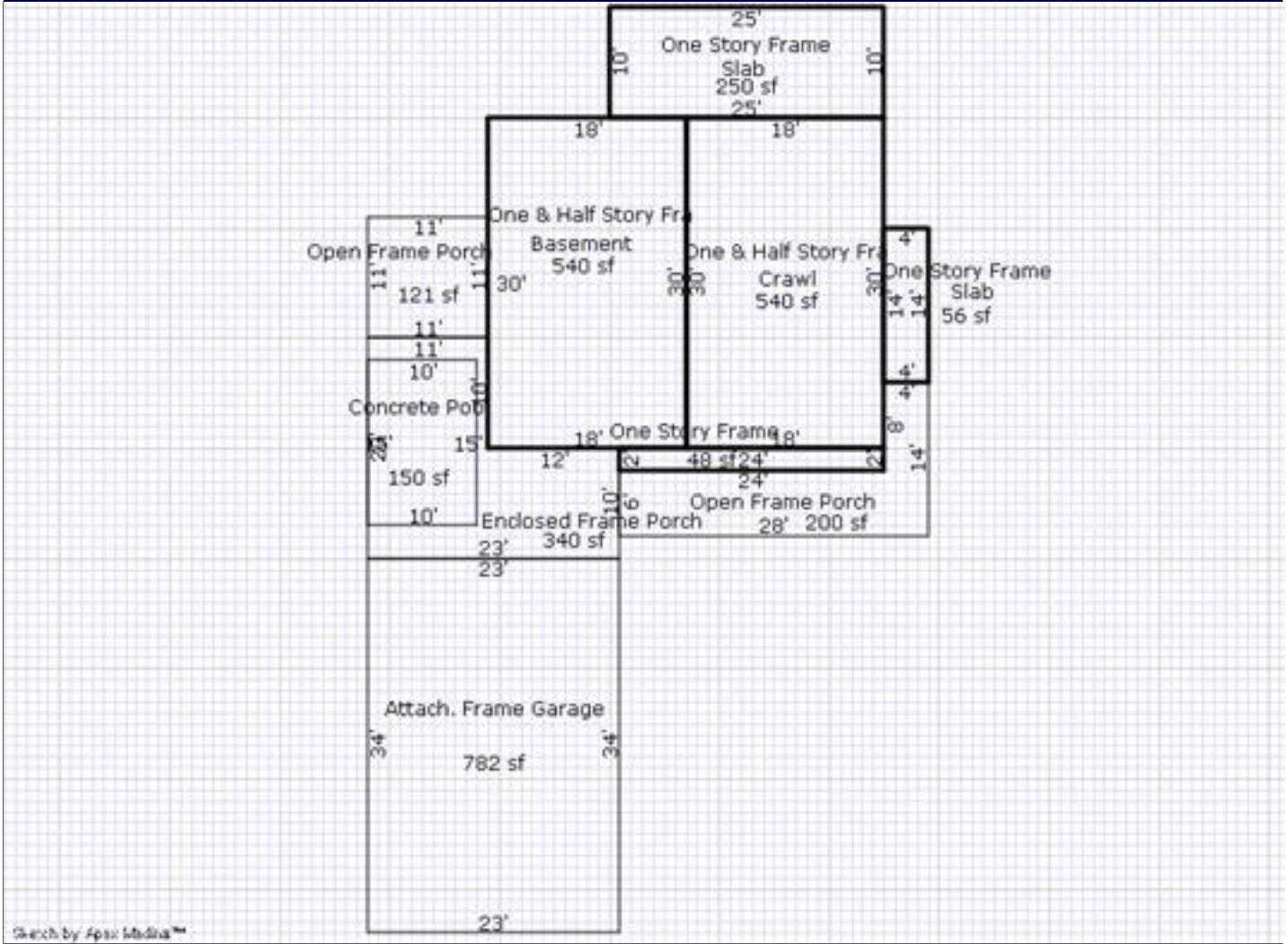

Sketch by Apsix Media™

.11 .26

45.05	45.06	45.05	45.06	45.05
<b>51 -007</b> 133.27	<b>52 -008</b>	<b>53 -009</b> 132.94	<b>54 -010</b> 132.29	<b>55 -011</b> 131.30
45.04	45.06	45.07	45.08	45.12



Craig Snodgrass, CPA, CGFM  
Lorain County Auditor  
Lorain County Admin. Building  
226 Middle Ave., 2nd Floor  
Elyria, OH 44035  
Phone: (440) 329-5207

### Owner Information

Parcel Number	01-00-003-101-008
Owner Name & Address	LUKUCH PATRICIA M & LUKUCH EDWARD M
Tax Bill Mailed to	LUKUCH PATRICIA M 3722 EDGEWATER DR VERMILION, OH 44089

### Property Information

Location Address	EDGEWATER BLVD VERMILION, OH 44089
Property Description	VER ON LAKE 1 FRNT 0045.06 DPTH 0133.00
Tax District	16 - BROWNHelm TWP / VERMILION CITY / VERMILION LSD
Land Use	500 - RESIDENTIAL VACANT LAND
Neighborhood	20100 - VERMILION CITY - LAKEFRONT
Acres	0.0000
Instrument Number	990641146

### Value Information:

Market Land Value	\$75,240
Market Building Value	\$0
Market Total Value	\$75,240
Market CAUV	\$0
Assessed Land Value	\$26,330
Assessed Building Value	\$0
Assessed Total Value	\$26,330
Assessed CAUV	\$0

### 2013 Full Year Tax Information

Full Year Tax Before Adjustments	\$2,676.62
-State Credit	\$997.30
Subtotal	\$1,679.32
-Non-business Credit	\$166.36
-Owner Occupancy Credit	\$0.00
-Homestead Credit	\$0.00
Annual Real Estate Tax	\$1,512.96
Current Special Assessments	\$105.38
Delinquent Special Assessments	\$0.00
Unpaid Taxes	\$0.00
Full Year Tax (includes any unpaid taxes & special assessments)	\$1,618.34
Total Taxes Paid to Date	\$0.00
Special Assessments (YES/NO)	YES - contact Auditor's Office at 440-329-5212 for details.

### Tax Disclaimer

Your 2013 taxes were certified on December 30, 2013. The full year tax includes all unpaid taxes and special assessments. Please verify the actual tax amount due through the Lorain County Treasurer's Office at 440-329-5787. Taxes and payments are listed for Tax Year 2013, payable in 2014.

45.06	45.05	45.06	45.05	45.06
<b>50 -006</b> 132.93	<b>51 -007</b> 133.27	<b>52 -008</b>	<b>53 -009</b> 132.94	<b>54 -010</b> 132.29
45.03	45.04	45.06	45.07	45.08