

# Clark County, Ohio - Property Record Card

## Parcel: 0100500023000019 Card: 1

**Owner** LEMASTER KATHY L,  
**Address** 9692 NEW CARLISLE PIKE NEW CARLISLE 45344  
**Tax/School District** 010 / TECUMSEH LSD  
**Land Use** (511) SINGLE FAMILY, 0-9.999 AC UNPLATTED  
**Class** RESIDENTIAL  
**Legal Description** S MID PT N E QR

**MAP**



**SKETCH**

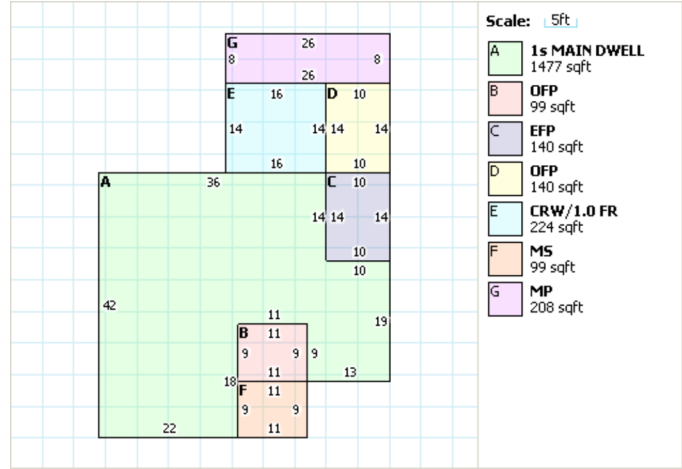

**RESIDENTIAL**

Building Style	RANCH	FullBaths	2	Owner/Occupied Credit:	YES
Sq.Ft. (incl. fin. basement)	1701	Half Baths	0	Homestead Credit:	YES
Year Built	1941	Basement	PART	Special Assessment:	NO
Stories	1	Finished Basement Area	0		
Exterial Wall	ALUMINUM/VINYL	Rec Room Area	0		
Rooms	6	Heat Fuel Type	OIL		
Bedrooms	3	Heat/Cool	CENTRAL A/C		
Family Rooms	0	Attic	NONE		
Fireplace Openings(Stacks)	1(1)	Trim	0		

**LAND**

Code	Frontage	Depth	Acreage	SqFt	Value
1	0	0	1	N/A	\$25,000.0
8	0	0	0.31	N/A	\$1,940.00
9	0	0	0.09	N/A	\$0.00

**VALUATION**

	Appraised	Assessed
Land Value	\$26,940.00	\$9,430.00
Building Value	\$66,130.00	\$23,150.00
Total Value	\$93,070.00	\$32,580.00
CAUV Value		\$0.00
Taxable Value		\$32,580.00
Net Annual Tax		\$4,201.49

**PERMITS**

**IMPROVEMENTS**

Card	Description	Year Built	Dimensions	Value
1	RG1 - FRAME	1949	24x20	\$2,930.00
1	RS1 - FRAME	2006	11x14	\$1,100.00

**SALES**

Date	Buyer	Seller	Price	Validity
3/9/2009	LEMASTER KATHY L	SCHRIEVER LISA M	\$85,800.00	S SHERIFF
11/22/2004	SCHRIEVER LISA M	BURROWES THOMAS A & JANEVA M	\$113,000.00	
4/1/1996			\$119,000.00	

