

Print

LOT F1

Close

PARID: E20 01007 0001

PARCEL LOCATION: 700 SHILOH SPRING RD

NBHD CODE: C3003HAR

Owner

Name

WAMPLER H FRUIT FARMS INC

Mailing

Name

H WAMPLER FRUIT FARMS INC

Mailing Address

1001 SHILOH SPRINGS RD

City, State, Zip

DAYTON, OH 45415 2727

Legal

Legal Description

6-2-7

Land Use Description

C - COMMERCIAL VACANT LAND

Acres

10.271

Deed

01806P00053

Tax District Name

HARRISON TWP-DAYTON CSD

Values

Assessed Values

100%

35%

Land

\$53,920

\$18,870

Improvements

\$0

\$0

CAUV

\$0

\$0

Total

\$53,920

\$18,870

Current Year Special Assessments

41100-MCD/AP MCD/AQUIFER PRES SUBD

\$1.00

Current Year Rollback Summary

10% Rollback

\$0.00

2.5% Rollback

\$0.00

Homestead

\$0.00

City of Dayton Credit

\$0.00

Reduction Factor

-\$200.00

Tax Summary

Year	Prior Year	Prior Year Payments	1st Half Due 2/17/2012	1st Half Payments	2nd Half Due 7/13/2012	2nd Half Payments	Total Currently Due
2011	\$0.00	\$0.00	\$1,082.08	-\$1,082.08	\$1,189.19	\$0.00	\$1,189.19

Print

LOT F2

Close

PARID: E20 24320 0008
PARCEL LOCATION: OLD BARN RD

NBHD CODE: C3003HAR

Owner

Name

WAMPLER H FRUIT FARMS INC

Mailing

Name

WAMPLER H FRUIT FARMS INC

Mailing Address

1001 SHILOH SPRINGS RD

City, State, Zip

DAYTON, OH 45415 2727

Legal

Legal Description

19 WAMPLER FRUIT FARM SO
 SEC 2 REPLAT

Land Use Description

C - COMMERCIAL VACANT LAND

Acres

.377

Deed

01806P00053

Tax District Name

HARRISON TWP-DAYTON CSD

Values

Assessed Values	100%	35%
Land	\$2,900	\$1,020
Improvements	\$0	\$0
CAUV	\$0	\$0
Total	\$2,900	\$1,020

Current Year Special Assessments

41100-MCD/AP MCD/AQUIFER PRES SUBD \$1.00

Current Year Rollback Summary

10% Rollback	\$0.00
2.5% Rollback	\$0.00
Homestead	\$0.00
City of Dayton Credit	\$0.00
Reduction Factor	-\$10.82

Tax Summary

Year	Prior Year	Prior Year Payments	1st Half Due 2/17/2012	1st Half Payments	2nd Half Due 7/13/2012	2nd Half Payments	Total Currently Due
2011	\$0.00	\$0.00	\$59.44	-\$59.44	\$64.28	\$0.00	\$64.28

Print

LOT F3

Close

PARID: E20 24320 0009
PARCEL LOCATION: OLD BARN RD

NBHD CODE: C3003HAR

Owner

Name

H WAMPLER FRUIT FARMS INC

Mailing

Name WAMPLER H FRUIT FARMS INC

Mailing Address 1001 SHILOH SPRINGS RD

City, State, Zip DAYTON, OH 45415 2727

Legal

Legal Description 21 WAMPLER FRUIT FARMS
SOUTH SEC 2 REPLAT

Land Use Description C - COMMERCIAL VACANT LAND

Acres .83

Deed 01806P00053

Tax District Name HARRISON TWP-DAYTON CSD

Values

Assessed Values	100%	35%
Land	\$6,370	\$2,230
Improvements	\$0	\$0
CAUV	\$0	\$0
Total	\$6,370	\$2,230

Current Year Special Assessments

41100-MCD/AP MCD/AQUIFER PRES SUBD \$1.00

Current Year Rollback Summary

10% Rollback	\$0.00
2.5% Rollback	\$0.00
Homestead	\$0.00
City of Dayton Credit	\$0.00
Reduction Factor	-\$23.64

Tax Summary

Year	Prior Year	Prior Year Payments	1st Half Due 2/17/2012	1st Half Payments	2nd Half Due 7/13/2012	2nd Half Payments	Total Currently Due
2011	\$0.00	\$0.00	\$128.76	-\$128.76	\$140.54	\$0.00	\$140.54

Print

LOT F4

Close

PARID: E20 24320 0011
PARCEL LOCATION: OLD BARN RD

NBHD CODE: C3003HAR

Owner

Name

H WAMPLER FRUIT FARMS INC

Mailing

Name

WAMPLER H FRUIT FARMS INC

Mailing Address

1001 SHILOH SPRINGS RD

City, State, Zip

DAYTON, OH 45415 2727

Legal

Legal Description

23 WAMPLER FRUIT FARMS
 SOUTH SEC 2 REPLAT

Land Use Description

C - COMMERCIAL VACANT LAND

Acres

1.101

Deed

01806P00053

Tax District Name

HARRISON TWP-DAYTON CSD

Values

Assessed Values	100%	35%
Land	\$8,460	\$2,960
Improvements	\$0	\$0
CAUV	\$0	\$0
Total	\$8,460	\$2,960

Current Year Special Assessments

41100-MCD/AP MCD/AQUIFER PRES SUBD \$1.00

Current Year Rollback Summary

10% Rollback	\$0.00
2.5% Rollback	\$0.00
Homestead	\$0.00
City of Dayton Credit	\$0.00
Reduction Factor	-\$31.38

Tax Summary

Year	Prior Year	Prior Year Payments	1st Half Due 2/17/2012	1st Half Payments	2nd Half Due 7/13/2012	2nd Half Payments	Total Currently Due
2011	\$0.00	\$0.00	\$170.57	-\$170.57	\$186.53	\$0.00	\$186.53

Print

LOT F5

Close

PARID: H33 01505 0001**PARCEL LOCATION: CORTEZ DR****NBHD CODE: 54003000****Owner**

Name

H WAMPLER FRUIT FARM INC

Mailing

Name

H WAMPLER FRUIT FARMS

Mailing Address

1001 SHILOH SPRINGS RD

City, State, Zip

DAYTON, OH 45415

Legal

Legal Description

1 GRANDE TIERRA SUBD
SEC 1

Land Use Description

R - RESIDENTIAL, VACANT LAND, LOT

Acres

.396

Deed

1979-00014B008

Tax District Name

TROTWOOD CITY-TROTWOOD MADISON CSD

Board of Revision

Tax Year

Case Number:

2007

0663

2008

4863

Values

Assessed Values

100%

35%

Land

\$20,800

\$7,280

Improvements

\$0

\$0

CAUV

\$0

\$0

Total

\$20,800

\$7,280

Current Year Special Assessments

41100-MCD/AP MCD/AQUIFER PRES SUBD

\$1.00

Current Year Rollback Summary

10% Rollback	-\$67.10
2.5% Rollback	\$0.00
Homestead	\$0.00
City of Dayton Credit	\$0.00
Reduction Factor	-\$93.40

Tax Summary

Year	Prior Year	Prior Year Payments	1st Half Due 2/17/2012	1st Half Payments	2nd Half Due 7/13/2012	2nd Half Payments	Total Currently Due
2011	\$0.00	\$0.00	\$302.88	-\$302.88	\$332.07	\$0.00	\$332.07

Print

LOT F6

Close

PARID: H33 01505 0002
PARCEL LOCATION: 3380 CORTEZ DR

NBHD CODE: 54003000

Owner

Name

H WAMPLER FRUIT FARM INC

Mailing

Name H WAMPLER FRUIT FARMS
Mailing Address 1001 SHILOH SPRINGS RD
City, State, Zip DAYTON, OH 45415

Legal

Legal Description 2 GRANDE TIERRA SUBD
SEC 1
Land Use Description R - RESIDENTIAL, VACANT LAND, LOT
Acres .396
Deed 1979-00014B008
Tax District Name TROTWOOD CITY-TROTWOOD MADISON CSD

Board of Revision

Tax Year	Case Number:
2007	0663
2008	4863

Values

Assessed Values	100%	35%
Land	\$20,800	\$7,280
Improvements	\$0	\$0
CAUV	\$0	\$0
Total	\$20,800	\$7,280

Current Year Special Assessments

41100-MCD/AP MCD/AQUIFER PRES SUBD \$1.00

Current Year Rollback Summary

10% Rollback	-\$67.10
2.5% Rollback	\$0.00
Homestead	\$0.00
City of Dayton Credit	\$0.00
Reduction Factor	-\$93.40

Tax Summary

Year	Prior Year	Prior Year Payments	1st Half Due 2/17/2012	1st Half Payments	2nd Half Due 7/13/2012	2nd Half Payments	Total Currently Due
2011	\$0.00	\$0.00	\$302.88	-\$302.88	\$332.07	\$0.00	\$332.07

Print

LOT F7

Close

PARID: H33 01505 0006
PARCEL LOCATION: CORTEZ DR

NBHD CODE: 54003000

Owner

Name

H WAMPLER FRUIT FARM INC

Mailing

Name

H WAMPLER FRUIT FARMS

Mailing Address

1001 SHILOH SPRINGS RD

City, State, Zip

DAYTON, OH 45415

Legal

Legal Description

PT 6 GRANDE TIERRA SUBD
 SEC 1

Land Use Description

R - RESIDENTIAL, VACANT LAND, LOT

Acres

.3271

Deed

1979-00014B008

Tax District Name

TROTWOOD CITY-TROTWOOD MADISON CSD

Board of Revision

Tax Year

Case Number:

2007

0663

2008

4863

Values

Assessed Values

100%

35%

Land

\$20,800

\$7,280

Improvements

\$0

\$0

CAUV

\$0

\$0

Total

\$20,800

\$7,280

Current Year Special Assessments

41100-MCD/AP MCD/AQUIFER PRES SUBD

\$1.00

Current Year Rollback Summary

10% Rollback - \$67.10
 2.5% Rollback \$0.00
 Homestead \$0.00
 City of Dayton Credit \$0.00
 Reduction Factor - \$93.40

Tax Summary

Year	Prior Year	Prior Year Payments	1st Half Due 2/17/2012	1st Half Payments	2nd Half Due 7/13/2012	2nd Half Payments	Total Currently Due
2011	\$0.00	\$0.00	\$302.88	-\$302.88	\$332.07	\$0.00	\$332.07

Print

LOT F8

Close

PARID: H33 01505 0007**PARCEL LOCATION: CORTEZ DR****NBHD CODE: 54003000****Owner**

Name

H WAMPLER FRUIT FARM INC

Mailing

Name

H WAMPLER FRUIT FARMS

Mailing Address

1001 SHILOH SPRINGS RD

City, State, Zip

DAYTON, OH 45415

Legal

Legal Description

7 PT GRANDE TIERRA SUB
SEC 1

Land Use Description

R - RESIDENTIAL, VACANT LAND, LOT

Acres

.2583

Deed

1979-00014B008

Tax District Name

TROTWOOD CITY-TROTWOOD MADISON CSD

Board of Revision

Tax Year

Case Number:

2007

0663

2008

4863

Values

Assessed Values

100%

35%

Land

\$20,800

\$7,280

Improvements

\$0

\$0

CAUV

\$0

\$0

Total

\$20,800

\$7,280

Current Year Special Assessments

41100-MCD/AP MCD/AQUIFER PRES SUBD

\$1.00

Current Year Rollback Summary

10% Rollback	-\$67.10
2.5% Rollback	\$0.00
Homestead	\$0.00
City of Dayton Credit	\$0.00
Reduction Factor	-\$93.40

Tax Summary

Year	Prior Year	Prior Year Payments	1st Half Due 2/17/2012	1st Half Payments	2nd Half Due 7/13/2012	2nd Half Payments	Total Currently Due
2011	\$0.00	\$0.00	\$302.88	-\$302.88	\$332.07	\$0.00	\$332.07

Print

LOT F9

Close

PARID: H33 01505 0026**PARCEL LOCATION: CORTEZ DR****NBHD CODE: 54003000****Owner**

Name

WAMPLER H FRUIT FARMS INC

Mailing

Name

WAMPLER H FRUIT FARMS INC

Mailing Address

1001 SHILOH SPRINGS RD

City, State, Zip

DAYTON, OH 45415 2727

Legal

Legal Description

25 GRANDE TIERRA SUBD
SEC 2

Land Use Description

R - RESIDENTIAL, VACANT LAND, LOT

Acres

.4029

Deed

1979-00014B008

Tax District Name

TROTWOOD CITY-TROTWOOD MADISON CSD

Board of Revision

Tax Year

Case Number:

2007

0663

2008

4863

Values

Assessed Values

100%

35%

Land

\$20,800

\$7,280

Improvements

\$0

\$0

CAUV

\$0

\$0

Total

\$20,800

\$7,280

Current Year Special Assessments

41100-MCD/AP MCD/AQUIFER PRES SUBD

\$1.00

Current Year Rollback Summary

10% Rollback	-\$67.10
2.5% Rollback	\$0.00
Homestead	\$0.00
City of Dayton Credit	\$0.00
Reduction Factor	-\$93.40

Tax Summary

Year	Prior Year	Prior Year Payments	1st Half Due 2/17/2012	1st Half Payments	2nd Half Due 7/13/2012	2nd Half Payments	Total Currently Due
2011	\$0.00	\$0.00	\$302.88	-\$302.88	\$332.07	\$0.00	\$332.07

Print

LOT F10

Close

PARID: H33 01505 0027**PARCEL LOCATION: CORTEZ DR****NBHD CODE: 54003000****Owner**

Name

WAMPLER H FRUIT FARMS INC

Mailing

Name

WAMPLER H FRUIT FARMS INC

Mailing Address

1001 SHILOH SPRINGS RD

City, State, Zip

DAYTON, OH 45415 2727

Legal

Legal Description

26 GRANDE TIERRA SUBD
SEC 2

Land Use Description

R - RESIDENTIAL, VACANT LAND, LOT

Acres

.2944

Deed

1979-00014B008

Tax District Name

TROTWOOD CITY-TROTWOOD MADISON CSD

Board of Revision

Tax Year

Case Number:

2007

0663

2008

4863

Values

Assessed Values

100%

35%

Land

\$20,800

\$7,280

Improvements

\$0

\$0

CAUV

\$0

\$0

Total

\$20,800

\$7,280

Current Year Special Assessments

41100-MCD/AP MCD/AQUIFER PRES SUBD

\$1.00

Current Year Rollback Summary

10% Rollback	-\$67.10
2.5% Rollback	\$0.00
Homestead	\$0.00
City of Dayton Credit	\$0.00
Reduction Factor	-\$93.40

Tax Summary

Year	Prior Year	Prior Year Payments	1st Half Due 2/17/2012	1st Half Payments	2nd Half Due 7/13/2012	2nd Half Payments	Total Currently Due
2011	\$0.00	\$0.00	\$302.88	-\$302.88	\$332.07	\$0.00	\$332.07

Print

LOT F11

Close

PARID: H33 01505 0028
PARCEL LOCATION: CORTEZ DR

NBHD CODE: 54003000**Owner**

Name

WAMPLER H FRUIT FARMS INC

Mailing

Name

WAMPLER H FRUIT FARMS INC

Mailing Address

1001 SHILOH SPRINGS RD

City, State, Zip

DAYTON, OH 45415 2727

Legal

Legal Description

27 GRANDE TIERRA SUBD
SEC 2

Land Use Description

R - RESIDENTIAL, VACANT LAND, LOT

Acres

.2944

Deed

1979-00014B008

Tax District Name

TROTWOOD CITY-TROTWOOD MADISON CSD

Board of Revision

Tax Year

Case Number:

2007

0663

2008

4863

Values

Assessed Values

100%

35%

Land

\$20,800

\$7,280

Improvements

\$0

\$0

CAUV

\$0

\$0

Total

\$20,800

\$7,280

Current Year Special Assessments

31500-WEED MOWING / CLEAN UP

\$409.50

41100-MCD/AP MCD/AQUIFER PRES SUBD

\$1.00

Current Year Rollback Summary

10% Rollback

-\$67.10

2.5% Rollback

\$0.00

Homestead

\$0.00

City of Dayton Credit

\$0.00

Reduction Factor

-\$93.40

Tax Summary

Year	Prior Year	Prior Year Payments	1st Half Due 2/17/2012	1st Half Payments	2nd Half Due 7/13/2012	2nd Half Payments	Total Currently Due
2011	\$0.00	\$0.00	\$712.38	-\$712.38	\$332.07	\$0.00	\$332.07

Print

LOT F12

Close

PARID: H33 01505 0029
PARCEL LOCATION: CORTEZ DR

NBHD CODE: 54003000**Owner**

Name

WAMPLER H FRUIT FARMS INC

Mailing

Name

WAMPLER H FRUIT FARMS INC

Mailing Address

1001 SHILOH SPRINGS RD

City, State, Zip

DAYTON, OH 45415 2727

Legal

Legal Description

28 GRANDE TIERRA SUBD
SEC 2

Land Use Description

R - RESIDENTIAL, VACANT LAND, LOT

Acres

.2835

Deed

01806P00053

Tax District Name

TROTWOOD CITY-TROTWOOD MADISON CSD

Board of Revision

Tax Year

Case Number:

2007

0663

2008

4863

Values

Assessed Values

100%

35%

Land

\$20,800

\$7,280

Improvements

\$0

\$0

CAUV

\$0

\$0

Total

\$20,800

\$7,280

Current Year Special Assessments

41100-MCD/AP MCD/AQUIFER PRES SUBD

\$1.00

Current Year Rollback Summary

10% Rollback	-\$67.10
2.5% Rollback	\$0.00
Homestead	\$0.00
City of Dayton Credit	\$0.00
Reduction Factor	-\$93.40

Tax Summary

Year	Prior Year	Prior Year Payments	1st Half Due 2/17/2012	1st Half Payments	2nd Half Due 7/13/2012	2nd Half Payments	Total Currently Due
2011	\$0.00	\$0.00	\$302.88	-\$302.88	\$332.07	\$0.00	\$332.07

Print

LOT F13

Close

PARID: H33 01505 0031**PARCEL LOCATION: CORTEZ DR****NBHD CODE: 54003000****Owner**

Name

WAMPLER H FRUIT FARMS INC

Mailing

Name

WAMPLER H FRUIT FARMS INC

Mailing Address

1001 SHILOH SPRINGS RD

City, State, Zip

DAYTON, OH 45415 2727

Legal

Legal Description

30 GRANDE TIERRA SUBD
SEC 2

Land Use Description

R - RESIDENTIAL, VACANT LAND, LOT

Acres

.2835

Deed

1979-00014B008

Tax District Name

TROTWOOD CITY-TROTWOOD MADISON CSD

Board of Revision

Tax Year

Case Number:

2007

0663

2008

4863

Values

Assessed Values

100%

35%

Land

\$20,800

\$7,280

Improvements

\$0

\$0

CAUV

\$0

\$0

Total

\$20,800

\$7,280

Current Year Special Assessments

41100-MCD/AP MCD/AQUIFER PRES SUBD

\$1.00

Current Year Rollback Summary

10% Rollback	-\$67.10
2.5% Rollback	\$0.00
Homestead	\$0.00
City of Dayton Credit	\$0.00
Reduction Factor	-\$93.40

Tax Summary

Year	Prior Year	Prior Year Payments	1st Half Due 2/17/2012	1st Half Payments	2nd Half Due 7/13/2012	2nd Half Payments	Total Currently Due
2011	\$0.00	\$0.00	\$302.88	-\$302.88	\$332.07	\$0.00	\$332.07

LOT F14

Print

Close

PARID: H33 01505 0034
PARCEL LOCATION: CORTEZ DR

NBHD CODE: 54003000

Owner

Name

H WAMPLER FRUIT FARM INC

Mailing

Name

H WAMPLER FRUIT FARM INC

Mailing Address

1001 SHILOH SPRINGS RD

City, State, Zip

DAYTON, OH 45415 2727

Legal

Legal Description

PT GRANDE TIERRA SUBD
 SEC 1

Land Use Description

R - RESIDENTIAL, VACANT LAND, LOT

Acres

.0689

Deed

1993-00027E012

Tax District Name

TROTWOOD CITY-TROTWOOD MADISON CSD

Board of Revision

Tax Year

Case Number:

2007

0663

2008

4863

Values

Assessed Values

100%

35%

Land

\$5,200

\$1,820

Improvements

\$0

\$0

CAUV

\$0

\$0

Total

\$5,200

\$1,820

Current Year Special Assessments

41100-MCD/AP MCD/AQUIFER PRES SUBD

\$1.00

Current Year Rollback Summary

10% Rollback - \$16.78
 2.5% Rollback \$0.00
 Homestead \$0.00
 City of Dayton Credit \$0.00
 Reduction Factor - \$23.34

Tax Summary

Year	Prior Year	Prior Year Payments	1st Half Due 2/17/2012	1st Half Payments	2nd Half Due 7/13/2012	2nd Half Payments	Total Currently Due
2011	\$0.00	\$0.00	\$76.47	-\$76.47	\$83.02	\$0.00	\$83.02

Print

Close

PARID: H33 02101 0108
PARCEL LOCATION: BASORE RD

NBHD CODE: C3003000

Owner

Name
 H WAMPLER FRUIT FARM INC

Mailing

Name H WAMPLER FRUIT FARM INC
 Mailing Address 1001 SHILOH SPRINGS RD
 City, State, Zip DAYTON, OH 45415 2727

Legal

Legal Description 5-4-1
 Land Use Description C - GOLF COURSES
 Acres 5.03
 Deed 1979-00014B008
 Tax District Name TROTWOOD CITY-TROTWOOD MADISON CSD

Values

Assessed Values	100%	35%
Land	\$20,050	\$7,020
Improvements	\$0	\$0
CAUV	\$0	\$0
Total	\$20,050	\$7,020

Current Year Special Assessments

41100-MCD/AP MCD/AQUIFER PRES SUBD \$1.00

Current Year Rollback Summary

10% Rollback	\$0.00
2.5% Rollback	\$0.00
Homestead	\$0.00
City of Dayton Credit	\$0.00
Reduction Factor	-\$44.44

Tax Summary

Year	Prior Year	Prior Year Payments	1st Half Due 2/17/2012	1st Half Payments	2nd Half Due 7/13/2012	2nd Half Payments	Total Currently Due
2011	\$0.00	\$0.00	\$347.26	-\$347.26	\$380.89	\$0.00	\$380.89

Print

Close

PARID: H33 02101 0109
PARCEL LOCATION: BASORE RD

NBHD CODE: 55000000

Owner

Name

H WAMPLER FRUIT FARMS

Mailing

Name H WAMPLER FRUIT FARMS
Mailing Address 1001 SHILOH SPRINGS RD
City, State, Zip DAYTON, OH 45415 2727

Legal

Legal Description 5-4-1
Land Use Description R - RESIDENTIAL, 0-9.999 AC
Acres 0
Deed 1974-00078A012
Tax District Name TROTWOOD CITY-TROTWOOD MADISON CSD

Values

Assessed Values	100%	35%
Land	\$100	\$40
Improvements	\$0	\$0
CAUV	\$0	\$0
Total	\$100	\$40

Current Year Special Assessments

41100-MCD/AP MCD/AQUIFER PRES SUBD \$1.00

Current Year Rollback Summary

10% Rollback	-\$0.38
2.5% Rollback	\$0.00
Homestead	\$0.00
City of Dayton Credit	\$0.00
Reduction Factor	-\$0.52

Tax Summary

Year	Prior Year	Prior Year Payments	1st Half Due 2/17/2012	1st Half Payments	2nd Half Due 7/13/2012	2nd Half Payments	Total Currently Due
2011	\$0.00	\$0.00	\$2.65	-\$2.65	\$1.82	\$0.00	\$1.82

Print

LOT F17

Close

PARID: H33 02112 0178

PARCEL LOCATION: SHILOH SPRINGS RD

NBHD CODE: 5401000

Owner

Name

H WAMPLER FRUIT FARM INC

Mailing

Name

H WAMPLER FRUIT FARMS, INC

Mailing Address

1001 SHILOH SPRINGS RD

City, State, Zip

DAYTON, OH 45415 2727

Legal

Legal Description

5-4-12

Land Use Description

R - RESIDENTIAL, 10-19.999 AC

Acres

18.037

Deed

1993-00419B007

Tax District Name

TROTWOOD CITY-TROTWOOD MADISON CSD

Board of Revision

Tax Year

2008

Case Number:

4867

Values

Assessed Values

100%

35%

Land

\$78,150

\$27,350

Improvements

\$0

\$0

CAUV

\$0

\$0

Total

\$78,150

\$27,350

Current Year Special Assessments

41100-MCD/AP MCD/AQUIFER PRES SUBD

\$1.00

Current Year Rollback Summary

10% Rollback -\$252.04

2.5% Rollback \$0.00

Homestead \$0.00

City of Dayton Credit \$0.00

Reduction Factor -\$350.90

Tax Summary

Year	Prior Year	Prior Year Payments	1st Half Due 2/17/2012	1st Half Payments	2nd Half Due 7/13/2012	2nd Half Payments	Total Currently Due
2011	\$0.00	\$0.00	\$1,135.14	-\$1,135.14	\$1,247.55	\$0.00	\$1,247.55

Print

LOT F18

Close

PARID: H33 02112 0009
PARCEL LOCATION: WOLF RD

NBHD CODE: 54010000

Owner

Name

WAMPLER H FRUIT FARMS INC

Mailing

Name

H WAMPLER FRUIT FARMS INC

Mailing Address

1001 SHILOH SPRINGS RD

City, State, Zip

DAYTON, OH 45415 2727

Legal

Legal Description

5-4-12

21-12-42

Land Use Description

A - AGRICULTURAL VACANT LAND

Acres

63.724

Deed

01806P00053

Tax District Name

TROTWOOD CITY-TROTWOOD MADISON CSD

Board of Revision

Tax Year

2008

Case Number:

4867

Values

Assessed Values

100%

35%

Land

\$193,740

\$67,810

Improvements

\$0

\$0

CAUV

\$71,980

\$25,190

Total

\$71,980

\$25,190

Current Year Special Assessments

41100-MCD/AP MCD/AQUIFER PRES SUBD

\$1.00

Current Year Rollback Summary

10% Rollback -\$232.14

2.5% Rollback \$0.00

Homestead \$0.00

City of Dayton Credit \$0.00

Reduction Factor -\$323.18

Tax Summary

Year	Prior Year	Prior Year Payments	1st Half Due 2/17/2012	1st Half Payments	2nd Half Due 7/13/2012	2nd Half Payments	Total Currently Due
2011	\$0.00	\$0.00	\$1,045.57	-\$1,045.57	\$1,149.03	\$0.00	\$1,149.03

Lot F19

Print

Close

PARID: M60 03207 0023
PARCEL LOCATION: WESTBROOK RD

NBHD CODE: 5600000**Owner**

Name

WAMPLER H FRUIT FARMS INC

Mailing

Name

H WAMPLER FRUIT FARMS INC

Mailing Address

1001 SHILOH SPRINGS RD

City, State, Zip

DAYTON, OH 45415 2127

Legal

Legal Description

5-5-33

Land Use Description

A - CASH GRAIN OR GENERAL FARM

Acres

37.098

Deed

1971-00396B002

Tax District Name

CLAYTON CITY-NORTHMONT CSD

Board of Revision

Tax Year

2008

Case Number:

4866

Values

Assessed Values	100%	35%
Land	\$125,190	\$43,820
Improvements	\$0	\$0
CAUV	\$31,360	\$10,980
Total	\$31,360	\$10,980

Current Year Special Assessments

41100-MCD/AP MCD/AQUIFER PRES SUBD

\$1.00

Current Year Rollback Summary

10% Rollback	-\$93.82
2.5% Rollback	\$0.00
Homestead	\$0.00
City of Dayton Credit	\$0.00
Reduction Factor	-\$324.52

Tax Summary

Year	Prior Year	Prior Year Payments	1st Half Due 2/17/2012	1st Half Payments	2nd Half Due 7/13/2012	2nd Half Payments	Total Currently Due
2011	\$0.00	\$0.00	\$423.20	-\$423.20	\$464.42	\$0.00	\$464.42

Print

Close

PARID: E20 01006 0033
PARCEL LOCATION: SHILOH SPRINGS RD

NBHD CODE: C3003000

Owner

Name

H WAMPLER FRUIT FARMS INC

Mailing

Name H WAMPLER FRUIT FARMS INC

Mailing Address 1001 SHILOH SPRINGS RD

City, State, Zip DAYTON, OH 45415 2727

Legal

Legal Description 6-2-6

Land Use Description C - GOLF COURSES

Acres 38.61

Deed 1986-00759D005

Tax District Name HARRISON TWP-DAYTON CSD

Values

Assessed Values	100%	35%
Land	\$160,620	\$56,220
Improvements	\$66,710	\$23,350
CAUV	\$0	\$0
Total	\$227,330	\$79,570

Current Year Special Assessments

11777-APC FEE	\$613.02
41100-MCD/AP MCD/AQUIFER PRES SUBD	\$2.82

Current Year Rollback Summary

10% Rollback	\$0.00
2.5% Rollback	\$0.00
Homestead	\$0.00
City of Dayton Credit	\$0.00
Reduction Factor	-\$843.36

Tax Summary

Year	Prior Year	Prior Year Payments	1st Half Due 2/17/2012	1st Half Payments	2nd Half Due 7/13/2012	2nd Half Payments	Total Currently Due
2011	\$51,274.88	-\$5,514.43	\$5,308.95	\$0.00	\$5,837.28	\$0.00	\$56,906.68

Print

Close

PARID: E20 01006 0034
PARCEL LOCATION: SHILOH SPRINGS RD

NBHD CODE: C3003000

Owner

Name
H WAPLER FRUIT FARMS INC

Mailing

Name H WAPLER FRUIT FARMS INC
Mailing Address 1001 SHILOH SPRINGS RD
City, State, Zip DAYTON, OH 45415 2727

Legal

Legal Description 6-2-6
Land Use Description C - GOLF COURSES
Acres 3
Deed 1992-00590B003
Tax District Name HARRISON TWP-DAYTON CSD

Values

Assessed Values	100%	35%
Land	\$12,480	\$4,370
Improvements	\$0	\$0
CAUV	\$0	\$0
Total	\$12,480	\$4,370

Current Year Special Assessments

41100-MCD/AP MCD/AQUIFER PRES SUBD \$1.00

Current Year Rollback Summary

10% Rollback	\$0.00
2.5% Rollback	\$0.00
Homestead	\$0.00
City of Dayton Credit	\$0.00
Reduction Factor	-\$46.32

Tax Summary

Year	Prior Year	Prior Year Payments	1st Half Due 2/17/2012	1st Half Payments	2nd Half Due 7/13/2012	2nd Half Payments	Total Currently Due
2011	\$0.00	\$0.00	\$251.37	-\$251.37	\$275.41	\$0.00	\$275.41

Print

Close

PARID: E20 01006 0057
PARCEL LOCATION: SHILOH SPRINGS RD

NBHD CODE: C3003000

Owner

Name
 H WAMPLER FRUIT FARMS INC

Mailing

Name HAROLD WAMPLER FR FARMS IN
 Mailing Address 1001 SHILOH SPRINGS RD
 City, State, Zip DAYTON, OH 45415 2727

Legal

Legal Description 6-2-6
 Land Use Description C - GOLF COURSES
 Acres 1.1
 Deed 1971-00396B002
 Tax District Name HARRISON TWP-DAYTON CSD

Values

Assessed Values	100%	35%
Land	\$4,580	\$1,600
Improvements	\$0	\$0
CAUV	\$0	\$0
Total	\$4,580	\$1,600

Current Year Special Assessments

41100-MCD/AP MCD/AQUIFER PRES SUBD \$1.00

Current Year Rollback Summary

10% Rollback	\$0.00
2.5% Rollback	\$0.00
Homestead	\$0.00
City of Dayton Credit	\$0.00
Reduction Factor	-\$16.96

Tax Summary

Year	Prior Year	Prior Year Payments	1st Half Due 2/17/2012	1st Half Payments	2nd Half Due 7/13/2012	2nd Half Payments	Total Currently Due
2011	\$0.00	\$0.00	\$92.67	-\$92.67	\$100.84	\$0.00	\$100.84

Print

LOT F23

Close

NOTE: Only a portion of this parcel subject to sale

PARID: H33 02101 0008
PARCEL LOCATION: 1001 SHILOH SPRINGS RD

NBHD CODE: C3003000

Owner

Name

WAMPLER H FRUIT FARMS INC

Mailing

Name

H WAMPLER FRUIT FARMS INC

Mailing Address

1001 SHILOH SPRINGS RD

City, State, Zip

DAYTON, OH 45415 2727

Legal

Legal Description

5-4-1

Land Use Description

C - GOLF COURSES

Acres

55.423

Deed

01806P00053

Tax District Name

TROTWOOD CITY-TROTWOOD MADISON CSD

Values

Assessed Values	100%	35%
Land	\$230,560	\$80,700
Improvements	\$74,690	\$26,140
CAUV	\$0	\$0
Total	\$305,250	\$106,840

Current Year Special Assessments

31103-STM WA DELQ STORM WATER	\$0.00
41100-MCD/AP MCD/AQUIFER PRES SUBD	\$3.78

Current Year Rollback Summary

10% Rollback	\$0.00
2.5% Rollback	\$0.00
Homestead	\$0.00
City of Dayton Credit	\$0.00
Reduction Factor	-\$676.36

Tax Summary

Year	Prior Year	Prior Year Payments	1st Half Due 2/17/2012	1st Half Payments	2nd Half Due 7/13/2012	2nd Half Payments	Total Currently Due
2011	\$103,812.46	-\$19,225.77	\$11,068.96	\$0.00	\$6,903.74	\$0.00	\$102,559.39

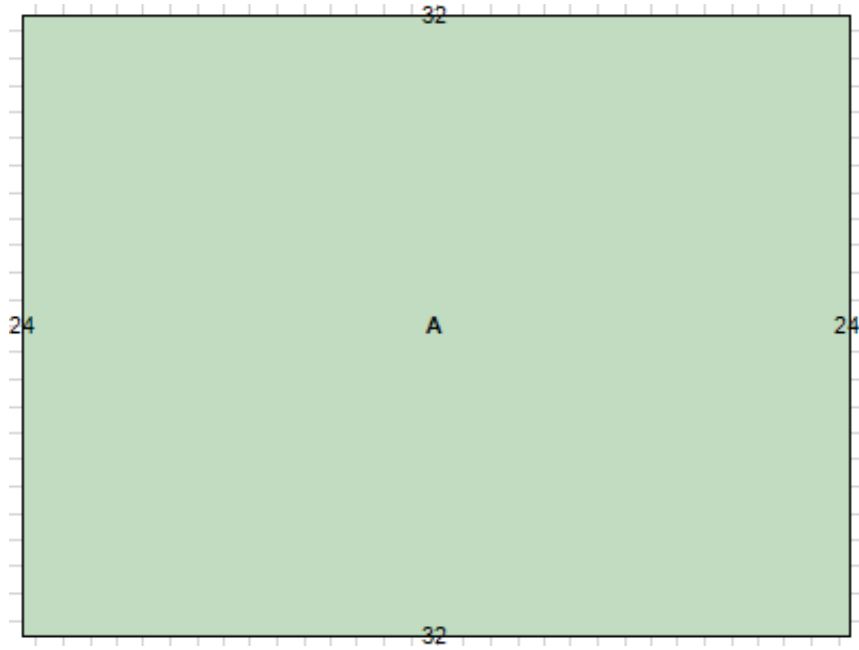

A MULTI USE SALES, 768 Sq. Ft.

Print

Close

PARID: H33 02101 0111
PARCEL LOCATION: BASORE RD

NBHD CODE: C3003000

Owner

Name

H WAMPLER FRUIT FARM INC

Mailing

Name

H WAMPLER FRUIT FARM INC

Mailing Address

1001 SHILOH SPRINGS RD

City, State, Zip

DAYTON, OH 45415 2727

Legal

Legal Description

5-4-1

Land Use Description

C - GOLF COURSES

Acres

.022

Deed

1979-00014B008

Tax District Name

TROTWOOD CITY-TROTWOOD MADISON CSD

Values

Assessed Values	100%	35%
Land	\$160	\$60
Improvements	\$0	\$0
CAUV	\$0	\$0
Total	\$160	\$60

Current Year Special Assessments

41100-MCD/AP MCD/AQUIFER PRES SUBD \$1.00

Current Year Rollback Summary

10% Rollback	\$0.00
2.5% Rollback	\$0.00
Homestead	\$0.00
City of Dayton Credit	\$0.00
Reduction Factor	-\$0.38

Tax Summary

Year	Prior Year	Prior Year Payments	1st Half Due 2/17/2012	1st Half Payments	2nd Half Due 7/13/2012	2nd Half Payments	Total Currently Due
2011	\$0.00	\$0.00	\$3.97	-\$3.97	\$3.27	\$0.00	\$3.27

Print

LOT H1

Close

PARID: E20 01007 0018

PARCEL LOCATION: TURNER RD

NBHD CODE: C3003HAR

Owner

Name

WAMPLER HAROLD JR AND EDNA M WAMPLER TR

Mailing

Name

WAMPLER HAROLD JR AND
EDNA M WAMPLER TR

Mailing Address

1001 SHILOH SPRINGS RD

City, State, Zip

DAYTON, OH 45405

Legal

Legal Description

6-2-7

Land Use Description

C - COMMERCIAL VACANT LAND

Acres

3.723

Deed

2000-00090A001

Tax District Name

HARRISON TWP-DAYTON CSD

Sales

Date	Sale Price	Deed Reference	Seller	Buyer
19-MAR-86	\$200,000			
13-JAN-89	\$200,000			
14-FEB-00			WAMPLER RALPH M AND	WAMPLER HAROLD JR AND

Values

Assessed Values	100%	35%
Land	\$28,590	\$10,010
Improvements	\$0	\$0
CAUV	\$0	\$0
Total	\$28,590	\$10,010

Current Year Special Assessments

41100-MCD/AP MCD/AQUIFER PRES SUBD \$1.00

Current Year Rollback Summary

10% Rollback	\$0.00
2.5% Rollback	\$0.00
Homestead	\$0.00
City of Dayton Credit	\$0.00
Reduction Factor	-\$106.08

Tax Summary

Year	Prior Year	Prior Year Payments	1st Half Due 2/17/2012	1st Half Payments	2nd Half Due 7/13/2012	2nd Half Payments	Total Currently Due
2011	\$0.00	\$0.00	\$574.49	-\$574.49	\$630.84	\$0.00	\$630.84



Sorry, no sketch available
for this record

Print

LOT H2

Close

PARID: M60 00301 0001
PARCEL LOCATION: DIAMOND MILL RD

NBHD CODE: 56030000

Owner

Name

WAMPLER HAROLD EDNA M WAMPLER TR

Mailing

Name

WAMPLER HAROLD
EDNA M WAMPLER TR

Mailing Address

1001 SHILOH SPRING RD

City, State, Zip

DAYTON, OH 45405

Legal

Legal Description

5-5-19

Land Use Description

A - CASH GRAIN OR GENERAL FARM

Acres

49.83

Deed

2000-00090A004

Tax District Name

CLAYTON CITY-NORTHMONT CSD

Sales

Date

Sale Price

Deed Reference

Seller

Buyer

14-FEB-00

WAMPLER JR HAROLD +

WAMPLER RALPH AND

Board of Revision

Tax Year

Case Number:

2008

4869

Values

Assessed Values

100%

35%

Land

\$194,760

\$68,170

Improvements

\$0

\$0

CAUV

\$55,600

\$19,460

Total

\$55,600

\$19,460

Current Year Special Assessments

31200-LT. LIGHTING

\$29.87

41100-MCD/AP MCD/AQUIFER PRES SUBD

\$1.00

Current Year Rollback Summary

10% Rollback

-\$166.28

2.5% Rollback

\$0.00

Homestead

\$0.00

City of Dayton Credit

\$0.00

Reduction Factor

-\$575.12

Tax Summary

Year	Prior Year	Prior Year	1st Half	1st Half	2nd Half	2nd Half	Total
		Payments	Due 2/17/2012	Payments	Due 7/13/2012	Payments	Currently Due
2011	\$0.00	\$0.00	\$779.11	-\$779.11	\$748.24	-\$748.24	\$0.00



Sorry, no sketch available
for this record

Print

LOT H3

Close

PARID: M60 03101 0002

PARCEL LOCATION: 5972 NATIONAL RD W

NBHD CODE: 56000000

Owner

Name

WAMPLER HAROLD AND EDNA M WAMPLER TR

Mailing

Name

WAMPLER HAROLD AND

EDNA M WAMPLER TR

Mailing Address

1001 SHILOH SPRING RD

City, State, Zip

DAYTON, OH 45405

Legal

Legal Description

5-5-19

Land Use Description

A - CASH GRAIN OR GENERAL FARM

Acres

23.9

Deed

01624P00032

Tax District Name

CLAYTON/NORTHMONT CSD

Sales

Date

Sale Price

Deed Reference

Seller

Buyer

14-FEB-00

WAMPLER HAROLD JR

WAMPLER RALPH AND

Board of Revision

Tax Year

Case Number:

2008

4869

Values

***** TENTATIVE VALUES *****

Assessed Values

100%

35%

Land

\$113,120

\$39,590

Improvements

\$47,930

\$16,780

CAUV

\$52,210

\$18,270

Total

\$100,140

\$35,050

***** TENTATIVE VALUES *****

Residential Dwelling

Building Style

OLD STYLE TWO STORY

Exterior Wall Material

BRICK

Number of Stories

2

Year Built

1919

Total Rms/Bedrms/Baths/Half Baths

7/3/2/0

Total Square Feet of Living Area

2112

Basement

PART

Finished Basemt Living Area (Sq. Ft.)

0

Rec Room (Sq. Ft.)

0

Central Heat/Air Cond

CENTRAL HEAT

Heating System Type

HOT AIR

Heating Fuel Type

GAS

Number of Fireplaces(Masonry)

1

Number of Fireplaces(Prefab)

Current Year Special Assessments

31850-TR COL TRASH COLLECTION

\$211.01

Current Year Rollback Summary

10% Rollback	\$0.00
2.5% Rollback	\$0.00
Homestead	\$0.00
City of Dayton Credit	\$0.00
Reduction Factor	\$0.00

Tax Summary

Year	Prior Year	Prior Year Payments	1st Half Due 2/17/2012	1st Half Payments	2nd Half Due 7/13/2012	2nd Half Payments	Total Currently Due
2012	\$0.00	\$0.00	\$0.00	\$0.00	\$0.00	\$0.00	\$0.00

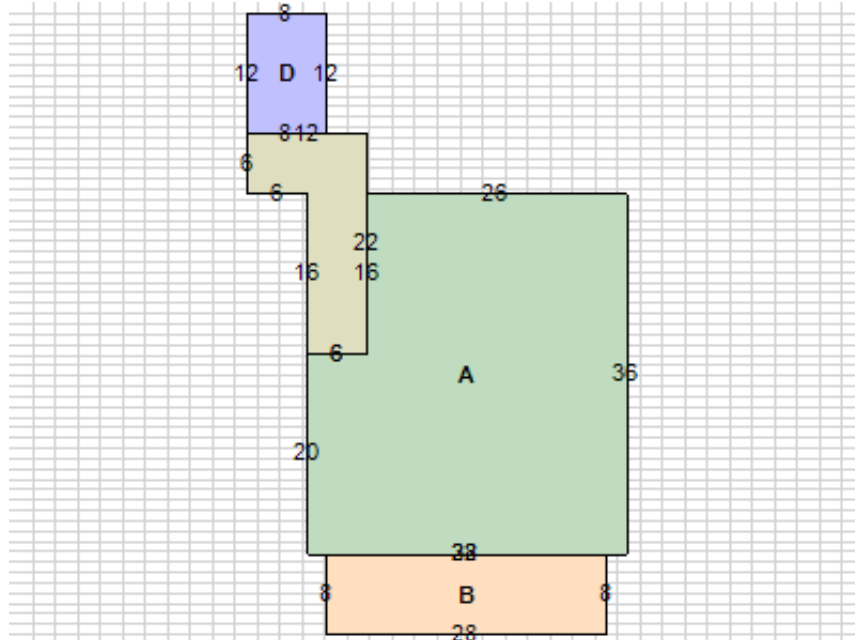

Print

LOT H4

Close

PARID: M60 03101 0003
PARCEL LOCATION: ST RT 40

NBHD CODE: 56000000

Owner

Name

WAMPLER HAROLD AND EDNA M WAMPLER TR

Mailing

Name

WAMPLER RALPH AND
EDNA M WAMPLER TR

Mailing Address

1001 SHILOH SPRING RD

City, State, Zip

DAYTON, OH 45405

Legal

Legal Description

5-5-19

31-1-4

Land Use Description

A - CASH GRAIN OR GENERAL FARM

Acres

30.67

Deed

01624P00032

Tax District Name

CLAYTON CITY-NORTHMONT CSD

Sales

Date

Sale Price

Deed Reference

Seller

Buyer

14-FEB-00

WAMPLER JR HAROLD +

WAMPLER RALPH AND

Board of Revision

Tax Year

Case Number:

2008

4869

Values

Assessed Values

100%

35%

Land

\$122,680

\$42,940

Improvements

\$0

\$0

CAUV

\$42,680

\$14,940

Total

\$42,680

\$14,940

Current Year Special Assessments

41100-MCD/AP MCD/AQUIFER PRES SUBD

\$1.00

Current Year Rollback Summary

10% Rollback

-\$127.66

2.5% Rollback

\$0.00

Homestead

\$0.00

City of Dayton Credit

\$0.00

Reduction Factor

-\$441.56

Tax Summary

Year	Prior Year	Prior Year	1st Half	1st Half	2nd Half	2nd Half	Total
------	------------	------------	----------	----------	----------	----------	-------

Montgomery County

		Payments	Due 2/17/2012	Payments	Due 7/13/2012	Payments	Currently Due
2011	\$0.00	\$0.00	\$575.46	-\$575.46	\$574.46	-\$574.46	\$0.00



Sorry, no sketch available
for this record

Print

Close

PARID: H33 02101 0049
PARCEL LOCATION: 1001 SHILOH SPRINGS RD

NBHD CODE: C3003000

Owner

Name

WAMPLER HAROLD JR AND EDNA M WAMPLER TR

Mailing

Name

WAMPLER HAROLD JR AND EDNA M WAMPLER TR

Mailing Address

1001 SHILOH SPRINGS RD

City, State, Zip

DAYTON, OH 45405

Legal

Legal Description

5-4-1

Land Use Description

21-1-55
C - OTHER COMMERCIAL STRUCTURES

Acres

25.19

Deed

2000-00089E008

Tax District Name

TROTWOOD CITY-TROTWOOD MADISON CSD

Sales

Date

Sale Price

Deed Reference

Seller

Buyer

14-FEB-00

WAMPLER HAROLD JR

RALPH WAMPLER AND

Board of Revision

Tax Year

Case Number:

2008

4864

Values

Assessed Values

100%

35%

Land

\$515,890

\$180,560

Improvements

\$898,340

\$314,420

CAUV

\$0

\$0

Total

\$1,414,230

\$494,980

Current Year Special Assessments

31103-STM WA DELQ STORM WATER

\$9,909.90

41100-MCD/AP MCD/AQUIFER PRES SUBD

\$15.95

11777-APC FEE

\$902.78

Current Year Rollback Summary

10% Rollback

\$0.00

2.5% Rollback

\$0.00

Homestead

\$0.00

City of Dayton Credit

\$0.00

Reduction Factor

-\$3,133.52

Tax Summary

Year	Prior Year	Prior Year Payments	1st Half Due 2/17/2012	1st Half Payments	2nd Half Due 7/13/2012	2nd Half Payments	Total Currently Due
2011	\$438,546.85	-\$94,565.87	\$38,241.68	\$0.00	\$24,844.65	-\$24,844.65	\$382,222.66

Unapplied Payments: \$21,478.96

For a true payoff amount, please contact the Treasurer's office at (937) 225-4010 Option 2.

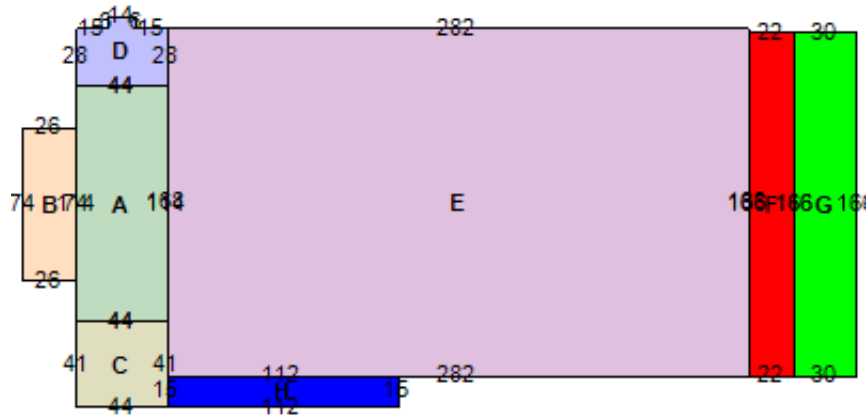

A MULTI USE SALES, 5016 Sq. Ft.	B CANOPY ROOF/SLAB, 0 Sq. Ft.
C MULTI-USE OFFICE, 1804 Sq. Ft.	D TAVERN/BAR, 1316 Sq. Ft.
E AUDITORIUM/THEATER, 47376 Sq. Ft.	F ULTI USE STORAGE, 3652 Sq. Ft.
G ULTI USE STORAGE, 4980 Sq. Ft.	H ULTI USE STORAGE, 1680 Sq. Ft.