



Property Report

Generated on 09/04/13 at 08:23:18 PM

Parcel ID **186-00027-00** Map Routing No **186-0044C -045-01** Card No **1** Location **00000 GROVEPORT RD**

Owner
NORTHPOINTE BANK
333 DEPOSIT DR NE
GRAND RAPIDS MI 49546
 If the above is incorrect please call 614-525-4663

Tax Bill Mailing Info
CAPITAL REAL ESTATE TAX SERVICE
316 1/2 S MAIN ST STE 201
ROYAL OAK, MI 48067

Legal Description
BIXBY ROAD
R21 T11 S19
2.537 ACRES

Most Recent Transfer	
Sale Amount	\$42,000
Date of Sale	09/18/2012
Conveyance Type	SH
Conveyance Number	15694
Number of Parcels	1

Tax Year 2012			
Annual Taxes	\$1,336.36	Taxes Paid	\$4,440.18

Current Value		
	Market	Taxable
Land	\$49,700	\$17,400
Improvements	\$0	\$0
Total	\$49,700	\$17,400
Cauv	\$0	\$0

Building Data
 Card 1 has no building entries

2012 Tax Status			
Property Class	COMMERCIAL		
Land Use	[400] VACANT COMMERCIAL LAND		
Tax District	[186] MADISON TWP-OBETZ CORP.		
School District	[2507] GROVEPORT MADISON LSD		
Neighborhood	07301		
Board of Revision	NO	CDQ	
Homestead	NO	2.5% Reduction	NO

Characteristics			
Neighborhood	07301	Property Status	VACANT
Type	SUBURBAN	Elevation	STREET LEVEL
Trend	STABLE	Terrain	FLAT
Traffic	NOMINAL	Street Access	PAVED



Property Report (Continued)

Generated on 09/04/13 at 08:23:18 PM

Parcel ID **186-000027-00** Map Routing No **186-0044C -045-01** Card No **1** Location **00000 GROVEPORT RD**

Attributes			
Electricity		Alley	
Water		Sidewalk	
Sewer		Corner Lot	
Gas		Land Locked	
Well		Wooded Lot	
Septic		Waterfront	
Irregular Shape		View Enhancement	
Excess Frontage		Easements	

Area		
Code	Area Type	Size
A4	UNDEVELOPED	2.260 Acres
A0	RIGHT OF WAY	0.280 Acres
Total		2.540 Acres

Building
No records found for this card

Permits
No records found for this card

Features
No records found for this card

Improvements
No records found for this card



Property Report (Continued)

Generated on 09/04/13 at 08:23:18 PM

Parcel ID **186-00027-00** Map Routing No **186-0044C -045-01** Card No **1** Location **0000 GROVEPORT RD**

Transfers						
Date	Owner	Conveyance No	Exempt Conveyance No	Conveyance Type	Number Parcels	Sale Price
09/18/2012	NORTHPOINTE BANK	201200015694		SH	1	\$42,000
03/06/1989	BALL RONALD D & ROSEMARY		1989901572-		1	\$0
03/06/1989			1989901570-		1	\$0

Current Year Rates For This Parcel					
Rate	103.820000	Reduction Factor	0.260238	Effective Rate	76.802045

Current Tax Year Detail						
	Prior		1st Half		2nd Half	
	Chg	Adj	Chg	Adj	Chg	Adj
Orig Tax	\$2,641.58	\$0.00	\$903.23	\$0.00	\$903.23	\$0.00
Reduction	\$0.00	\$0.00	\$235.05	\$0.00	\$235.05	\$0.00
Subtotal	\$2,641.58	\$0.00	\$668.18	\$0.00	\$668.18	\$0.00
10% RB	\$0.00	\$0.00	\$0.00	\$0.00	\$0.00	\$0.00
2.5% RB	\$0.00	\$0.00	\$0.00	\$0.00	\$0.00	\$0.00
Homestead CR	\$0.00	\$0.00	\$0.00	\$0.00	\$0.00	\$0.00
Net	\$2,641.58		\$668.18		\$668.18	
Penalty/Int	\$462.24					
RE Chg			\$668.18		\$668.18	
RE Paid	\$3,103.82		\$668.18		\$668.18	
SA Chg						
SA Paid						
Total Owed	\$3,103.82		\$668.18		\$668.18	
Total Paid	\$3,103.82		\$668.18		\$668.18	
Balance Due						
Future Charge	\$0.00		\$0.00		\$0.00	
Future Paid	\$0.00		\$0.00		\$0.00	

Detail of Special Assessment	
No Records Found	

Tax Payment Information						
Date	Half	Proj	Prior	1st Half	2nd Half	Surplus
06/17/2013	2-12		\$0.00	\$0.00	\$486.76	\$0.00
12/10/2012	1-12		\$0.00	\$0.00	\$0.00	\$849.60
12/10/2012	1-12		\$0.00	\$0.00	\$0.00	\$-849.60
12/10/2012	1-12		\$0.00	\$668.18	\$181.42	\$0.00
09/25/2012	1-12		\$3,103.82	\$0.00	\$0.00	\$0.00
11/08/2010	1-10		\$707.00	\$0.00	\$0.00	\$0.00

Assessment Payoff	
No data is available	



Property Report (Continued)

Generated on 09/04/13 at 08:23:18 PM

Parcel ID **186-000027-00** Map Routing No **186-0044C -045-01** Card No **1** Location **00000 GROVEPORT RD**

Distribution for Tax Year 2012		
County		
General Fund		\$25.58
Children's Services		\$86.36
Alcohol, Drug & Mental Health Services		\$38.28
MRDD		\$121.80
Metro Parks		\$13.05
Columbus Zoo		\$12.80
Senior Options		\$22.62
School District	[2507] GROVEPORT MADISON LSD	\$696.64
Township	MADISON	\$206.13
Vocational School	EASTLAND FAIRFIELD CAREER CENTER	\$34.80
City / Village	OBETZ	\$29.58
Library / Other	COLUMBUS METROPOLITAN	\$48.72
Total		\$1,336.36
The above distribution was updated on 5/10/2013		



Property Report (Continued)

Generated on 09/04/13 at 08:23:18 PM

Parcel ID **186-000027-00** Map Routing No **186-0044C -045-01** Card No **1** Location **00000 GROVEPORT RD**

Levy Distribution				
Description	Initial Year	Expires	Effective Rate	Taxes
COLUMBUS METROPOLITAN				
CURRENT EXPENSE	2010	PERMANENT	2.80000	51.59
Total				51.59
EASTLAND FAIRFIELD CAREER CENTER				
CURRENT EXPENSE	1976	PERMANENT	1.20000	22.11
CURRENT EXPENSE	1998	PERMANENT	0.80000	14.74
Total				36.85
FRANKLIN COUNTY				
ZOOLOGICAL	2005	2015	0.70915	13.07
OFFICE ON AGING	2007	2012	0.88244	16.26
METRO PARK	2009	2019	0.75000	13.82
MENTAL HEALTH & RETARDATION	2008	PERMANENT	3.43169	63.23
MENTAL HEALTH & RETARDATION	2002	2012	3.15385	58.11
GENERAL FUND	INSIDE	PERMANENT	1.47000	27.09
CHILDREN SERVICIES	2009	2019	3.10000	57.12
CHILDREN SERVICES	2004	2014	1.79651	33.10
ADAMH BOARD	2006	2016	2.15706	39.74
Total				321.53
GROVEPORT MADISON LSD				
PERMANENT IMPROVEMENT	INSIDE	PERMANENT	1.47000	27.09
GENERAL FUND	INSIDE	PERMANENT	2.73000	50.30
EMERGENCY (\$7,707,115)	2009	2012	9.31000	171.54
CURRENT EXPENSE	1976	PERMANENT	0.60142	11.08
CURRENT EXPENSE	1976	PERMANENT	1.04246	19.21
CURRENT EXPENSE	1976	PERMANENT	1.20284	22.16
CURRENT EXPENSE	1976	PERMANENT	1.48350	27.33
CURRENT EXPENSE	1976	PERMANENT	2.20521	40.63
CURRENT EXPENSE	1985	PERMANENT	3.09658	57.06
CURRENT EXPENSE	1988	PERMANENT	5.71790	105.35
CURRENT EXPENSE	1991	PERMANENT	8.96630	165.21
Total				696.96
MADISON				
POLICE	1976	PERMANENT	0.43372	7.99
POLICE	1976	PERMANENT	0.30027	5.53
POLICE	1980	PERMANENT	1.08933	20.07
POLICE	1986	PERMANENT	0.46355	8.54
GENERAL FUND	INSIDE	PERMANENT	0.60000	11.06
FIRE	1976	PERMANENT	0.43372	7.99
FIRE	1976	PERMANENT	0.13345	2.46
FIRE	1982	PERMANENT	1.25910	23.20
FIRE	1988	PERMANENT	1.41685	26.11
FIRE	1992	PERMANENT	1.52342	28.07
FIRE	2002	PERMANENT	3.09808	57.08
Total				198.10
OBETZ				
GENERAL FUND	INSIDE	PERMANENT	1.70000	31.32
Total				31.32
Total Distribution \$1,336.36				

Property Report (Continued)

Generated on 09/04/13 at 08:23:18 PM

Parcel ID 186-000027-00	Map Routing No 186-0044C -045-01	Card No 1	Location 00000 GROVEPORT RD
-----------------------------------	--	---------------------	---------------------------------------

Photo



186-000027-00 04/27/2010

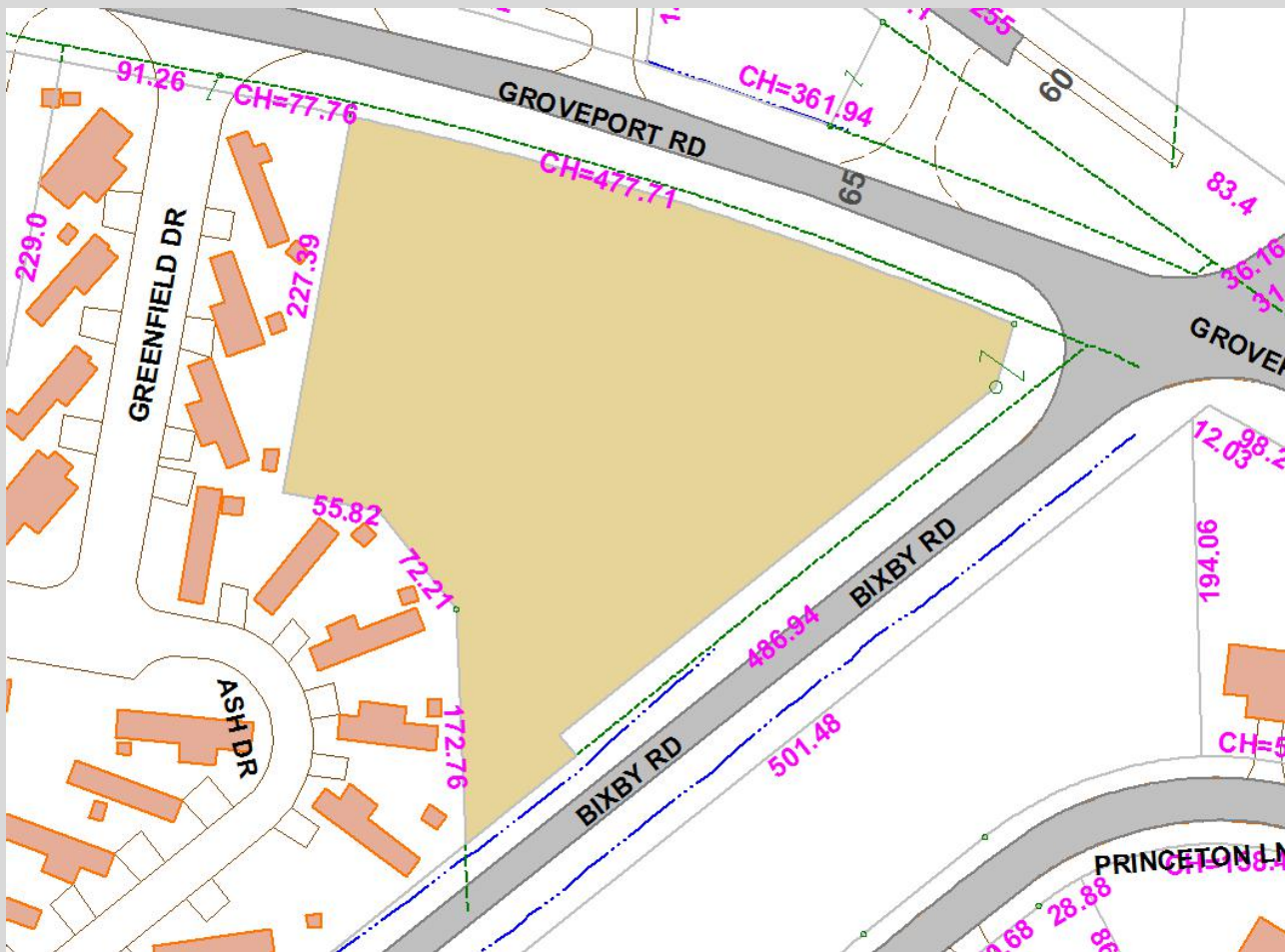

Disclaimer

This drawing is prepared for the real property inventory within this county. It is compiled from recorded deeds, survey plats, and other public records and data. Users of this drawing are notified that the public primary information source should be consulted for verification of the information contained on this drawing. The county and the mapping companies assume no legal responsibilities for the information contained on this drawing. Please notify the Franklin County GIS Division of any discrepancies.

Sketch

No sketch exists for this card

The information on this web site is prepared for the real property inventory within this county. Users of this data are notified that the public primary information source should be consulted for verification of the information contained on this site. The county and vendors assume no legal responsibilities for the information contained on this site. Please notify the Franklin County Auditor's Real Estate Division of any discrepancies.

