

PROFILE

Parcel: 304716.047. **Land Use Code:** 510
Alternate ID: **LUC Description:** RESIDENTIAL
Address: 5681 NEWTONSVILLE HUTCHINSON RD **District:** 30
Owner: STEWARD BARBARA ZETTEL **NBHD:** 04240R30
Tax District: STONELICK TWP-CLE
Mailing: PO BOX 186 **Land Acres:** 0.975
NESTRN LSD
NEWTONSVILLE OH 45158
Description: WESLER
LOT 47

VALUE SUMMARY

Appraised Land:	31100	Assessed Land:	10890
Appraised Building:	132800	Assessed Building:	46480
Total:	163900	Assessed Total:	57370

PRIMARY RESIDENTIAL CARD

Card: 1	Basement: FULL	Fireplace Pref.:
Stories: 1	Square Feet: 1436	Basement Gar.: 0
Construction: BRICK	HT/AC: CENTRAL A/C	Fireplace OP/ST: 1
Style: RANCH (Post 1940)	Fuel: ELECTRIC	Grade: B-
Year Built: 1973	Attic: NONE	Cond (CDU): AV
Year Remod.:	Fin Basement:	% Complete:
Total Rooms: 6	Rec Room:	Family Room: 0
Bedrooms: 3	Half Bath: 1	
Full Bath: 1		

COMMERCIAL CARD

Year Built: **Gross Flr. Area:**
Eff. Yr. Built:
Units:

SALES HISTORY

Date	Book-Page	Seller	Buyer	Amount
31-MAR-2022	2915--4947	STEWARD WILLIAM J	STEWARD BARBARA ZETTEL	

MAP



PHOTO



304716.047. 02/15/2019

SKETCH

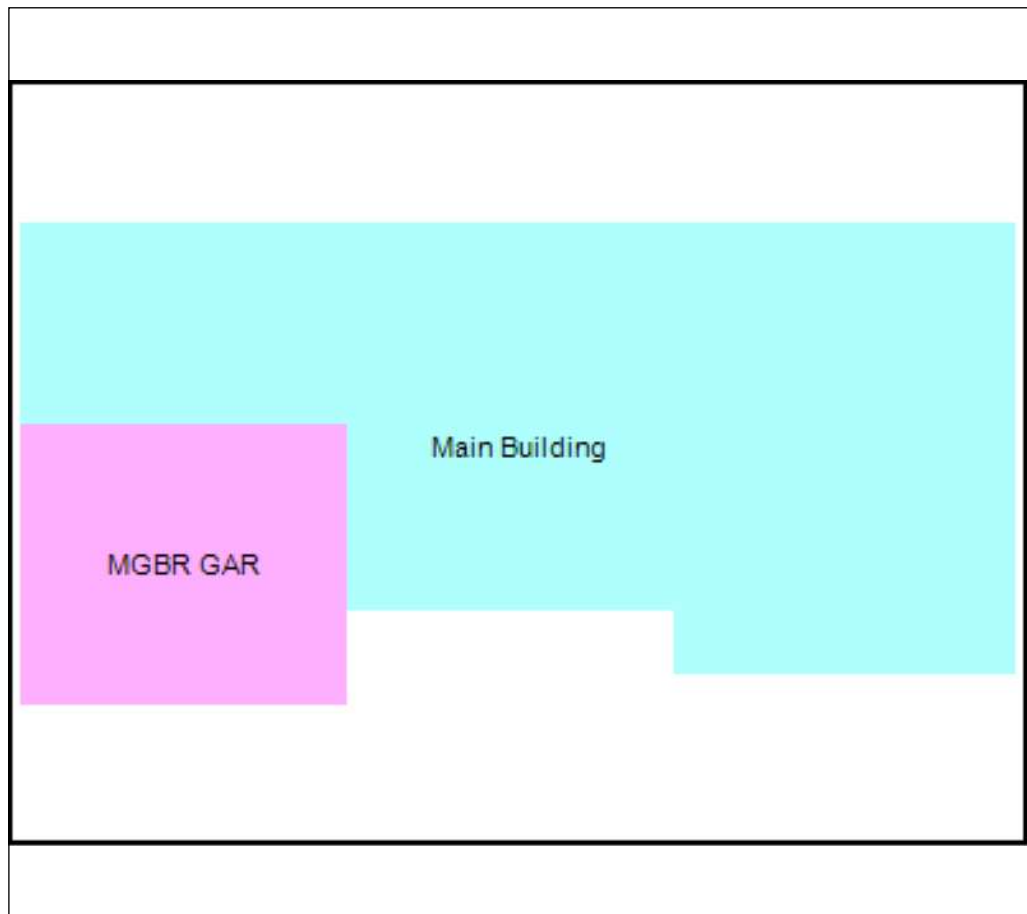

Sketch Legend

0 Main Building 1436 Sq. Ft.
1 MGBR GAR - 23:MG/BG
MASONRY/BRICK GARAGE 378 Sq.
Ft.

PROFILE

Parcel:	304716.046.	Land Use Code:	500
Alternate ID:		LUC Description:	RESIDENTIAL
Address:	NEWTONSVILLE HUTCHINSON RD	District:	30
Owner	STEWARD BARBARA ZETTEL	NBHD:	04240R30
		Tax District:	STONELICK TWP-CLE NESTRN LSD
Mailing	PO BOX 186	Land Acres:	0.975
	NEWTONSVILLE OH 45158		
Description:	WESLER		
	LOT 46		

VALUE SUMMARY

Appraised Land:	7800	Assessed Land:	2730
Appraised Building:	0	Assessed Building:	0
Total:	7800	Assessed Total:	2730

PRIMARY RESIDENTIAL CARD

Card:	Basement:	Fireplace Pref.:
Stories:	Square Feet:	Basement Gar.:
Construction:	HT/AC:	Fireplace OP/ST:
Style:	Fuel:	Grade:
Year Built:	Attic:	Cond (CDU):
Year Remod.:	Fin Basement:	% Complete:
Total Rooms:	Rec Room:	Family Room:
Bedrooms:	Half Bath:	
Full Bath:		

COMMERCIAL CARD

Year Built:	Gross Flr. Area:
Eff. Yr. Built:	
Units:	

SALES HISTORY

Date	Book-Page	Seller	Buyer	Amount
31-MAR-2022	2915--4947	STEWARD WILLIAM J	STEWARD BARBARA ZETTEL	

MAP



PHOTO



SKETCH

Sketch Legend

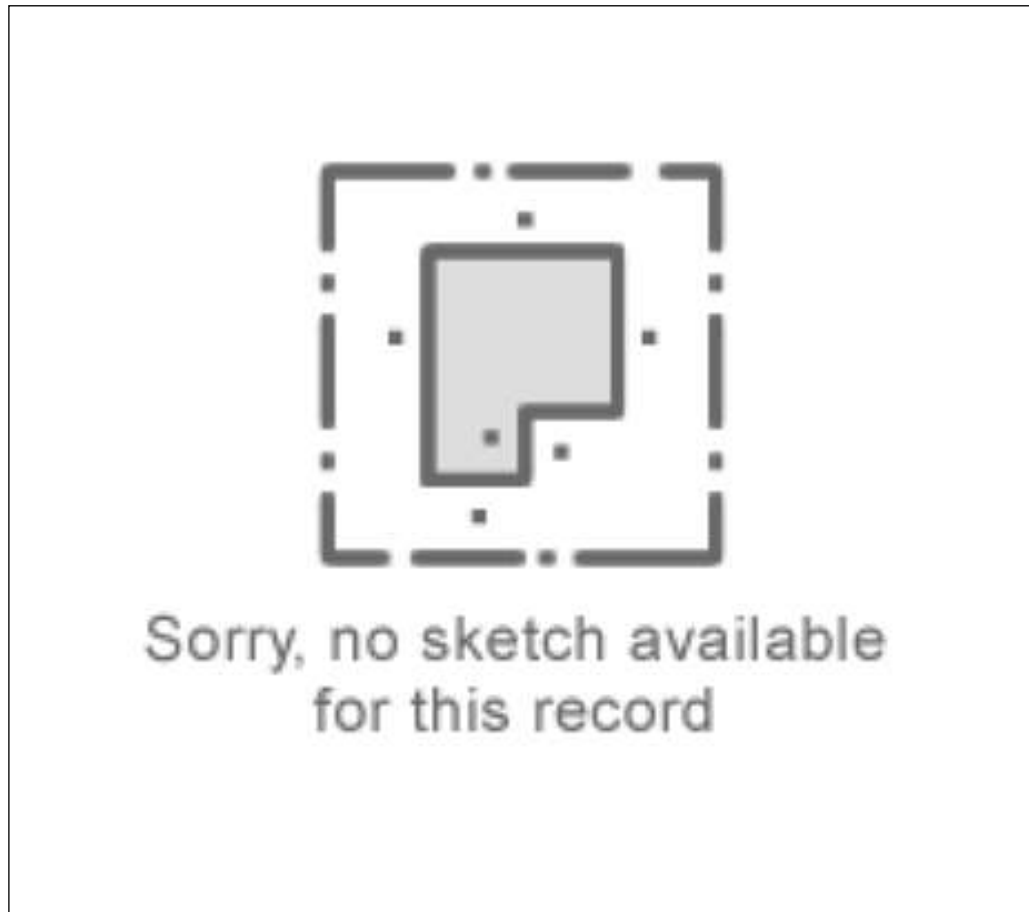

PROFILE

Parcel: 302905C047. **Land Use Code:** 599
Alternate ID: **LUC Description:** RESIDENTIAL
Address: NEWTONSVILLE HUTCHINSON RD **District:** 30
Owner STEWARD BARBARA ZETTEL **NBHD:** 04240R30
Tax District: STONELICK TWP-CLE
NESTRN LSD
Mailing PO BOX 186 **Land Acres:** 5.07

NEWTONSVILLE OH 45158

Description:**VALUE SUMMARY**

Appraised Land:	78400	Assessed Land:	27440
Appraised Building:	9000	Assessed Building:	3150
Total:	87400	Assessed Total:	30590

PRIMARY RESIDENTIAL CARD

Card:	Basement:	Fireplace Pref.:
Stories:	Square Feet:	Basement Gar.:
Construction:	HT/AC:	Fireplace OP/ST:
Style:	Fuel:	Grade:
Year Built:	Attic:	Cond (CDU):
Year Remod.:	Fin Basement:	% Complete:
Total Rooms:	Rec Room:	Family Room:
Bedrooms:	Half Bath:	
Full Bath:		

COMMERCIAL CARD

Year Built:	Gross Flr. Area:
Eff. Yr. Built:	
Units:	

SALES HISTORY

Date	Book-Page	Seller	Buyer	Amount
31-MAR-2022	2915--4947	STEWARD WILLIAM J	STEWARD BARBARA ZETTEL	

MAP



PHOTO



302905C047. 02/15/2019

SKETCH

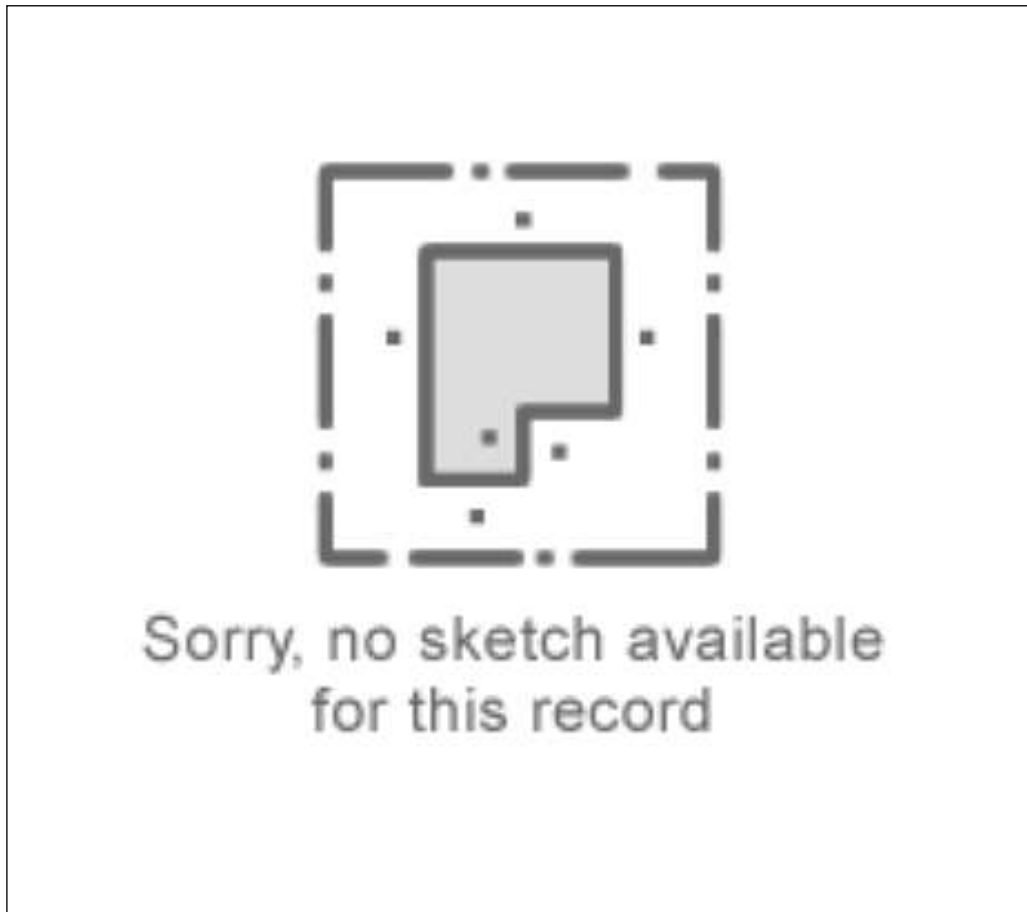

Sketch Legend

- 1 - 4 SIDES CLOSED, METAL POLE BLDG 1920 Sq. Ft.
- 2 - CARPORT 648 Sq. Ft.