

Richland County, OH

Summary 2026

Parcel Number 0270404513000
 Location Address HARKER ST
 MANSFIELD OH 44903
 Legal Description 5912 S 105 FT 33 X 105
 (Note: Not to be used on legal documents.)
 Property Class C - COMMERCIAL
 Land Use (456) C - PARKING GARAGE STRUCTURE & LOTS
 Neighborhood 02704C01
 Tax District 027
 Acres 0
 Sec/Twp/Rng --
 Township MANSFIELD
 School District MANSFIELD CITY SD
 Topo LEVEL
 Utilities ALL PUBLIC
 Roads PAVED, SIDEWALK
 Traffic LIGHT



027-04-045-13-000 03/31/2021

[View Map](#)

Owners

Owner
[CITADEL DEVELOPMENT LLC AN OHIO LIMITED](#)
 LIABILITY COMPANY
 Mailing Address
 CITADEL DEVELOPMENT LLC
 30 HARKER ST
 MANSFIELD OH 44903

Valuation

Assessed Year	2025	2024	2023	2022
Land Value	\$1,390.00	\$1,390.00	\$1,390.00	\$1,260.00
Building Value	\$830.00	\$830.00	\$830.00	\$830.00
Total Value (Assessed 35%)	\$2,220.00	\$2,220.00	\$2,220.00	\$2,090.00
Land Value	\$3,960.00	\$3,960.00	\$3,960.00	\$3,600.00
Building Value	\$2,380.00	\$2,380.00	\$2,380.00	\$2,380.00
CAUV Value	\$0.00	\$0.00	\$0.00	\$0.00
Total Value (Appraised 100%)	\$6,340.00	\$6,340.00	\$6,340.00	\$5,980.00

Taxes Due

Tax Year (click for detail)	1st Half Due	2nd Half Due	Delinquent	Total Due
2025	\$79.08	\$79.08	\$187.09	\$345.25
2024	\$0.00	\$0.00	\$0.00	\$0.00
2023	\$0.00	\$0.00	\$0.00	\$0.00
2022	\$0.00	\$0.00	\$0.00	\$0.00
2021	\$0.00	\$0.00	\$0.00	\$0.00
2020	\$0.00	\$0.00	\$0.00	\$0.00
2019	\$0.00	\$0.00	\$0.00	\$0.00

Land

Descr	P	LN	CD	Acres	Frontage	Depth	Base Size	Base Rate	Sq ft.	Incr / Decr	Land-Val
Regular Lot	F	1	1	0.0795	33	105	50.00	143	3,465	71.5 / 143	\$3,960

Total Acres:
0.0795
 Total Land-Value:
\$3,960

Other Buildings & Yard Improvements

Card 1	Descr	Full Description	Type	Quantity	Year	Size	Area	Grade	Mods	Cond	F	MD%	Value
ASPH PAVE	ASPHALT OR BLACKTOP PAVING	C11	1	1990	2,600	C-AVERAGE	A	A	0	\$2,380			

Sales

Date	Book	Page	Grantor	Grantee	Price	Instr Type	Sale Validity
9/28/2020			CASE CRAIG A	CITADEL DEVELOPMENT LLC AN OHIO LIMITED	\$175,000	WD	SALE INVOLVING MULTIPLE PARCELS
6/29/2004			CASE FRED A M	CASE CRAIG A	\$0	WD	RELATED INDIVIDUALS OR CORPORATIONS
5/27/2004			CASE LEWIS W	CASE FRED A M	\$0	CT	RELATED INDIVIDUALS OR CORPORATIONS

Photos



027-04-045-13-000 03/31/2021

The information displayed on this map is taken from public records, and is intended to be used as a reference. Map information is believed to be accurate, but accuracy is not guaranteed. Richland County makes no warranties, express or implied, concerning the accuracy, completeness, or reliability of this information, and assumes no liability or any other legal responsibility for the information contained on this map. The map does not represent the official survey of the land.

[User Privacy Policy](#) | [GDPR Privacy Notice](#)
[Last Data Upload: 1/28/2026, 10:39:16 AM](#)

Contact Us



Richland County, OH

Summary 2026

Parcel Number 0270404514000
 Location Address HARKER ST
 MANSFIELD OH 44903
 Legal Description 5913 S 105 FT 33 X 105
 (Note: Not to be used on legal documents.)
 Property Class C - COMMERCIAL
 Land Use (456) C - PARKING GARAGE STRUCTURE & LOTS
 Neighborhood 02704C01
 Tax District 027
 Acres 0
 Sec/Twp/Rng --
 Township MANSFIELD
 School District MANSFIELD CITY SD
 Topo LEVEL
 Utilities ALL PUBLIC
 Roads PAVED, SIDEWALK
 Traffic LIGHT



027-04-045-14-000 03/31/2021

[View Map](#)

Owners

Owner
[CITADEL DEVELOPMENT LLC AN OHIO](#)
 LIMITED LIABILITY COMPANY
 Mailing Address
 CITADEL DEVELOPMENT LLC
 30 HARKER ST
 MANSFIELD OH 44903

Valuation

Assessed Year	2025	2024	2023	2022
Land Value	\$1,390.00	\$1,390.00	\$1,390.00	\$1,260.00
Building Value	\$830.00	\$830.00	\$830.00	\$830.00
Total Value (Assessed 35%)	\$2,220.00	\$2,220.00	\$2,220.00	\$2,090.00
Land Value	\$3,960.00	\$3,960.00	\$3,960.00	\$3,600.00
Building Value	\$2,380.00	\$2,380.00	\$2,380.00	\$2,380.00
CAUV Value	\$0.00	\$0.00	\$0.00	\$0.00
Total Value (Appraised 100%)	\$6,340.00	\$6,340.00	\$6,340.00	\$5,980.00

Taxes Due

Tax Year (click for detail)	1st Half Due	2nd Half Due	Delinquent	Total Due
2025	\$79.08	\$79.08	\$187.09	\$345.25
2024	\$0.00	\$0.00	\$0.00	\$0.00
2023	\$0.00	\$0.00	\$0.00	\$0.00
2022	\$0.00	\$0.00	\$0.00	\$0.00
2021	\$0.00	\$0.00	\$0.00	\$0.00
2020	\$0.00	\$0.00	\$0.00	\$0.00
2019	\$0.00	\$0.00	\$0.00	\$0.00

Land

Descr	P	LN	CD	Acres	Frontage	Depth	Base Size	Base Rate	Sq ft.	Incr / Decr	Land-Val
Regular Lot	F	1	1	0.0795	33	105	50.00	143	3,465	71.5 / 143	\$3,960

Total Acres:
0.0795

Total Land-Value:
\$3,960

Other Buildings & Yard Improvements

Card 1

Descr	Full Description	Type	Quantity	Year	Size	Area	Grade	Mods	Cond	F	MD%	Value
ASPH PAVE	ASPHALT OR BLACKTOP PAVING	C11	1	1990		2,600	C-AVERAGE		A	A	0	\$2,380

Sales

Date	Book	Page	Grantor	Grantee	Price	Instr Type	Sale Validity
9/28/2020			CASE CRAIG A	CITADEL DEVELOPMENT LLC AN OHIO	\$175,000	WD	SALE INVOLVING MULTIPLE PARCELS
6/29/2004			CASE FRED A M	CASE CRAIG A	\$0	WD	RELATED INDIVIDUALS OR CORPORATIONS
5/27/2004			CASE LEWIS W	CASE FRED A M	\$0	CT	RELATED INDIVIDUALS OR CORPORATIONS

Photos



027-04-045-14-000 03/31/2021

The information displayed on this map is taken from public records, and is intended to be used as a reference. Map information is believed to be accurate, but accuracy is not guaranteed. Richland County makes no warranties, express or implied, concerning the accuracy, completeness, or reliability of this information, and assumes no liability or any other legal responsibility for the information contained on this map. The map does not represent the official survey of the land.

[User Privacy Policy](#) | [GDPR Privacy Notice](#)
[Last Data Upload: 1/28/2026, 10:39:16 AM](#)

[Contact Us](#)

Developed by
 **SCHNEIDER**
GEO SPATIAL

Richland County, OH

Summary 2026

Parcel Number 0270404515000
Location Address HARKER ST
 MANSFIELD OH 44903
Legal Description 5914 35 X 150
 (Note: Not to be used on legal documents.)
Property Class I - INDUSTRIAL
Land Use (300) I - INDUSTRIAL, VACANT LAND
Neighborhood 02704C01
Tax District 027
Acres 0
Sec/Twp/Rng --
Township MANSFIELD
School District MANSFIELD CITY SD
Topo LEVEL
Utilities ALL PUBLIC
Roads PAVED
Traffic MEDIUM

[View Map](#)

Owners

Owner
[CITADEL DEVELOPMENT LLC AN OHIO LIMITED](#)
 LIABILITY COMPANY
Mailing Address
 CITADEL DEVELOPMENT LLC
 30 HARKER ST
 MANSFIELD OH 44903

Valuation

Assessed Year	2025	2024	2023	2022
Land Value	\$1,750.00	\$1,750.00	\$1,750.00	\$1,590.00
Building Value	\$0.00	\$0.00	\$0.00	\$0.00
Total Value (Assessed 35%)	\$1,750.00	\$1,750.00	\$1,750.00	\$1,590.00
Land Value	\$5,010.00	\$5,010.00	\$5,010.00	\$4,550.00
Building Value	\$0.00	\$0.00	\$0.00	\$0.00
CAUV Value	\$0.00	\$0.00	\$0.00	\$0.00
Total Value (Appraised 100%)	\$5,010.00	\$5,010.00	\$5,010.00	\$4,550.00

Taxes Due

Tax Year (click for detail)	1st Half Due	2nd Half Due	Delinquent	Total Due
2025	\$62.34	\$62.34	\$147.50	\$272.18
2024	\$0.00	\$0.00	\$0.00	\$0.00
2023	\$0.00	\$0.00	\$0.00	\$0.00
2022	\$0.00	\$0.00	\$0.00	\$0.00
2021	\$0.00	\$0.00	\$0.00	\$0.00
2020	\$0.00	\$0.00	\$0.00	\$0.00
2019	\$0.00	\$0.00	\$0.00	\$0.00

Land

Descr	P	LN	CD	Acres	Frontage	Depth	Base Size	Base Rate	Sq ft.	Incr / Decr	Land-Val
Regular Lot	F	1	1	0.1205	35	150	50.00	143	5,250	71.5 / 143	\$5,010

Total Acres:
 0.1205
Total Land-Value:
 \$5,010

Sales

Date	Book	Page	Grantor	Grantee	Price	Instr Type	Sale Validity
9/28/2020			CASE CRAIG A	CITADEL DEVELOPMENT LLC AN OHIO LIMITED	\$175,000	WD	SALE INVOLVING MULTIPLE PARCELS
6/29/2004			CASE FRED A M	CASE CRAIG A	\$0	WD	RELATED INDIVIDUALS OR CORPORATIONS
5/27/2004			CASE LEWIS W	CASE FRED A M	\$0	CT	RELATED INDIVIDUALS OR CORPORATIONS

No data available for the following modules: Residential Improvement Information, Other Dwelling Features, Additions, Commercial Improvement Information, Interior/Exterior Information, Other Buildings & Yard Improvements, Other Features, Permits, Photos, Sketches.

The information displayed on this map is taken from public records, and is intended to be used as a reference. Map information is believed to be accurate, but accuracy is not guaranteed. Richland County makes no warranties, express or implied, concerning the accuracy, completeness, or reliability of this information, and assumes no liability or any other legal responsibility for the information contained on this map. The map does not represent the official survey of the land.
[User Privacy Policy](#) | [GDPR Privacy Notice](#)
 Last Data Upload: 1/28/2026, 10:39:16 AM

Contact Us



Richland County, OH

Summary 2026

Parcel Number 0270404516000
 Location Address HARKER ST
 MANSFIELD OH 44903
 Legal Description 5915 35 X 150
 (Note: Not to be used on legal documents.)
 Property Class I - INDUSTRIAL
 Land Use (340) I - LIGHT MANUFACTURING & ASSEMBLY
 Neighborhood 02704C01
 Tax District 027
 Acres 0
 Sec/Twp/Rng --
 Township MANSFIELD
 School District MANSFIELD CITY SD
 Topo LEVEL
 Utilities ALL PUBLIC
 Roads PAVED
 Traffic LIGHT

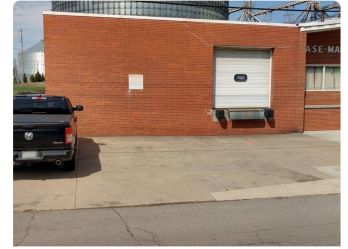

027-04-045-16-000 03/31/2021

[View Map](#)

Owners

Owner
[CITADEL DEVELOPMENT LLC AN OHIO LIMITED](#)
 LIABILITY COMPANY
 Mailing Address
 CITADEL DEVELOPMENT LLC
 30 HARKER ST
 MANSFIELD OH 44903

Valuation

Assessed Year	2025	2024	2023	2022
Land Value	\$1,750.00	\$1,750.00	\$1,750.00	\$1,590.00
Building Value	\$17,270.00	\$17,270.00	\$17,270.00	\$17,600.00
Total Value (Assessed 35%)	\$19,020.00	\$19,020.00	\$19,020.00	\$19,190.00
Land Value	\$5,010.00	\$5,010.00	\$5,010.00	\$4,550.00
Building Value	\$49,350.00	\$49,350.00	\$49,350.00	\$50,290.00
CAUV Value	\$0.00	\$0.00	\$0.00	\$0.00
Total Value (Appraised 100%)	\$54,360.00	\$54,360.00	\$54,360.00	\$54,840.00

Taxes Due

Tax Year (click for detail)	1st Half Due	2nd Half Due	Delinquent	Total Due
2025	\$677.57	\$677.57	\$1,602.93	\$2,958.07
2024	\$0.00	\$0.00	\$0.00	\$0.00
2023	\$0.00	\$0.00	\$0.00	\$0.00
2022	\$0.00	\$0.00	\$0.00	\$0.00
2021	\$0.00	\$0.00	\$0.00	\$0.00
2020	\$0.00	\$0.00	\$0.00	\$0.00
2019	\$0.00	\$0.00	\$0.00	\$0.00

Land

Descr	P	LN	CD	Acres	Frontage	Depth	Base Size	Base Rate	Sq ft.	Incr / Decr	Land-Val
Regular Lot	F	1	1	0.1205	35	150	50.00	143	5,250	71.5 / 143	\$5,010

Total Acres:
0.1205
 Total Land-Value:
\$5,010

Commercial Improvement Information

Card 1
 Building No 1
 Structure WAREHOUSE
 Year Built 1920
 Effective Year 0
 Grade D+

Card 2
 Building No 2
 Structure WAREHOUSE
 Year Built 1970
 Effective Year 0
 Grade C-

Interior/Exterior Information

Card 1

Line	Sect	From	To	Sec	Occupancy	Occ Descr	Class	Yr Built	Eff Year	Size	Area	Perim	Height	Use Type	Phy Cond	UT	Base RCN	Feat RCN	Base Value	Pct Good	Pct Comp	Adj Value
1	1	B1	B1		0			1920	0	1900	176	9	9	MLTI STORAGE	2	2	31,880	0	31,880	30	0	\$9,560
2	1	01	01		0			1920	0	1900	138	9	9	MLTI STORAGE	2	2	43,480	0	43,480	30	0	\$13,040

Card 2

Line	Sect	From	To	Sec	Occupancy	Occ Descr	Class	Yr Built	Eff Year	Size	Area	Perim	Height	Use Type	Phy Cond	UT	Base RCN	Feat RCN	Base Value	Pct Good	Pct Comp	Adj Value
1	1	01	01		0			1970	0	2812	224	14	14	WRHSE	2	2	80,560	9,374	89,180	30	0	\$26,750

Other Features

Card 2

Ln	Code	Descr	Meas 1	Meas 2	Stops	IU	Value
1	LD3	LOAD DOCK IN	12	30	0	1	\$9,374

Sales

Date	Book	Page	Grantor	Grantee	Price	Instr Type	Sale Validity
9/28/2020			CASE CRAIG A	CITADEL DEVELOPMENT LLC AN OHIO LIMITED	\$175,000	WD	SALE INVOLVING MULTIPLE PARCELS
6/29/2004			CASE FRED A M	CASE CRAIG A	\$0	WD	RELATED INDIVIDUALS OR CORPORATIONS
5/27/2004			CASE LEWIS W	CASE FRED A M	\$0	CT	RELATED INDIVIDUALS OR CORPORATIONS

Photos

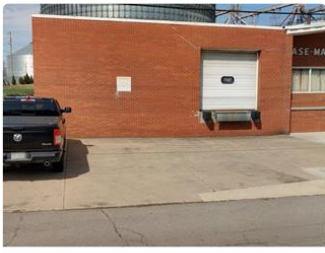

027-04-045-16-000 03/31/2021



027-04-045-16-000 05/16/2016



027-04-045-16-000 05/14/2013

Sketches

To magnify the Sketch, you may right click on the image to download or to open the image in a new tab. These options will then allow you to zoom in.

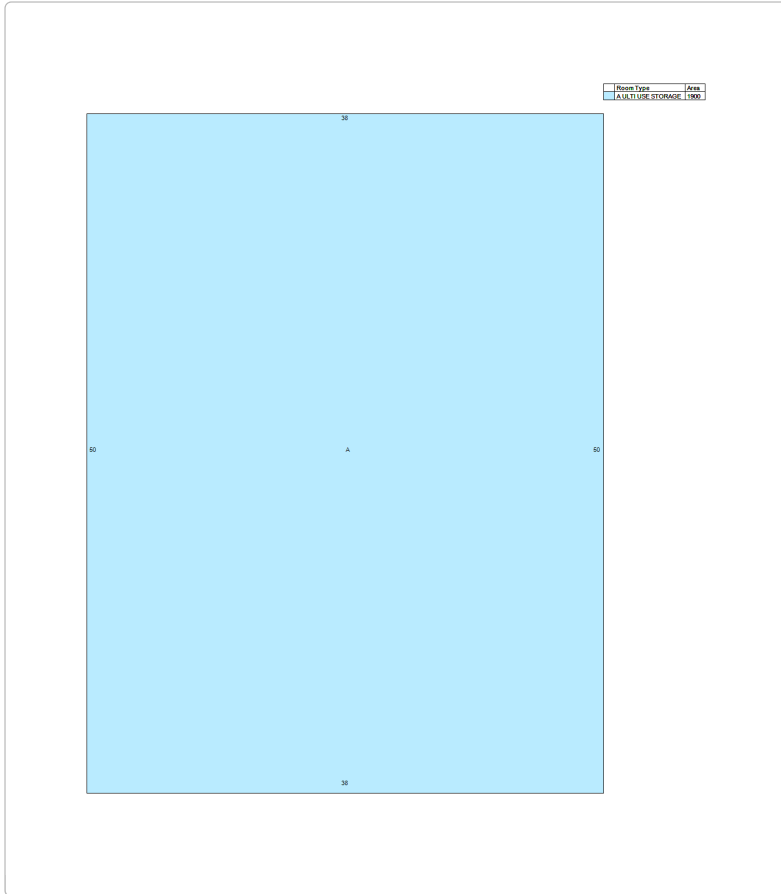

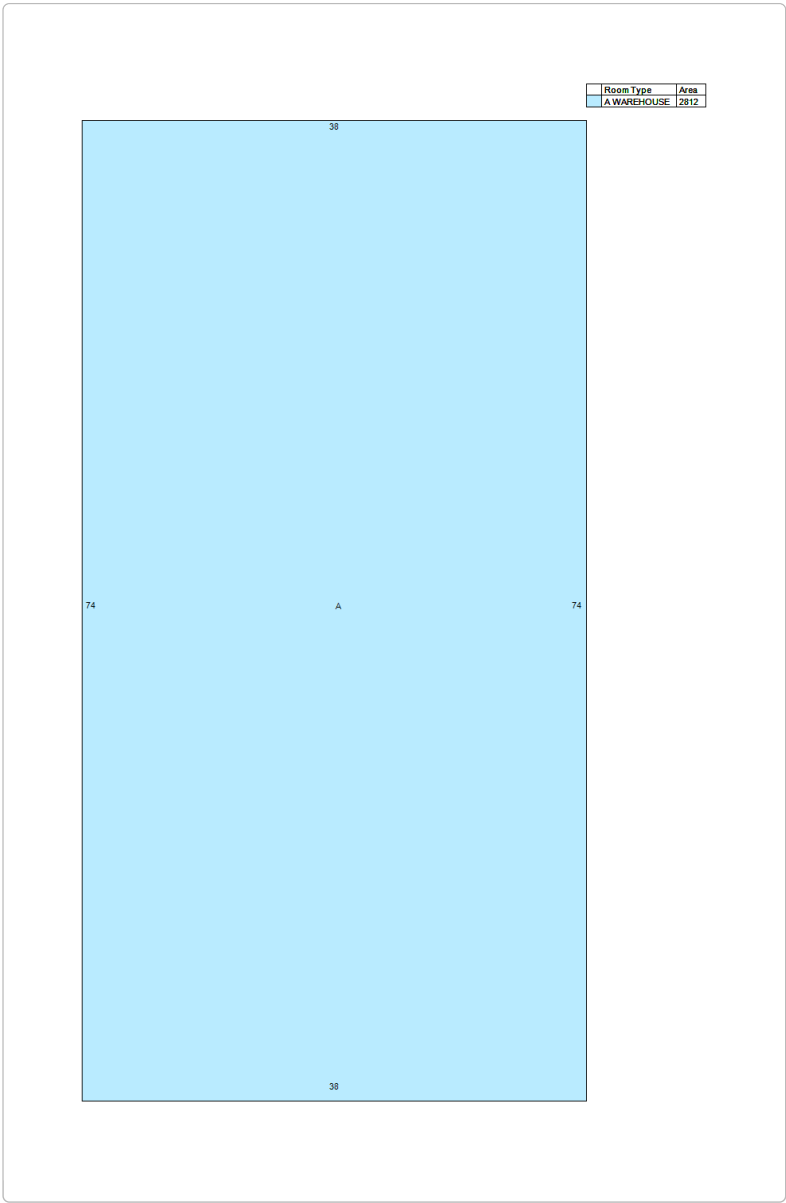

No data available for the following modules: Residential Improvement Information, Other Dwelling Features, Additions, Other Buildings & Yard Improvements, Permits.

The information displayed on this map is taken from public records, and is intended to be used as a reference. Map information is believed to be accurate, but accuracy is not guaranteed. Richland County makes no warranties, express or implied, concerning the accuracy, completeness, or reliability of this information, and assumes no liability or any other legal responsibility for the information contained on this map. The map does not represent the official survey of the land.
[User Privacy Policy](#) | [GDPR Privacy Notice](#)
 Last Data Upload: 1/28/2026, 10:39:16 AM

Contact Us

Developed by
 SCHNEIDER
 GEOSPATIAL

Richland County, OH

Summary 2026

Parcel Number 0270404517000
Location Address HARKER ST
 MANSFIELD OH 44903
Legal Description 5916 5917 EX 2 FT TRI N E PT & 5918 3.6 FT TRI S W PT 73.6 X 150 X 30 HARKER
 (Note: Not to be used on legal documents.)
Property Class C - COMMERCIAL
Land Use (480) C - COMMERCIAL WAREHOUSES
Neighborhood 02704C01
Tax District 027
Acres 0
Sec/Twp/Rng --
Township MANSFIELD
School District MANSFIELD CITY SD
Topo LEVEL
Utilities ALL PUBLIC
Roads PAVED
Traffic MEDIUM



027-04-045-17-000 03/31/2021

[View Map](#)

Owners

Owner
[CITADEL DEVELOPMENT LLC AN OHIO LIMITED](#)
 LIABILITY COMPANY
Mailing Address
 CITADEL DEVELOPMENT LLC
 30 HARKER ST
 MANSFIELD OH 44903

Valuation

Assessed Year	2025	2024	2023	2022
Land Value	\$3,030.00	\$3,030.00	\$3,030.00	\$2,750.00
Building Value	\$36,340.00	\$36,340.00	\$36,340.00	\$33,830.00
Total Value (Assessed 35%)	\$39,370.00	\$39,370.00	\$39,370.00	\$36,580.00
Land Value	\$8,650.00	\$8,650.00	\$8,650.00	\$7,870.00
Building Value	\$103,820.00	\$103,820.00	\$103,820.00	\$96,660.00
CAUV Value	\$0.00	\$0.00	\$0.00	\$0.00
Total Value (Appraised 100%)	\$112,470.00	\$112,470.00	\$112,470.00	\$104,530.00

Taxes Due

Tax Year (click for detail)	1st Half Due	2nd Half Due	Delinquent	Total Due
2025	\$1,402.50	\$1,402.50	\$3,317.68	\$6,122.68
2024	\$0.00	\$0.00	\$0.00	\$0.00
2023	\$0.00	\$0.00	\$0.00	\$0.00
2022	\$0.00	\$0.00	\$0.00	\$0.00
2021	\$0.00	\$0.00	\$0.00	\$0.00
2020	\$0.00	\$0.00	\$0.00	\$0.00
2019	\$0.00	\$0.00	\$0.00	\$0.00

Land

Descr	P	LN	CD	Acres	Frontage	Depth	Base Size	Base Rate	Sq ft.	Incr / Decr	Land-Val
Regular Lot	F	1	1	0.2445	71	150	50.00	143	10,650	71.5 / 143	\$8,650

Total Acres:
0.2445

Total Land-Value:
\$8,650

Commercial Improvement Information

Card 1
Building No 1
Structure WAREHOUSE
Year Built 1963
Effective Year 0
Grade C-

Interior/Exterior Information

Card 1

Line	Sect	From	To	Sec	Occupancy	Occ Descr	Class	Yr Built	Eff Year	Size	Area	Perim	Height	Use Type	Phy Cond	UT	Base RCN	Feat RCN	Base Value	Pct Good	Pct Comp	Adj Value
1	1	01	01		0			1963	0	6400	356	12	12	WRHSE	2	4	161,040	0	161,040	45	0	\$72,470
2	1	E1	E1		0			1963	0	600	48	12	12	ENCLOSURE	2	4	10,290	0	10,290	45	0	\$4,630
3	2	01	01		0			1963	0	2048	160	12	12	WRHSE	2	4	59,370	0	59,370	45	0	\$26,720

Sales

Date	Book	Page	Grantor	Grantee	Price	Instr Type	Sale Validity
9/28/2020			CASE CRAIG A	CITADEL DEVELOPMENT LLC AN OHIO LIMITED	\$175,000	WD	SALE INVOLVING MULTIPLE PARCELS
6/29/2004			CASE FRED A M	CASE CRAIG A	\$0	WD	RELATED INDIVIDUALS OR CORPORATIONS
5/27/2004			CASE LEWIS W	CASE FRED A M	\$0	CT	RELATED INDIVIDUALS OR CORPORATIONS

Photos



027-04-045-17-000 03/31/2021



027-04-045-17-000 05/16/2016



027-04-045-17-000 05/14/2013

Sketches

To magnify the Sketch, you may right click on the image to download or to open the image in a new tab. These options will then allow you to zoom in.

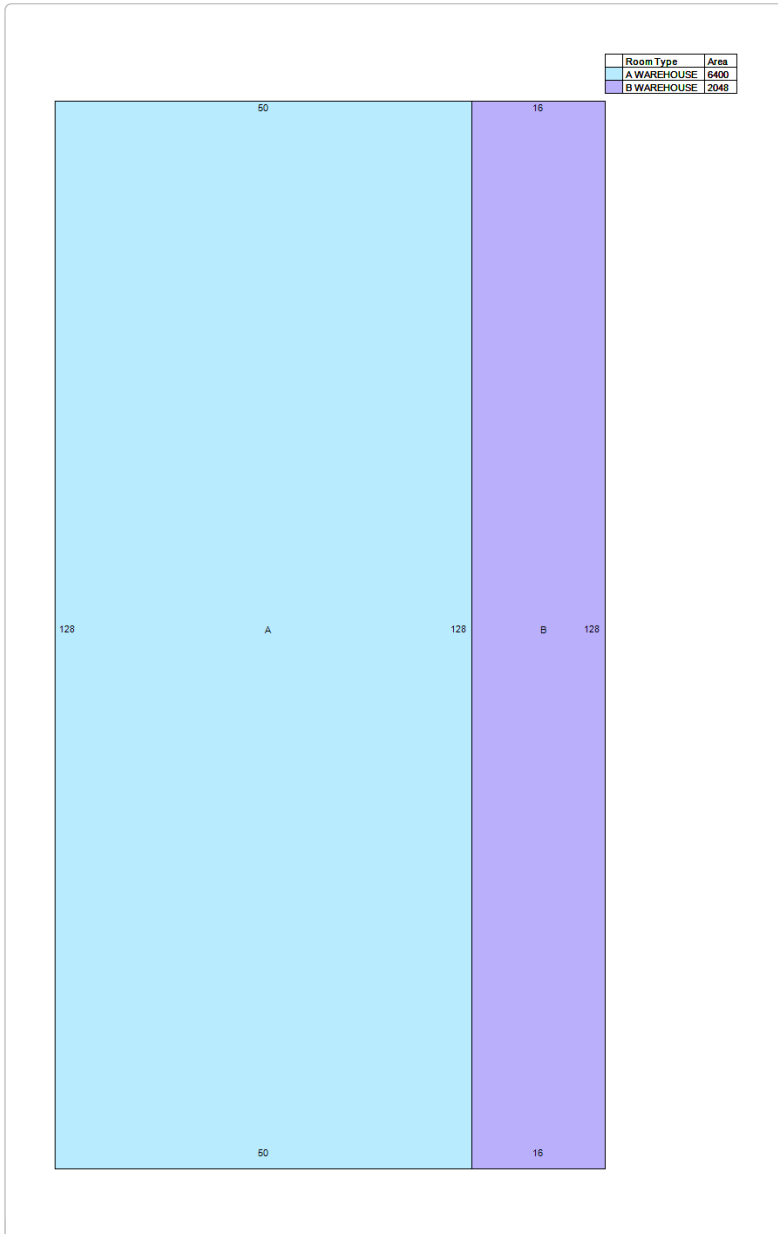

No data available for the following modules: Residential Improvement Information, Other Dwelling Features, Additions, Other Buildings & Yard Improvements, Other Features, Permits.

The information displayed on this map is taken from public records, and is intended to be used as a reference. Map information is believed to be accurate, but accuracy is not guaranteed. Richland County makes no warranties, express or implied, concerning the accuracy, completeness, or reliability of this information, and assumes no liability or any other legal responsibility for the information contained on this map. The map does not represent the official survey of the land.
[User Privacy Policy](#) | [GDPR Privacy Notice](#)
 Last Data Upload: 1/28/2026, 10:39:16 AM

Contact Us

