

Owner GAMBOA, YUDITH & GAMBOA, RAUL
Address 11709 PRINCETON AVE
 CLEVELAND, OH. 44105
Land Use (5100) R - 1-FAMILY PLATTED LOT
Description 460 COLHILL 0117 ALL
Neighborhood Code 01143

SKETCH

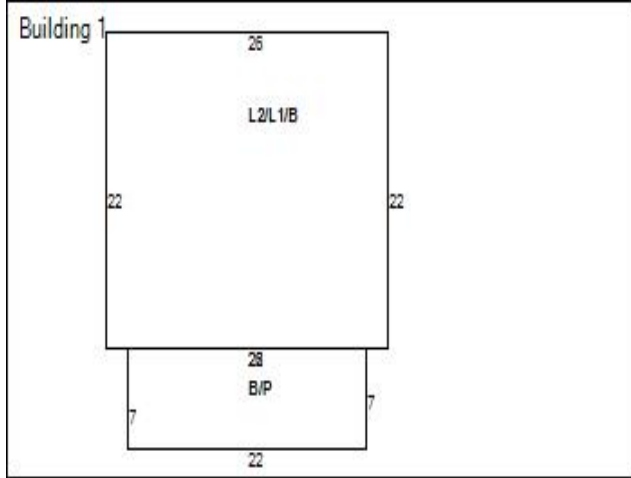

MAP VIEW

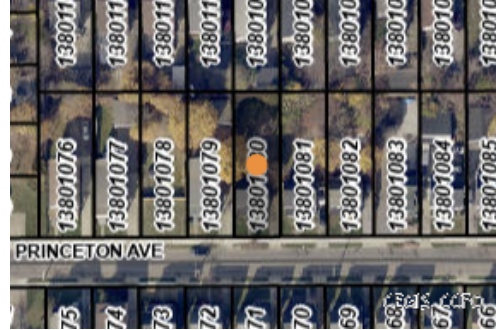

BUILDING INFORMATION

Building Record Number	1	Occupancy	1-FAMILY	Story Height	2
Style	COLONIAL	Year Built	1930	Exterior Walls	ALUM/VINYL
Condition	FAIR	Construction Quality	C / AVERAGE	Roof Type	GABLE
Roof Material	ASPH-SHINGLE	Heat Type	FORCED-AIR	Air Conditioning	NONE
Attic Type	UNFINISHED	Basement Type	BASEMENT	Basement Square Feet	226
Basement Finished	No	Rooms	6	Bedrooms	3
Bathrooms (Full/Half)	1/0	Garage Type	NONE	Garage Capacity	
Year Garage Built		Garage Size		Living Area Basement	
Living Area 1	572	Living Area 2	572	Living Area Upper	
Living Area Total	1,144	Floor Location		Party Wall	

LAND

Code	Frontage	Depth	Acreage	Sq Ft
PRM	40	120	0.11	4,800

VALUATION

2023 Values	Taxable Market Value	Exempt Market Value	Abated Market Value	Assessed Taxable Value
Land Value	\$7,900	\$0	\$0	\$2,770
Building Value	\$19,500	\$0	\$0	\$6,830
Total Value	\$27,400	\$0	\$0	\$9,600
Land Use	5100			SINGLE FAMILY DWELLING

PERMITS

Tax Year	Reason	Tax Change	Exempt Change	Percent Complete	Reinspect	Notes
----------	--------	------------	---------------	------------------	-----------	-------

IMPROVEMENTS

Type	Description	Size	Height Depth
------	-------------	------	--------------

SALES

Date	Buyer	Seller	Price
12/4/2018	GAMBOA, YUDITH & GAMBOA, RAUL	CORE CAPITAL PROPERTIES, LLC	\$3,500
8/9/2017	CORE CAPITAL PROPERTIES, LLC	DEUTSCHE BANK NATIONAL TRUST COMPANY AS TRUSTEE	\$3,000
3/7/2017	DEUTSCHE BANK NATIONAL TRUST COMPANY AS TRUSTEE	Muse, Wanda C	\$8,500
6/15/1992	Muse, Wanda C	Kenneth Lurie Inc	\$39,500
11/27/1991	Kenneth Lurie Inc	Secretary Of H.U.D.	\$0
4/23/1991	Secretary Of H.U.D.	Wesav Mortgage Corporation	\$0
4/23/1991	Wesav Mortgage Corporation	Emerson Oscar	\$18,000
7/28/1987	Emerson Oscar	Cleveland Patricia	\$27,900
1/1/1975	Cleveland Patricia		\$0

Taxes

2023 Taxes	Charges	Payments	Balance Due
Tax Balance Summary	\$2,210.67	\$1,100.00	\$1,110.67