

Owner MILLER, KATIE ANN & BRIAN DAVID
Address 121 PALMETTO AVE
 BEDFORD, OH. 44146
Land Use (5000) R - RES VACANT LAND
Description 34 GLENDALE PK 0006 ALL
Neighborhood Code 09507

SKETCH

MAP VIEW

Map Image

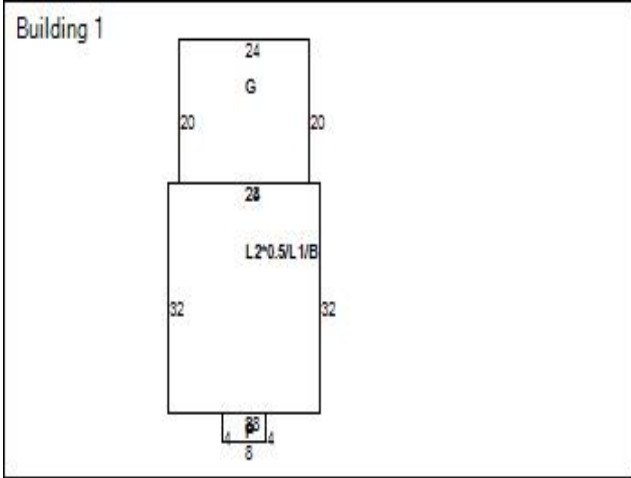

BUILDING INFORMATION

Building Record Number	1	Occupancy	1-FAMILY	Story Height	1.5
Style	CAPE COD	Year Built	1950	Exterior Walls	ALUM/VINYL
Condition	GOOD	Construction Quality	C / AVERAGE	Roof Type	GABLE
Roof Material	ASPH-SHINGLE	Heat Type	FORCED-AIR	Air Conditioning	NONE
Attic Type	NONE	Basement Type	BASEMENT	Basement Square Feet	896
Basement Finished	No	Rooms	6	Bedrooms	3
Bathrooms (Full/Half)	1/1	Garage Type	ATTACHED	Garage Capacity	2
Year Garage Built	1950	Garage Size	480	Living Area Basement	
Living Area 1	896	Living Area 2	448	Living Area Upper	
Living Area Total	1,344	Floor Location		Party Wall	

LAND

VALUATION

Code	Frontage	Depth	Acreage	Sq Ft
PRM	32	210	0.15	6,720

2023 Values	Taxable Market Value	Exempt Market Value	Abated Market Value	Assessed Taxable Value
Land Value	\$4,400	\$0	\$0	\$1,540
Building Value	\$0	\$0	\$0	\$0
Total Value	\$4,400	\$0	\$0	\$1,540
Land Use	5000			RESIDENTIAL VACANT LAND

PERMITS

IMPROVEMENTS

Tax Year	Reason	Tax Change	Exempt Change	Percent Complete	Reinspect	Notes
----------	--------	------------	---------------	------------------	-----------	-------

Type	Description	Size	Height Depth
------	-------------	------	--------------

SALES

Date	Buyer	Seller	Price
8/12/2019	MILLER, KATIE ANN & BRIAN DAVID	FEDERAL NATIONAL MORTGAGE ASSOCIATION	\$0
12/26/2018	FEDERAL NATIONAL MORTGAGE ASSOCIATION	WARD, ERIC S. & SUSAN M.	\$0
5/3/2006	WARD, ERIC S. & SUSAN M.	Petitti, Frank	\$144,000
3/19/1999	Petitti, Frank	Federal Natl Mort Assn	\$0
11/13/1998	Federal Natl Mort Assn	Huy Jr, William F	\$0
6/28/1995	Huy Jr, William F	Rayner Lyle C & Carol L	\$110,900
3/27/1985	Rayner Lyle C & Carol L	Rayner Lyle C & Carol L	\$0
1/1/1975	Rayner Lyle C & Carol L		\$0

Taxes

2023 Taxes	Charges	Payments	Balance Due
Tax Balance Summary	\$135.22	\$135.22	\$0.00