

Summary

Parcel Number 0532200100
 Location Address 1839 BALTIMORE RD
 LANCASTER OH 43130
 Legal Description OSCAR HENRY'S SUB-DIV LOT 3
 (Note: Not to be used on legal documents.)
 Property Class R - RESIDENTIAL
 Land Use (510) R - SINGLE FAMILY DWELLING, PLATTED LOT
 Neighborhood 00021000
 Legal Acres 0
 City LANCASTER
 Township LANCASTER CORPORATION
 School District LANCASTER C.S.D.
 Owner Occupancy Credit YES
 Homestead Reduction NO

[View Map](#)

Owner

Owner
[MCCORMICK REBECCA S](#)
 1839 BALTIMORE RD NW
 LANCASTER OH 43130
 Tax Mailing Address
 MCCORMICK REBECCA S
 1839 BALTIMORE RD NW
 LANCASTER OH 43130

[Submit Mailing / Site Address Correction Request](#)

Valuation

Tax Year 2024 Tentative Valuation

Tax Year	2024
Land Value	\$28,800.00
Building Value	\$125,720.00
Total Value (Appraised 100%)	\$154,520.00
Land Value	\$10,080.00
Building Value	\$44,000.00
Total Value (Assessed 35%)	\$54,080.00
Land CAUV Value	\$0.00
Taxable Value	\$54,080.00

Valuation History

Tax Year	Appraised Land Value	Appraised Building Value	Appraised Total Value	Assessed Land Value	Assessed Building Value	Assessed Total Value	CAUV	Taxable Value
2024	\$28,800	\$125,720	\$154,520	\$10,080	\$44,000	\$54,080	\$0	\$54,080
2023	\$28,800	\$125,720	\$154,520	\$10,080	\$44,000	\$54,080	\$0	\$54,080
2022	\$28,800	\$125,720	\$154,520	\$10,080	\$44,000	\$54,080	\$0	\$54,080
2021	\$28,800	\$95,240	\$124,040	\$10,080	\$33,330	\$43,410	\$0	\$43,410
2020	\$28,800	\$95,240	\$124,040	\$10,080	\$33,330	\$43,410	\$0	\$43,410
2019	\$28,800	\$95,240	\$124,040	\$10,080	\$33,330	\$43,410	\$0	\$43,410
2018	\$27,360	\$79,690	\$107,050	\$9,580	\$27,890	\$37,470	\$0	\$37,470
2017	\$27,360	\$79,690	\$107,050	\$9,580	\$27,890	\$37,470	\$0	\$37,470
2016	\$27,360	\$79,690	\$107,050	\$9,580	\$27,890	\$37,470	\$0	\$37,470
2015	\$27,360	\$76,010	\$103,370	\$9,580	\$26,600	\$36,180	\$0	\$36,180
2014	\$27,360	\$76,010	\$103,370	\$9,580	\$26,600	\$36,180	\$0	\$36,180
2013	\$27,360	\$76,010	\$103,370	\$9,580	\$26,600	\$36,180	\$0	\$36,180
2012	\$27,360	\$83,610	\$110,970	\$9,580	\$29,260	\$38,840	\$0	\$38,840

Land

Disclaimer: Acreage and Lot Sizes within this section do NOT represent the Legal Survey or Deeded Acreage of the parcel.

Lots Sizes shown here are intended for valuation purposes only.

Description	Acres	Square Feet	Value
REGULAR LOT	0.2617	11,400	\$28,800

Total Acres:
0.2617
Total Land-Value:
\$28,800

Dwellings

Card	1	Condition	AV
Stories	1	Exterior Wall	ALUM/VINYL
Year Built	1930	Heat	AIR CONDITIONING
Total Rooms	5	Heating Fuel Type	GAS
Bedrooms	3	Attic	NONE
Full Baths	1	Basement	FULL
Half Baths	0	Fireplace Openings	0
Total Living Area	1360	WBFP Stacks	0
Rec Room Area	300	Prefab Fireplace	0
Brick/Stone Trim Area	0	Unfinished Area	0
Grade	C-	Finished Basement Area	0
Style	RANCH	Year Remodeled	0

Sales

Transfer Date	Sale Date	Seller	Buyer	Sale Price	Sale Validity	Book - Page	Instrument #
	5/10/2013	SHOOK RONALD R	MCCORMICK REBECCA S	\$78,900	MULTI-PARCEL NOT VALID	1632-1899	
	9/26/2003	SHOOK BERNICE F	SHOOK RONALD R	\$0	NOT OPEN MARKET	1309-1336	
3/14/1996	3/13/1996	SHOOK WM W	SHOOK WM W	\$0	UNVALIDATED SALES	645-321	

Tax History

Taxes shown below HAVE BEEN certified by the Fairfield County Auditor.

Tax Year (click for detail)	Prior Charges	Full Year Total	Payments	Half Year Due	Full Year Due
2023 Pay 2024	\$0.00	\$2,017.84	\$983.34	\$25.58	\$1,034.50
2022 Pay 2023	\$0.00	\$1,974.84	\$1,974.84	\$0.00	
2021 Pay 2022	\$0.00	\$1,692.04	\$1,692.04	\$0.00	
2020 Pay 2021	\$0.00	\$1,701.34	\$1,701.34	\$0.00	
2019 Pay 2020	\$0.00	\$1,541.46	\$1,541.46	\$0.00	

Payments

Date	Amount
2/14/2024	(\$983.34)
7/5/2023	(\$987.42)
2/3/2023	(\$987.42)
7/8/2022	(\$846.02)
2/7/2022	(\$846.02)
7/1/2021	(\$850.67)
2/11/2021	(\$850.67)

Sketches

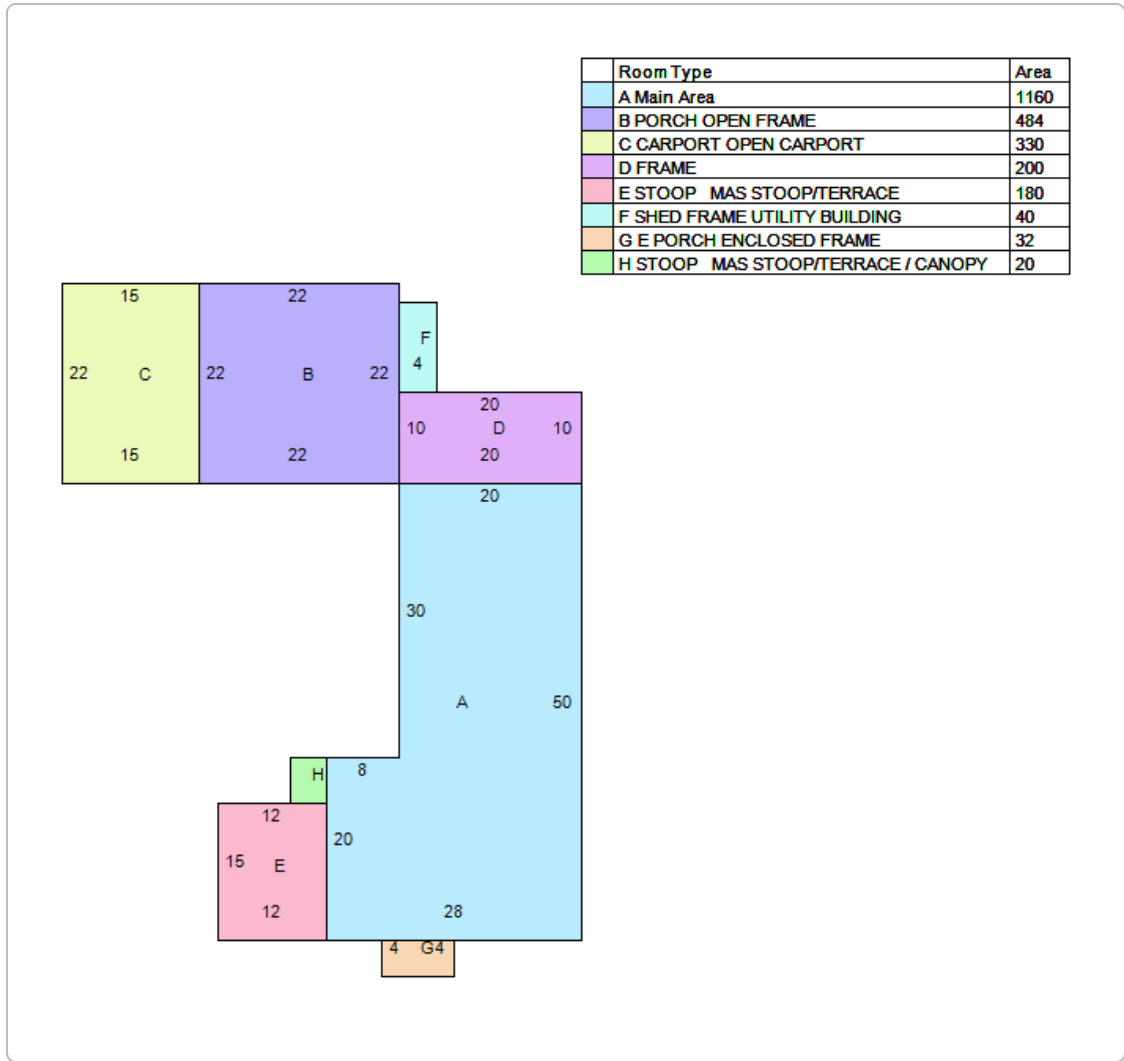

Tax Bill

Please note: The URL to make tax payments has changed. We are working on getting the Treasurer link updated in the Tax Bill but in the mean time, please go to <https://www.co.fairfield.oh.us/TREASURER/>

Property Card

Pay Your Taxes Online

Please verify exact amounts with the Treasurer's Office at (740) 652-7140

No data available for the following modules: Soils, Commercial Improvement Information, Interior/Exterior Information, Improvements, Other Features, Permits, Special Assessments, Photos.



[User Privacy Policy](#) [GDPR Privacy Notice](#)
 Last Data Upload: 6/5/2024, 11:36:00 AM