

**Owner** K.A.J. REAL ESTATE LLC  
**Address** 3855 W 42 ST  
 CLEVELAND, OH. 44109  
**Land Use** (5100) R - 1-FAMILY PLATTED LOT  
**Description** 56 POE 0011 ALL  
**Neighborhood Code** 02143

**SKETCH**

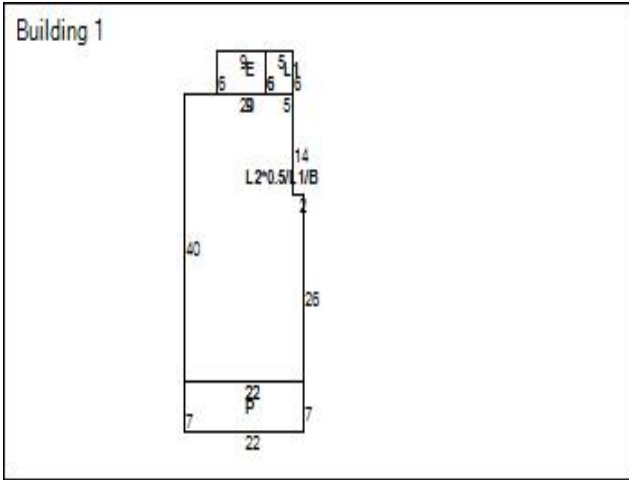

**MAP VIEW**



**BUILDING INFORMATION**

Building Record Number	1	Occupancy	1-FAMILY	Story Height	1.5
Style	CAPE COD	Year Built	1910	Exterior Walls	FRAME
Condition	FAIR	Construction Quality	C / AVERAGE	Roof Type	GABLE
Roof Material	ASPH-SHINGLE	Heat Type	FORCED-AIR	Air Conditioning	NONE
Attic Type	NONE	Basement Type	BASEMENT	Basement Square Feet	852
Basement Finished	No	Rooms	10	Bedrooms	5
Bathrooms (Full/Half)	2/0	Garage Type	NONE	Garage Capacity	
Year Garage Built		Garage Size		Living Area Basement	
Living Area 1	882	Living Area 2	639	Living Area Upper	
Living Area Total	1,521	Floor Location		Party Wall	

**LAND**

Code	Frontage	Depth	Acreage	Sq Ft
PRM	40	88	0.08	3,520

**VALUATION**

2023 Values	Taxable Market Value	Exempt Market Value	Abated Market Value	Assessed Taxable Value
Land Value	\$9,800	\$0	\$0	\$3,430
Building Value	\$9,200	\$0	\$0	\$3,220
Total Value	\$19,000	\$0	\$0	\$6,650
Land Use	5100			SINGLE FAMILY DWELLING

**PERMITS**

Tax Year	Reason	Tax Change	Exempt Change	Percent Complete	Reinspect	Notes
----------	--------	------------	---------------	------------------	-----------	-------

**IMPROVEMENTS**

Type	Description	Size	Height Depth
------	-------------	------	--------------

**SALES**

Date	Buyer	Seller	Price
10/23/2019	K.A.J. REAL ESTATE LLC	TORRES, EVELYN JANNETTE RIVERA	\$0
9/10/2019	TORRES, EVELYN JANNETTE RIVERA	INTEGRATED HOME SOLUTIONS, LLC.,	\$127,000
9/10/2019	INTEGRATED HOME SOLUTIONS, LLC.,	Halmos John P.	\$90,000
12/29/2016	Halmos John P.	Halmos John P.	\$0
8/28/1991	Halmos John P.	Iris May Johnson	\$8,000
5/17/1979	Iris May Johnson	Johnson Donald John	\$0
11/22/1977	Johnson Donald John	Johnson Donald & Iris	\$11,800
1/1/1975	Johnson Donald & Iris		\$0

**Taxes**

2023 Taxes	Charges	Payments	Balance Due
Tax Balance Summary	\$515.52	\$257.76	\$257.76