

Owner K.A.J. REAL ESTATE LLC
Address 4137 W 36 ST
 CLEVELAND, OH. 44109
Land Use (5100) R - 1-FAMILY PLATTED LOT
Description 57 FULLER S/L 2 NWP 0001 WP
Neighborhood Code 02142

SKETCH

MAP VIEW

Map Image

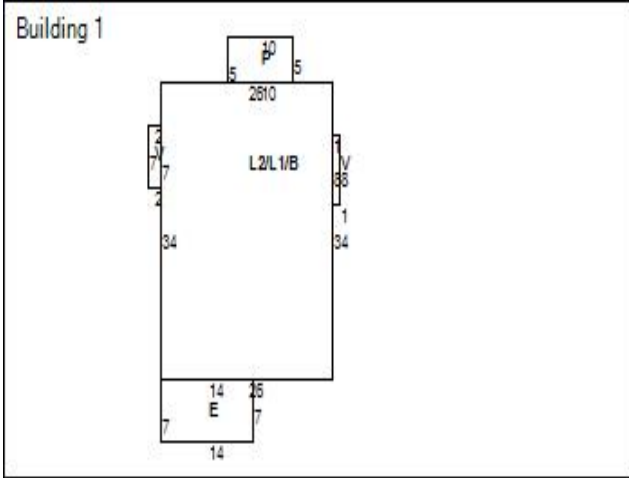

BUILDING INFORMATION

Building Record Number	1	Occupancy	1-FAMILY	Story Height	2
Style	COLONIAL	Year Built	1900	Exterior Walls	ALUM/VINYL
Condition	FAIR	Construction Quality	C / AVERAGE	Roof Type	GABLE
Roof Material	ASPH-SHINGLE	Heat Type	FORCED-AIR	Air Conditioning	NONE
Attic Type	UNFINISHED	Basement Type	BASEMENT	Basement Square Feet	884
Basement Finished	No	Rooms	8	Bedrooms	2
Bathrooms (Full/Half)	1/0	Garage Type	DETACHED	Garage Capacity	1
Year Garage Built	1920	Garage Size	280	Living Area Basement	
Living Area 1	906	Living Area 2	884	Living Area Upper	
Living Area Total	1,790	Floor Location		Party Wall	

LAND

VALUATION

Code	Frontage	Depth	Acreage	Sq Ft
PRM	69	90	0.14	6,210

2023 Values	Taxable Market Value	Exempt Market Value	Abated Market Value	Assessed Taxable Value
Land Value	\$18,600	\$0	\$0	\$6,510
Building Value	\$40,500	\$0	\$0	\$14,180
Total Value	\$59,100	\$0	\$0	\$20,690
Land Use	5100			SINGLE FAMILY DWELLING

PERMITS

IMPROVEMENTS

Tax Year	Reason	Tax Change	Exempt Change	Percent Complete	Reinspect	Notes
----------	--------	------------	---------------	------------------	-----------	-------

Type	Description	Size	Height Depth
------	-------------	------	--------------

SALES

Date	Buyer	Seller	Price
10/23/2019	K.A.J. REAL ESTATE LLC	TORRES, EVELYN JANEETTE RIVERA	\$0
9/27/2019	TORRES, EVELYN JANEETTE RIVERA	INTEGRATED HOME SOLUTIONS, LLC	\$81,000
9/27/2019	INTEGRATED HOME SOLUTIONS, LLC	Halmos, John	\$65,000
12/29/2016	Halmos, John	Halmos, John	\$0
7/19/1990	Halmos, John	Strichko James W	\$20,700
8/3/1983	Strichko James W	Vannatter Wallace F & Wilma	\$32,000
1/1/1975	Vannatter Wallace F & Wilma		\$0

Taxes

2023 Taxes	Charges	Payments	Balance Due
Tax Balance Summary	\$1,603.94	\$801.97	\$801.97