

Owner K.A.J. REAL ESTATE LLC
Address 3617 W 46 ST
 CLEVELAND, OH. 44102
Land Use (5200) R - 2-FAMILY PLATTED LOT
Description 46 HARDY 0035 ALL
Neighborhood Code 02130

SKETCH

MAP VIEW

Map Image

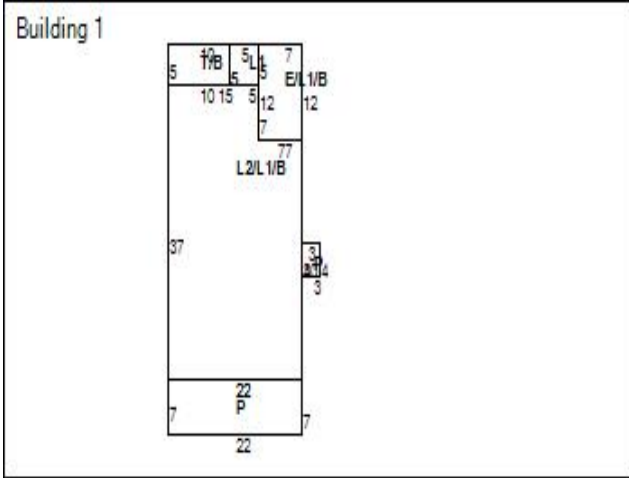

BUILDING INFORMATION

Building Record Number	1	Occupancy	2-FAMILY	Story Height	2
Style	COLONIAL	Year Built	1900	Exterior Walls	FRAME
Condition	FAIR	Construction Quality	C / AVERAGE	Roof Type	GABLE
Roof Material	ASPH-SHINGLE	Heat Type	FORCED-AIR	Air Conditioning	NONE
Attic Type	UNFINISHED	Basement Type	BASEMENT	Basement Square Feet	902
Basement Finished	No	Rooms	8	Bedrooms	4
Bathrooms (Full/Half)	2/0	Garage Type	DETACHED	Garage Capacity	2
Year Garage Built	1900	Garage Size	360	Living Area Basement	
Living Area 1	852	Living Area 2	762	Living Area Upper	
Living Area Total	1,614	Floor Location		Party Wall	

LAND

VALUATION

Code	Frontage	Depth	Acreage	Sq Ft
PRM	34	100	0.08	3,400

2023 Values	Taxable Market Value	Exempt Market Value	Abated Market Value	Assessed Taxable Value
Land Value	\$8,300	\$0	\$0	\$2,910
Building Value	\$36,700	\$0	\$0	\$12,850
Total Value	\$45,000	\$0	\$0	\$15,760
Land Use	5200			TWO FAMILY DWELLING

PERMITS

IMPROVEMENTS

Tax Year	Reason	Tax Change	Exempt Change	Percent Complete	Reinspect	Notes
----------	--------	------------	---------------	------------------	-----------	-------

Type	Description	Size	Height Depth
------	-------------	------	--------------

SALES

Date	Buyer	Seller	Price
10/23/2019	K.A.J. REAL ESTATE LLC	TORRES, EVELYN JANNETTE RIVERA	\$0
8/26/2019	TORRES, EVELYN JANNETTE RIVERA	INTEGRATED HOME SOLUTIONS, LLC	\$45,000
8/26/2019	INTEGRATED HOME SOLUTIONS, LLC	Halmos, John P.	\$30,000
12/29/2016	Halmos, John P.	Halmos, John P.	\$0
12/18/1996	Halmos, John P.	Perry, Wayne M.	\$13,000
11/24/1993	Perry, Wayne M.	Miller, John S.	\$22,500
11/24/1993	Miller, John S.	Furcsik John	\$17,500
2/23/1990	Furcsik John	Miller Robt Jr & Tector Thos	\$20,100
5/8/1979	Miller Robt Jr & Tector Thos	Odom Leon W & Joyce	\$18,000
1/1/1975	Odom Leon W & Joyce		\$0

Taxes

2023 Taxes	Charges	Payments	Balance Due
Tax Balance Summary	\$1,221.74	\$610.87	\$610.87