

Owner K.A.J. REAL ESTATE LLC
Address 3314 W 86 ST
 CLEVELAND, OH. 44102
Land Use (5200) R - 2-FAMILY PLATTED LOT
Description 14-27 SEIDMAN 0328 ALL
Neighborhood Code 02125

SKETCH

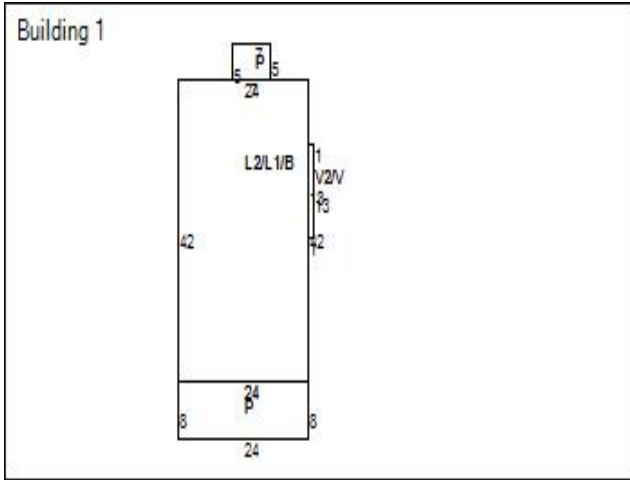

MAP VIEW



BUILDING INFORMATION

Building Record Number	1	Occupancy	2-FAMILY	Story Height	2
Style	COLONIAL	Year Built	1919	Exterior Walls	FRAME
Condition	FAIR	Construction Quality	C+ / AVERAGE+	Roof Type	GABLE
Roof Material	SLATE	Heat Type	FORCED-AIR	Air Conditioning	NONE
Attic Type	UNFINISHED	Basement Type	BASEMENT	Basement Square Feet	1,008
Basement Finished	No	Rooms	10	Bedrooms	4
Bathrooms (Full/Half)	2/0	Garage Type	DETACHED	Garage Capacity	2
Year Garage Built	1953	Garage Size	528	Living Area Basement	
Living Area 1	1,028	Living Area 2	1,028	Living Area Upper	
Living Area Total	2,056	Floor Location		Party Wall	

LAND

Code	Frontage	Depth	Acreage	Sq Ft
PRM	35	131	0.11	4,585

VALUATION

2023 Values	Taxable Market Value	Exempt Market Value	Abated Market Value	Assessed Taxable Value
Land Value	\$12,200	\$0	\$0	\$4,270
Building Value	\$31,800	\$0	\$0	\$11,130
Total Value	\$44,000	\$0	\$0	\$15,400
Land Use	5200			TWO FAMILY DWELLING

PERMITS

Tax Year	Reason	Tax Change	Exempt Change	Percent Complete	Reinspect	Notes
----------	--------	------------	---------------	------------------	-----------	-------

IMPROVEMENTS

Type	Description	Size	Height Depth
------	-------------	------	--------------

SALES

Date	Buyer	Seller	Price
10/23/2019	K.A.J. REAL ESTATE LLC	TORRES, EVELYN JANNETE RIVERA	\$0
8/15/2019	TORRES, EVELYN JANNETE RIVERA	CUYAHOGA HOMES, LLC	\$44,000
8/6/2019	CUYAHOGA HOMES, LLC	SARANTOPOULOU, DESPINA & ATHAN	\$23,000
2/20/2009	SARANTOPOULOU, DESPINA & ATHAN	LENNEX DEVELOPEMENT GROUP, LTD	\$0
2/14/2008	LENNEX DEVELOPEMENT GROUP, LTD	PLEDGED PROPERTY II, LLC	\$16,500
5/29/2007	PLEDGED PROPERTY II, LLC	Santiago, Edith	\$50,000
4/17/2000	Santiago, Edith	Marencik Jos M Jr	\$61,000
1/1/1975	Marencik Jos M Jr		\$0

Taxes

2023 Taxes	Charges	Payments	Balance Due
Tax Balance Summary	\$1,193.82	\$596.91	\$596.91