

Owner K.A.J. REAL ESTATE LLC
Address 1701 GALION AVE
 CLEVELAND, OH. 44109
Land Use (5100) R - 1-FAMILY PLATTED LOT
Description 75 ALTENBERND 0023 ALL
Neighborhood Code 02142

SKETCH

MAP VIEW

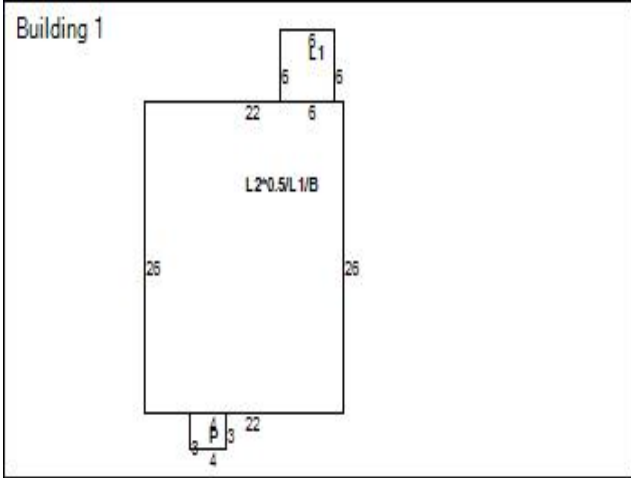

Map Image

BUILDING INFORMATION

Building Record Number	1	Occupancy	1-FAMILY	Story Height	1.5
Style	CAPE COD	Year Built	1914	Exterior Walls	ALUM/VINYL
Condition	AVERAGE	Construction Quality	D / POOR	Roof Type	GABLE
Roof Material	ASPH-SHINGLE	Heat Type	FORCED-AIR	Air Conditioning	NONE
Attic Type	NONE	Basement Type	BASEMENT	Basement Square Feet	572
Basement Finished	No	Rooms	5	Bedrooms	3
Bathrooms (Full/Half)	1/0	Garage Type	DETACHED	Garage Capacity	1
Year Garage Built	1914	Garage Size	252	Living Area Basement	
Living Area 1	608	Living Area 2	286	Living Area Upper	
Living Area Total	894	Floor Location		Party Wall	

LAND

VALUATION

Code	Frontage	Depth	Acreage	Sq Ft
PRM	40	80	0.07	3,200

2023 Values	Taxable Market Value	Exempt Market Value	Abated Market Value	Assessed Taxable Value
Land Value	\$13,500	\$0	\$0	\$4,730
Building Value	\$34,600	\$0	\$0	\$12,110
Total Value	\$48,100	\$0	\$0	\$16,840
Land Use	5100			SINGLE FAMILY DWELLING

PERMITS

IMPROVEMENTS

Tax Year	Reason	Tax Change	Exempt Change	Percent Complete	Reinspect	Notes
----------	--------	------------	---------------	------------------	-----------	-------

Type	Description	Size	Height Depth
------	-------------	------	--------------

SALES

Date	Buyer	Seller	Price
10/23/2019	K.A.J. REAL ESTATE LLC	TORRES, EVELYN JANEETTE RIVERA	\$0
9/27/2019	TORRES, EVELYN JANEETTE RIVERA	INTEGRATED HOME SOLUTIONS, LLC	\$81,000
9/27/2019	INTEGRATED HOME SOLUTIONS, LLC	Halmos John P	\$65,000
12/29/2016	Halmos John P	Halmos John P	\$0
7/23/1980	Halmos John P	Sherman Susan	\$10,800
1/1/1975	Sherman Susan		\$0

Taxes

2023 Taxes	Charges	Payments	Balance Due
Tax Balance Summary	\$1,305.46	\$652.73	\$652.73