

**Owner** CHILTON, JANET  
**Address** 1329 W 61 ST  
 CLEVELAND, OH. 44102  
**Land Use** (5200) R - 2-FAMILY PLATTED LOT  
**Description** 31 PERKINS S/L 177 SP 0176 NP  
**Neighborhood Code** 02116

### SKETCH

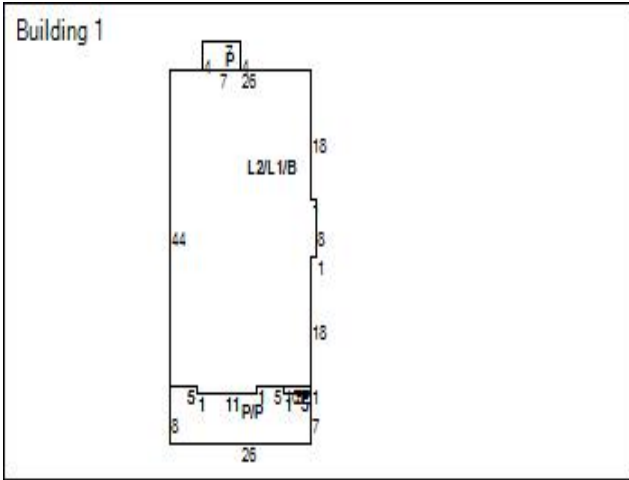

### MAP VIEW



### BUILDING INFORMATION

|                        |            |                      |            |                      |            |
|------------------------|------------|----------------------|------------|----------------------|------------|
| Building Record Number | 1          | Occupancy            | 2-FAMILY   | Story Height         | 2          |
| Style                  | COLONIAL   | Year Built           | 1920       | Exterior Walls       | ALUM/VINYL |
| Condition              | FAIR       | Construction Quality | D+ / POOR+ | Roof Type            | GABLE      |
| Roof Material          | SLATE      | Heat Type            | FORCED-AIR | Air Conditioning     | NONE       |
| Attic Type             | UNFINISHED | Basement Type        | BASEMENT   | Basement Square Feet | 1,168      |
| Basement Finished      | No         | Rooms                | 10         | Bedrooms             | 4          |
| Bathrooms (Full/Half)  | 2/0        | Garage Type          | DETACHED   | Garage Capacity      | 1          |
| Year Garage Built      | 1960       | Garage Size          | 280        | Living Area Basement |            |
| Living Area 1          | 1,168      | Living Area 2        | 1,168      | Living Area Upper    |            |
| Living Area Total      | 2,336      | Floor Location       |            | Party Wall           |            |

### LAND

| Code | Frontage | Depth | Acreage | Sq Ft |
|------|----------|-------|---------|-------|
| PRM  | 40       | 105   | 0.1     | 4,200 |

### VALUATION

| 2022 Values    | Taxable Market Value | Exempt Market Value | Abated Market Value | Assessed Taxable Value |
|----------------|----------------------|---------------------|---------------------|------------------------|
| Land Value     | \$30,900             | \$0                 | \$0                 | \$10,820               |
| Building Value | \$103,100            | \$0                 | \$0                 | \$36,090               |
| Total Value    | \$134,000            | \$0                 | \$0                 | \$46,910               |
| Land Use       | 5200                 |                     |                     | TWO FAMILY DWELLING    |

### PERMITS

| Tax Year | Reason | Tax Change | Exempt Change | Percent Complete | Reinspect | Notes |
|----------|--------|------------|---------------|------------------|-----------|-------|
|----------|--------|------------|---------------|------------------|-----------|-------|

### IMPROVEMENTS

| Type | Description | Size | Height Depth |
|------|-------------|------|--------------|
|------|-------------|------|--------------|

### SALES

| Date       | Buyer              | Seller             | Price    |
|------------|--------------------|--------------------|----------|
| 11/27/1995 | Chilton, Janet     | Chilton Jr, Paul D | \$0      |
| 9/29/1995  | Chilton Jr, Paul D | Chilton Paul D     | \$38,000 |
| 8/12/1986  | Chilton Paul D     | Bidelman Maria G   | \$40,000 |
| 5/27/1977  | Bidelman Maria G   | Parente Louis & S  | \$23,500 |
| 1/1/1975   | Parente Louis & S  |                    | \$0      |

### Taxes

| 2022 Taxes          | Charges     | Payments    | Balance Due |
|---------------------|-------------|-------------|-------------|
| Tax Balance Summary | \$33,921.40 | \$12,508.25 | \$21,413.15 |