

**PROFILE**

<b>Parcel</b>	Q6511002000018	<b>Municipality</b>	MIDDLETOWN
<b>Alt_ID</b>		<b>NBHD</b>	90019001
<b>Address</b>	112 S MAIN ST	<b>InterCounty</b>	9-Q6511
<b>Owner</b>	KETTERING NETWORK SERVICES	<b>School District</b>	Q65
<b>Owner</b>		<b>Zoning</b>	N/A
<b>Mailing Addr</b>	1 PRESTIGE PL	<b>Utilities</b>	ALL PUBLIC
<b>Mailing Addr</b>		<b>Utilities</b>	
<b>Mailing Addr</b>	MIAMISBURG OH 45342	<b>Utilities</b>	
<b>Description</b>	56 N 1/2	<b>Land Area</b>	
<b>Description</b>		<b>Street/Road</b>	MAIN
<b>Description</b>		<b>Subdivision Name</b>	
<b>Land Use Code</b>	442	<b>Subdivision No.</b>	
<b>LUC Description</b>	C - MEDICAL CLINICS AND OFFICES		

**VALUE SUMMARY**

<b>Land</b>	34300	<b>Building</b>	50180	<b>Total</b>	84480
<b>Assessed Land</b>	12010	<b>Assessed Building</b>	17560	<b>Assessed Total</b>	29570
<b>Prior Land</b>	34300	<b>Prior Building</b>	50180	<b>Prior Total</b>	84480

**PRIMARY RESIDENTIAL CARD**

<b>Card</b>	<b>Basement</b>	<b>Frpl Prefab</b>	0
<b>Stories</b>	<b>SFLA</b>	<b>Frpl OP/ST</b>	
<b>Use</b>	<b>HT/AC</b>	<b>Bsmt Gar</b>	0
<b>Type</b>	<b>Fuel</b>	<b>Grade</b>	
<b>Year Built</b>	<b>System</b>	<b>Cond (CDU)</b>	
<b>Year Remld</b>	<b>Attic</b>	<b>% Complete</b>	
<b>Total Rooms</b>	<b>Fin Basement</b>	<b>Family Room</b>	
<b>Bedroom</b>	<b>Rec Room</b>	<b>Ext. Material</b>	
<b>Full Bath</b>	<b>Half Bath</b>		

**COMMERCIAL CARD**

<b>Year Built</b>	1869	<b>Stories</b>		<b>Roof</b>	
<b>Eff. Yr. Built</b>		<b>Gross Flr. Area</b>		<b>Floor</b>	
<b>Units</b>	1	<b>Units</b>	ORA-01722: invalid nu		
<b>Description</b>	1	<b>Description</b>			

**LAND**

<b>Classification</b>	<b>Eff. Front</b>	<b>Eff. Depth</b>	<b>Type</b>	<b>Ag.</b>
1			S-SQUARE FOOT	0.225

**AGRICULTURE**

Classification	Sub Class	Acres
----------------	-----------	-------

**OTHER ITEMS**

Code	Description	Yr Blt	Sq Ft
------	-------------	--------	-------

CI1	CI1 - ASPHALT	1980	5000
-----	---------------	------	------

**SALES HISTORY**

Date	Book-Page	Grantor	Sale	Desc	Parcels	Amount
22-DEC-1997	--	GAKER CAROLYN S TR	0	0		125,000
05-MAR-2021	--	GAKER DOUGLAS L TR	B	BYPASS FOR MKT	1	135,000
07-MAR-1997	--	GAKER CAROLYN S	8	UNVALIDATED SALES		0
18-NOV-1996	--	GAKER LOUIS B	8	UNVALIDATED SALES		0
30-OCT-1998	--	GAKER DOUGLAS L	8	UNVALIDATED SALES		0

**EXEMPTION INFO**

<b>Desc1</b>	0	<b>Desc1</b>	0
<b>Desc2</b>	0	<b>Desc2</b>	0
<b>Desc3</b>	0	<b>Desc3</b>	
<b>Desc4</b>	0	<b>Desc4</b>	0

**MAP**

**PHOTO**

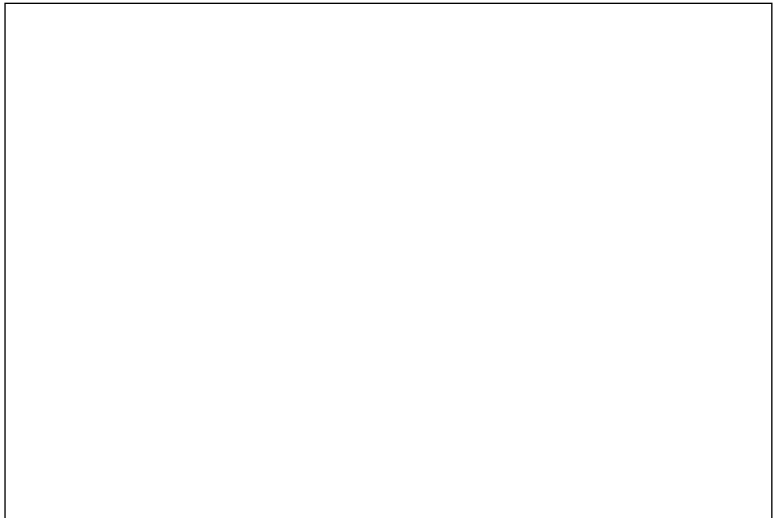
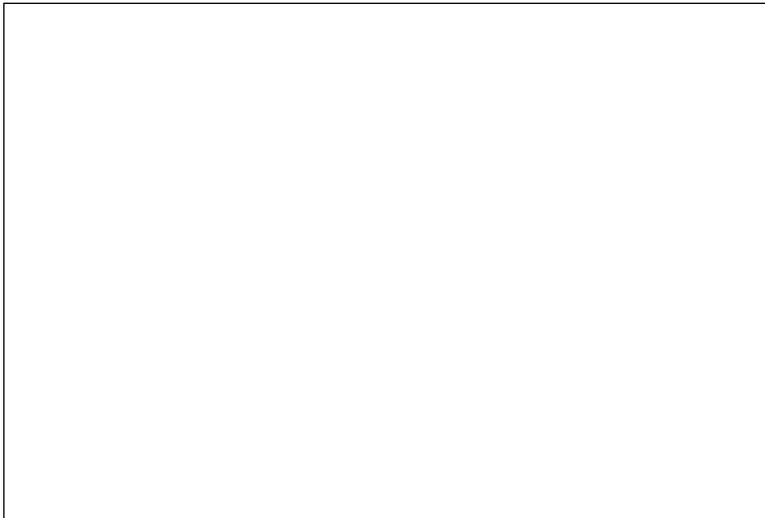

**SKETCH**

**Sketch Legend**

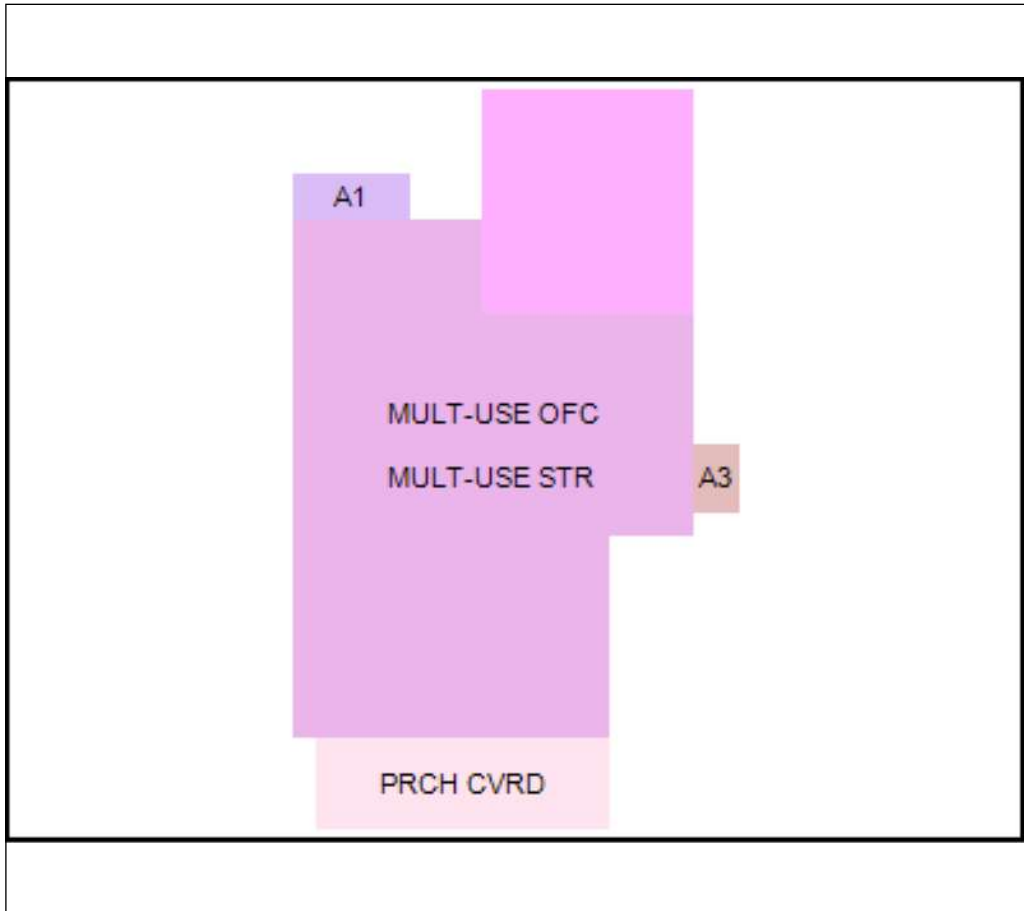

- 2 MULT-USE OFC - 082:MULTI-USE OFFICE 1575 Sq. Ft.
- 3 MULT-USE STR - 084:MULTI-USE STORAGE 1233 Sq. Ft.
- 1 PRCH CVRD - PR5:PORCH COVERED 200 Sq. Ft.
- 2 PRCH CVRD - PR5:PORCH COVERED 24 Sq. Ft.
- 3 PORCH, ENCLS - PR2:PORCH, ENCLOSED 40 Sq. Ft.
- 1 UNFIN BSMT - 091:UNFIN RES BSMT 308 Sq. Ft.
- 1 PVG ASPHAL - C11:ASPHALT OR BLACKTOP PAVING 5000 Sq. Ft.