

PARID: 222614H082.

IRETON ENNES & KINNEY PATRICIA

1995 FRANKLIN LAUREL RD

Parcel

Address 1995 FRANKLIN LAUREL RD
 Unit #
 Class AGRICULTURAL
 Land Use Code 101-A - CASH GRAIN OR GENERAL FARM
 (Note: Land Use is for valuation purposes only. Consult the local jurisdiction for zoning and legal use.)
 Tax Roll RP_OH
 Neighborhood 02516A22
 Total Acres 2.714
 Taxing District 22
 District Name MONROE TWP / NEW RICHMOND EVSD
 Gross Tax Rate 74.05
 Effective Tax Rate 51.927087
 Non-Business Credit 6.9570
 Owner Occupancy Credit 1.7392

Owner

Owner 1 IRETON ENNES &
 Owner 2 KINNEY PATRICIA

Tax Mailing Name and Address

Mailing Name 1 IRETON ENNES &
 Mailing Name 2 KINNEY PATRICIA
 Address 1 306 WAYNOKA DR
 Address 2
 Address 3 SARDINIA OH 45171
 Mortgage Company
 Mortgage Company Name

Legal

Legal Desc 1
 Legal Desc 2
 Legal Desc 3

Taxes Charged

Tax Roll	Delq Taxes	1ST Taxes	2ND Taxes	Total Charged
RP_OH	\$0.00	\$865.79	\$865.79	\$1,731.58

Taxes Due

Tax Roll	Delq Taxes	1ST Taxes	2ND Taxes	Total Due
RP_OH	\$0.00	\$0.00	\$865.79	\$865.79

Homestead Credits

Homestead Exemption NO
 Owner Occupancy Credit NO

PARID: 222614H082.**IRETON ENNES & KINNEY PATRICIA****1995 FRANKLIN LAUREL RD**Residential

Stories	1
Construction	BRICK
Style	RANCH (Post 1940)
Square Feet	936
Basement	FULL
Attic	NONE
PCT Complete	
Year Built	1958
Year Remodeled	
Bedrooms	3
Full Baths	1
Half Baths	0
Family Rooms	0
Unfinished Area	
Rec Room	
Finished Basement	
WBFP Stacks	0
Fireplace Openings	0
Prefab Fireplace	
Heat System	CENTRAL A/C

PARID: 222614H082.**IRETON ENNES & KINNEY PATRICIA****1995 FRANKLIN LAUREL RD**

Other Building and Yard Improvements

Code	Description	Year Built	Effective Year	Condition	Width	Length	Area	Units	Make	Model
RS1	SHED (ALL)	2016		AVERAGE	8	22	176	1		
RG1	DET GARAGE	1950		AVERAGE	24	24	576	1		

PARID: 222614H082.**IRETON ENNES & KINNEY PATRICIA****1995 FRANKLIN LAUREL RD**Appraised Value 2021 (100%)

Land Value	\$36,600
Building Value	\$65,800
Total Value	\$102,400
CAUV	\$0

Assessed Value 2021 (35%)

Land Value	\$12,810
Building Value	\$23,030
Total Value	\$35,840
CAUV	\$0

PARID: 222614H082.

IRETON ENNES & KINNEY PATRICIA

1995 FRANKLIN LAUREL RD

Tax Summary

Rolltype	Effective Year	Project	Cycle	Original Charge	Adjustments	Payments	Total
RP_OH	2021		1	\$865.79	\$.00	-\$865.79	\$.00
RP_OH	2021		2	\$865.79	\$.00	\$.00	\$865.79
Total:				\$1,731.58	\$.00	-\$865.79	\$865.79

Full Year Charges as of Duplicate

Original Charge	\$2,653.96
Reduction	-\$792.90
Adjusted Charge	\$1,861.06
Non Business Credit	-\$129.48
Homestead Exemption	\$.00
Owner Occupancy Credit	\$.00
Farm Recoupment	\$.00
Total Full Year Real Estate Only	\$1,731.58
Special Assessment	\$.00
Total Full Year Current Charges	\$1,731.58

1st Half Current Charges (includes adjustments)

Original Charge	\$1,326.98
Reduction	-\$396.45
Adjusted Charge	\$930.53
Non Business Credit	-\$64.74
Homestead Exemption	\$.00
Owner Occupancy Credit	\$.00
Penalty	\$.00
Farm Recoupment	\$.00
Total 1st Half Real Estate Only	\$865.79
Special Assessment	\$.00
Total 1st Half Current Charges	\$865.79

2nd Half Current Charges (includes adjustments)

Original Charge	\$1,326.98
Reduction	-\$396.45
Adjusted Charge	\$930.53
Non Business Credit	-\$64.74
Homestead Exemption	\$.00
Owner Occupancy Credit	\$.00
Penalty	\$.00
Farm Recoupment	\$.00
Total 2nd Half Real Estate Only	\$865.79
Special Assessment	\$.00
Total 2nd Half Current Charges	\$865.79

Delinquent Charges

Original Delinquent	\$.00
Original Interest	\$.00
Total Original Delinquent Real Estate	\$.00

Only	
Special Assessment Delq	\$.00
Special Assessment Interest	\$.00
Total Original Delinquent	\$.00
Current Delinquent	\$.00
Current Interest	\$.00
Total Current Delinquent Real Estate	\$.00
Only	
Special Assessment Delq+int	\$.00
Total Current Delinquent	\$.00

PARID: 222614H082.

IRETON ENNES & KINNEY PATRICIA

1995 FRANKLIN LAUREL RD

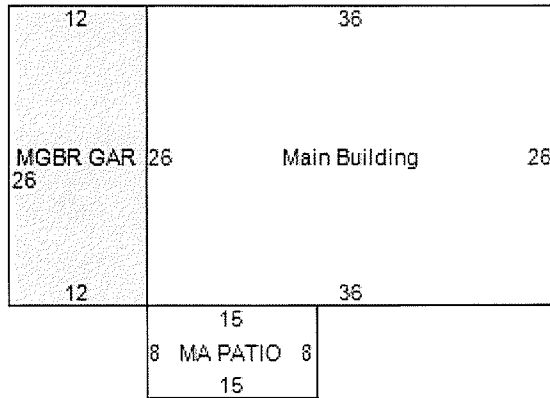

Item	Area
Main Building	936
- FRAME OR CONCRETE BLOCK DETACHED GARAGE	576
MGBR GAR - 23:MG/BG MASONRY/BRICK GARAGE	312
- FRAME UTILITY SHED	176
MA PATIO - 33:MA_PT CONC/MAS PATIO	120

Printed on Wednesday, April 13, 2022, at 10:19:45 AM EST



KRUSLING
CLECTIA
2226 04 4009

STROUB
DAVID B
2226 60 4A022

STROUB
DAVID B
2226 04 8023

SCHAEFER
DAVID W
2226 14 4A002

BARGER NANCY
B CAROLL
2226 14 8003

BOARD OF
EDUCATION
2226 14 8060

BOARD OF
EDUCATION OF
2226 14 8074

SCHMOGROW
ALAYNE
2226 14 6083

RITTER HOLZ
SEYMOUR
2226 60 4C037

GILES JAMES H
B JENNIFER K
2226 60 4C027

JACSON
STEPHEN B
2226 14 6080

YOUNG EDWARD
B ZORA
2226 14 H016

DOHERTY
BRENDA
SUE ETAL
2226 14 H031

HOLCK JOHN
2226 14 C015

LOCKEY
JAMES B
2226 14 A084

YOUNG EDWARD
2226 14 H080

TRETON ENNIS
2226 14 H025

WILDEY
KEVIN B
2226 14 C814

LOCKEY
JAMES E
2226 12 C115

LOCKEY
JAMES E B
2226 14 H021

KINNEY
PATRICIA
2226 14 6020

BIG C
PATRICIA
2226 14 6022

REITERMAN MICHAEL
B CHRISTIE L
2226 12 C135

LOCKEY
JAMES E B
2226 12 C026



Linda L. Fraley
County Auditor

222614H082



4/13/2022

This information contained in this map is a public resource. If you have any information or are provided for use with a public resource, it is provided for your information only. It is not intended to be used for any other purpose. The accuracy of the information contained in this map is not guaranteed.