

# Pickaway County, Ohio - Property Record Card

## Parcel: B0600010010600 Card: 1

**Owner** SUNSET MOBILE HOME PARK LLC  
**Address** 13693 U S 62  
**Land Use** (430) C - RESTURANT, CAFETERIA, AND/OR BAR  
**Class** COMMERCIAL  
**Legal Description** SUR-9437

### MAP



### SKETCH

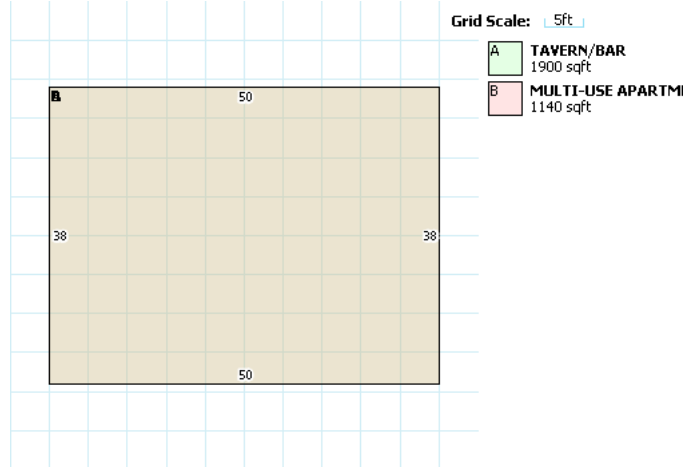

### COMMERCIAL

**Improvement Name** POINT INN BAR  
**Description**  
**Year Built** 1950  
**Number of Units**  
**Identical Units** 1  
**Building Number** 1  
**Card** 1

### COMMERCIAL FEATURES

Code	Description	+/-	Measurements
RG1			10 x 50

### LAND

Code	Frontage	Depth	Acreage	SqFt	Value
6	0	0	3	N/A	\$108,000.
9	0	0	0.42	N/A	\$0.00

### VALUATION

	Appraised	Assessed
Land Value	\$108,000.00	\$37,800.00
Building Value	\$39,520.00	\$13,830.00
<b>Total Value</b>	<b>\$147,520.00</b>	<b>\$51,630.00</b>
CAUV Value		\$0.00
<b>Taxable Value</b>		<b>\$51,630.00</b>

### PERMITS

### IMPROVEMENTS

### SALES

Date	Buyer	Seller	Price	Validity
6/16/2005	SUNSET MOBILE HOME PARK LLC		\$50,175.00	03 MULTIPCL NOT
11/27/1991	TAYNOR EDMOND E	TAYNOR EVERETT	\$0.00	4 RELATED

# Pickaway County, Ohio - Property Record Card

## Parcel: B0600010010600 Card: 2

**Owner** SUNSET MOBILE HOME PARK LLC  
**Address** 13693 U S 62  
**Land Use** (430) C - RESTURANT, CAFETERIA, AND/OR BAR  
**Class** COMMERCIAL  
**Legal Description** SUR-9437

### MAP



### SKETCH

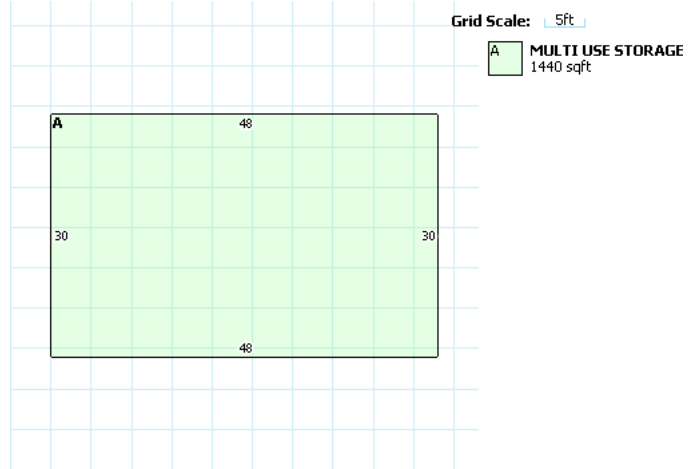

### COMMERCIAL

**Improvement Name** STORAGE  
**Description**  
**Year Built** 1950  
**Number of Units**  
**Identical Units** 1  
**Building Number** 2  
**Card** 2

### COMMERCIAL FEATURES

### LAND

Code	Frontage	Depth	Acreage	SqFt	Value
6	0	0	3	N/A	\$108,000.
9	0	0	0.42	N/A	\$0.00

### VALUATION

	Appraised	Assessed
Land Value	\$108,000.00	\$37,800.00
Building Value	\$39,520.00	\$13,830.00
<b>Total Value</b>	<b>\$147,520.00</b>	<b>\$51,630.00</b>
CAUV Value		\$0.00
<b>Taxable Value</b>		<b>\$51,630.00</b>

### PERMITS

### IMPROVEMENTS

### SALES

Date	Buyer	Seller	Price	Validity
6/16/2005	SUNSET MOBILE HOME PARK LLC		\$50,175.00	03 MULTIPCL NOT
11/27/1991	TAYNOR EDMOND E	TAYNOR EVERETT	\$0.00	4 RELATED

# Pickaway County, Ohio - Property Record Card

## Parcel: B0600010010700 Card: 1

**Owner** SUNSET MOBILE HOME PARK LLC  
**Address** 0 U S 62  
**Land Use** (415) C - TRAILER OR MOBILE HOME PARK  
**Class** COMMERCIAL  
**Legal Description** SUR 10772

### MAP



### SKETCH

A sketch is unavailable for this parcel.

### COMMERCIAL

### COMMERCIAL FEATURES

### LAND

Code	Frontage	Depth	Acreage	SqFt	Value
6	0	0	1	N/A	\$36,000.0

### VALUATION

	Appraised	Assessed
Land Value	\$36,000.00	\$12,600.00
Building Value	\$19,440.00	\$6,800.00
Total Value	\$55,440.00	\$19,400.00
CAUV Value		\$0.00
Taxable Value		\$19,400.00

### PERMITS

### IMPROVEMENTS

Card	Description	Year Built	Dimensions	Value
1	MH5 - MOBILE	1950	0x0	\$19,440.00

### SALES

Date	Buyer	Seller	Price	Validity
6/16/2005	SUNSET MOBILE HOME PARK LLC		\$50,175.00	03 MULTIPCL NOT
11/27/1991	TAYNOR EDMOND E	TAYNOR EVERETT	\$0.00	4 RELATED

# Pickaway County, Ohio - Property Record Card

## Parcel: B0600030001400 Card: 1

**Owner** HILL KATHY A  
**Address** 13781 U S 62  
**Land Use** (511) R - SINGLE FAMILY, O-9.999 AC  
**Class** RESIDENTIAL  
**Legal Description** SUR 10772

### MAP



### SKETCH

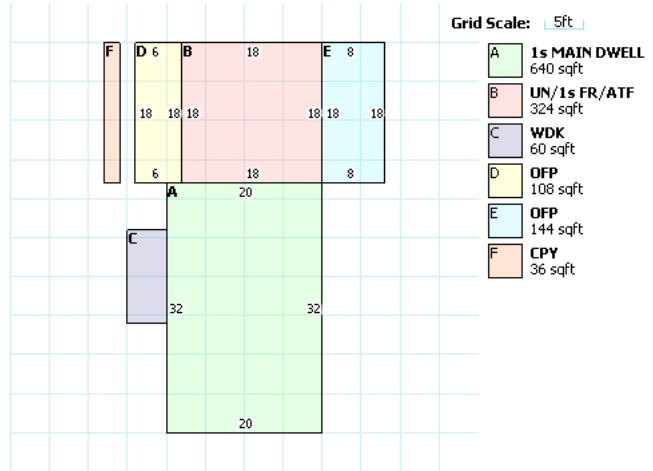

### RESIDENTIAL

Building Style	RANCH	FullBaths	1
Sq.Ft.	1094	Half Baths	0
Year Built	1983	Basement	NONE
Stories	1	Basement Area	0
Exterial Wall	FRAME	Rec Room Area	0
Rooms	5	Heat Fuel Type	GAS
Bedrooms	2	Heat/Cool	CENTRAL AIR CONDITION
Family Rooms	1	Attic	NONE
Fireplace Openings(Stacks)	0(0)	Trim	0

### LAND

Code	Frontage	Depth	Acreage	SqFt	Value
1	0	0	0.539	N/A	\$20,480.0

### VALUATION

	Appraised	Assessed
Land Value	\$20,480.00	\$7,170.00
Building Value	\$43,600.00	\$15,260.00
Total Value	\$64,080.00	\$22,430.00
CAUV Value	\$0.00	
Taxable Value	\$22,430.00	

### PERMITS

### IMPROVEMENTS

Card	Description	Year Built	Dimensions	Value
1	AP3 - ONE SIDE	1992	24x32	\$2,190.00

### SALES

Date	Buyer	Seller	Price	Validity
7/15/2016	HILL KATHY A	HILL KATHY A	\$0.00	4 RELATED
2/22/2011	HILL KATHY A	CONLEY TONY	\$66,900.00	0 VALID