

Summary

Parcel Number 148-20-02-058.00
Account Number 8045
Location E MAIN ST 1303
Address Description EAST MAIN ST LT 134
(Note: Not to be used on legal documents)
Class Residential
Tax District 02 Greenup City Ambulance
Rate Per Thousand 15.0500



[View Map](#)

Owner

Primary Owner
 HALL CARL ROBERT & PATRICIA
 1801 EAST MAIN ST
 GREENUP, KY 41144-1214

Land Characteristics

Condition	Average	Topography	Level
Plat Book/Page		Drainage	
Subdivision		Flood Hazard	None
Lot		Zoning	
Block		Electric	Yes
Acres	0.19	Water	Yes
Front	115	Gas	Yes
Depth	75	Sewer	Yes
Lot Size	115x75	Road	Secondary
Lot Sq Ft	0	Sidewalks	No
Shape		Information Source	

Valuation

	2020 Working	2019 Certified	2018 Certified	2017 Certified	2016 Certified	2015 Certified
+ Land Value	\$10,000	\$10,000	\$10,000	\$10,000	\$10,000	\$10,000
+ Improvement Value	\$65,000	\$65,000	\$65,000	\$65,000	\$65,000	\$65,000
+ Ag Improvement Value	\$0	\$0	\$0	\$0	\$0	\$0
= Total Taxable Value	\$75,000	\$75,000	\$75,000	\$75,000	\$75,000	\$75,000
- Exemption Value	\$0	\$0	(\$37,600)	(\$37,600)	(\$36,900)	(\$36,900)
= Net Taxable Value	\$75,000	\$75,000	\$37,400	\$37,400	\$38,100	\$38,100
+ Land FCV	\$0	\$0	\$0	\$0	\$0	\$0
+ Improvement FCV	\$0	\$0	\$0	\$0	\$0	\$0
+ Ag Improvement FCV	\$0	\$0	\$0	\$0	\$0	\$0
= Total FCV	\$0	\$0	\$0	\$0	\$0	\$0
Exemption			HX	HX	HX	HX
Farm Acres	0.00	0.00	0.00	0.00	0.00	0.00
Fire Protection Acres	0.00	0.00	0.00	0.00	0.00	0.00

Taxes

	2019	2018	2017	2016	2015	2014
Tax	\$1,177.23	\$589.25	\$583.96	\$577.65	\$573.40	\$581.41

Improvement Information

Building Number	1	Kitchens	1
Description	RES & GET GARAGE	Dining Rooms	0
Residence Type	Single Family	Living Rooms	0
Comm Type		Family Rooms	1
Mobile Home Type		Bedrooms	3
Year Built	1900	Full Baths	2
Effective Age	0	Half Baths	0
Ave. Wall Height	0	Other Rooms	0
Structure	2 Story	Total Rooms	0
Number of Stories	0	Living Sq Ft	2,168
Exterior	Aluminum	Fireplaces/Water	1/1
Foundation	Concrete Block	Supplemental Heat	
Construction Type	Wood Frame	Mobile Home Model	
Construction Quality	Average/Standard	Mobile Home Manufacturer	
Building Condition	Good/Average	MH Skirt Foundation	
Roof Type	Gable	Heat	Yes
Roof Cover	Comp.Shingles	Heat Source	Natural Gas
Roof Pitch		Heat Type	Forced Air
Basement Type	None	Air Conditioning	Yes
Basement Finish		AC/Type	Central
Basement Size		Special Improvements	No
Basement Sq Ft	0	Fire Alarm	No
Garage/Carport	Garage	Sprinklers	No
Garage Size	1 Car	Porch/Deck	Other
Garage Type	Detached	Porch Sq Ft	160
Garage Exterior	Brick/Stone	Deck Sq Ft	204
Width	0	Concrete Sq Ft	0
Length	0	Farm Bldg Type	
Garage Sq Ft	720	Value	\$0.00
Pool		Driveway	
Pool Size	0	Fence	0
Tennis Courts			

Sale Information

Sale Date ⬇	Sale Price ⬇	Sale Type ⬇	Book-Page ⬇	Grantee ⬇	Grantor ⬇
11/1/1997	\$75,000	Construction/Destruction	455-173	HALL CARL ROBERT & PATRICIA	ELSWICK JEFFREY D & VICKIE

Photos



Sketches

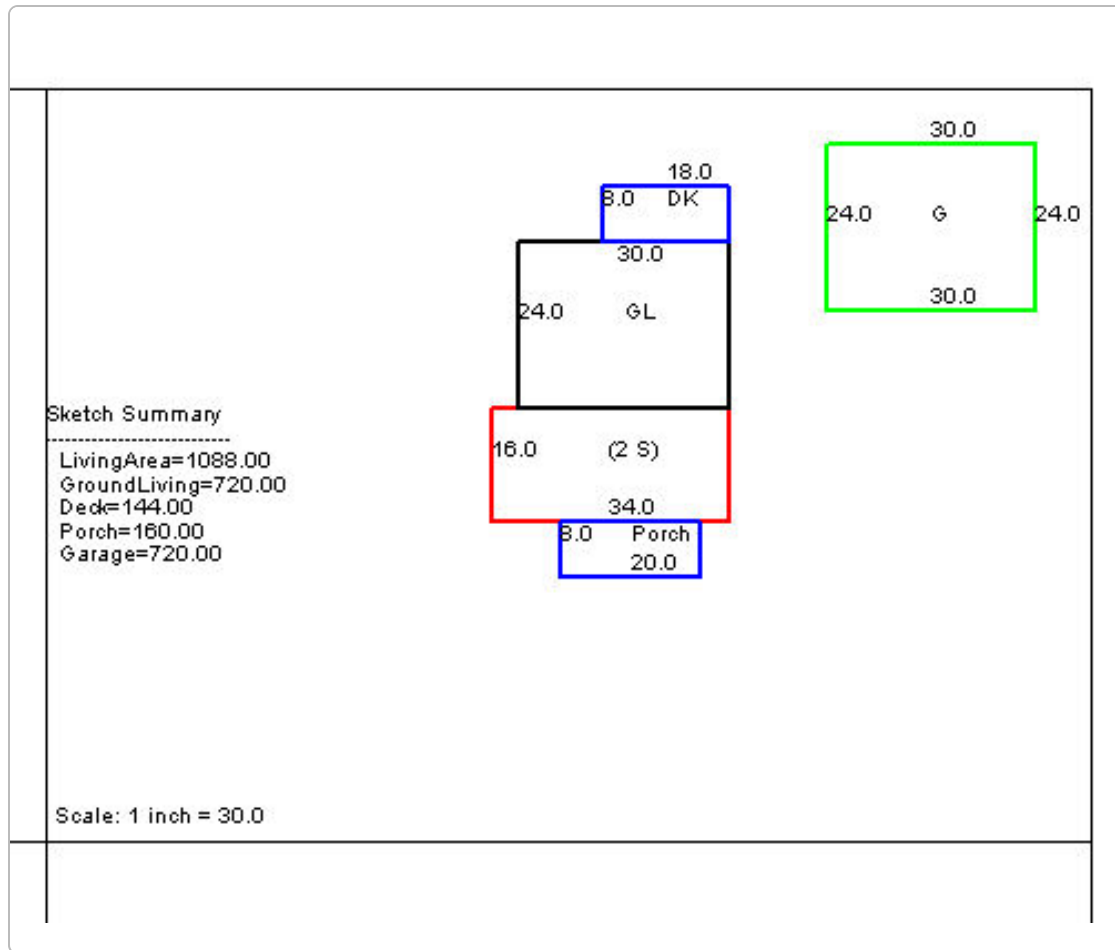

Greenup County makes every effort to produce the most accurate information possible. No warranties, expressed or implied, are provided for the data herein, its use or interpretation. The assessment information is from the last certified taxroll. All data is subject to change before the next certified taxroll.

[User Privacy Policy](#)
[GDPR Privacy Notice](#)

Last Data Upload: 8/21/2020, 12:07:50 PM

Version 2.3.79

Developed by

 Schneider
 GEOSPATIAL