

**Owner** JENNINGS JAMES A & CAROL R  
**Address** 1439 LANDER RD  
MAYFIELD HEIGHTS, OH. 44124  
**Land Use** (5100) R - 1-FAMILY PLATTED LOT  
**Legal Description** 19 MAYPK 0110 ALL  
**Neighborhood Code** 13401

**SKETCH**

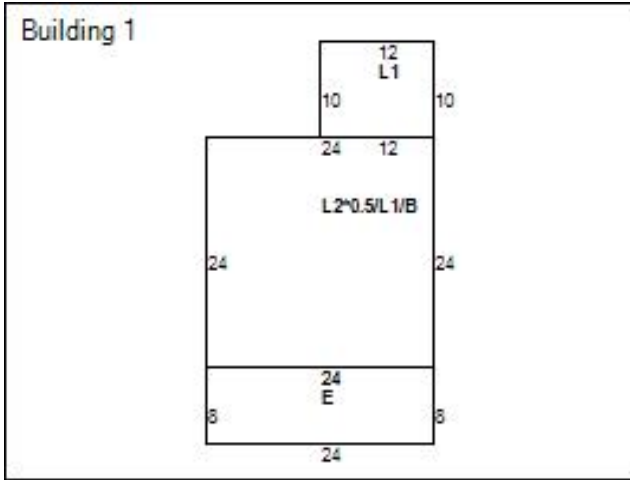

**MAP VIEW**



**BUILDING INFORMATION**

Building Record Number	1	Occupancy	1-FAMILY	Story Height	1.5
Style	CAPE COD	Year Built	1894	Exterior Walls	ALUM/VINYL
Condition	AVERAGE	Construction Quality	C+ / AVERAGE+	Roof Type	GABLE
Roof Material	ASPH-SHINGLE	Heat Type	FORCED-AIR	Air Conditioning	NONE
Attic Type	NONE	Basement Type	BASEMENT	Basement Square Feet	576
Basement Finished	No	Rooms	5	Bedrooms	3
Bathrooms (Full/Half)	1/0	Garage Type	NONE	Garage Capacity	
Year Garage Built		Garage Size		Living Area Basement	
Living Area 1	696	Living Area 2	288	Living Area Upper	
Living Area Total	984	Floor Location		Party Wall	

**LAND**

Code	Frontage	Depth	Acreage	Sq Ft
PRM	45	186	0.19	8,370

**VALUATION**

2019 Values	Taxable Market Value	Exempt Market Value	Abated Market Value	Assessed Taxable Value
Land Value	\$26,400	\$0	\$0	\$9,240
Building Value	\$77,100	\$0	\$0	\$26,990
Total Value	\$103,500	\$0	\$0	\$36,230
Land Use	5100			SINGLE FAMILY DWELLING

**PERMITS**

Tax Year	Reason	Tax Change	Exempt Change	Percent Complete	Reinspect	Notes
----------	--------	------------	---------------	------------------	-----------	-------

**IMPROVEMENTS**

Type	Description	Size	Height Depth
------	-------------	------	--------------

**SALES**

Date	Buyer	Seller	Price
1/1/1975	Jennings James A & Carol R		\$0

**Taxes**

2019 Taxes	Charges	Payments	Balance Due
Tax Balance Summary	\$4,370.48	\$4,370.48	\$0.00