



# Mike Kovack

Medina County Auditor

## Parcel Information

---

<b>Parcel Number</b>	040-20C-17-054
<b>Owner Name</b>	WEBER DRIVE PROPERTIES LLC
<b>Address</b>	733 WEBER DR
<b>City, State, Zip Code</b>	WADSWORTH, OH 44281
<b>Property Class</b>	340 Property Class Codes
<b>Acreage</b>	2.530000
<b>Legal Description</b>	LOT 6772 WH 2.530A

## Value

---

<b>Land Value</b>	88,250
<b>CAUV Value</b>	0
<b>Building Value</b>	553,190
<b>Total Value</b>	641,440

## Taxable Value

---

<b>Taxable Land Value</b>	30,890
<b>Taxable CAUV Value</b>	0
<b>Taxable Building Value</b>	193,620
<b>Taxable Total Value</b>	224,510

## Building Information

---

<b>Card Number</b>	002
<b>Building Section ID</b>	001
<b>Section Area</b>	12000
<b>Section Story Count</b>	1.00
<b>Wall Height</b>	16
<b>Year Built</b>	1983

Building Information

---

**Card Number** 002  
**Building Section ID** 001  
**HVAC** Forced Air  
**Additional HVAC** Forced Air  
**Sprinklers** None  
**Elevator** None  
**Conventional Canopy Area** 399

Building Information

---

**Card Number** 002  
**Building Section ID** 002  
**Section Area** 1800  
**Section Story Count** 1.00  
**Wall Height** 10  
**Year Built** 1983

Building Information

---

**Card Number** 002  
**Building Section ID** 002  
**HVAC** Warmed & Cooled Air  
**Additional HVAC** Warmed & Cooled Air  
**Sprinklers** None  
**Elevator** None

Building Information

---

**Card Number** 003  
**Building Section ID** 001  
**Section Area** 4560  
**Section Story Count** 1.00  
**Wall Height** 16  
**Year Built** 1995

Building Information

<b>Card Number</b>	003
<b>Building Section ID</b>	001
<b>HVAC</b>	Forced Air
<b>Additional HVAC</b>	Forced Air
<b>Sprinklers</b>	None
<b>Elevator</b>	None

**Building Sketch - Card Number 002**

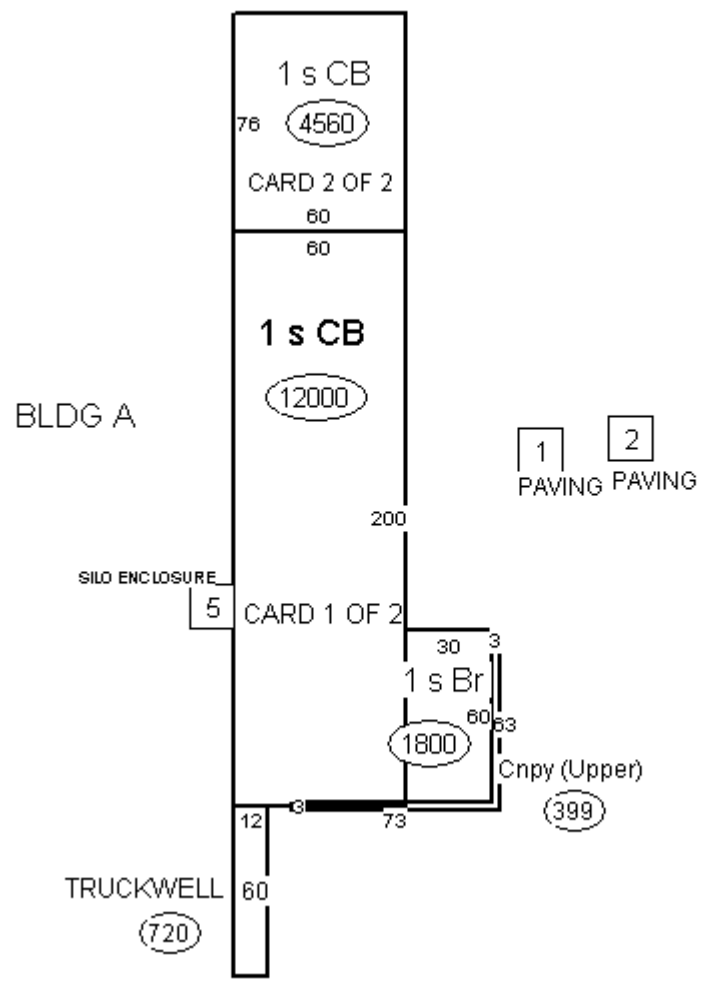

**Building Sketch - Card Number 003**

CARD 2 OF 2

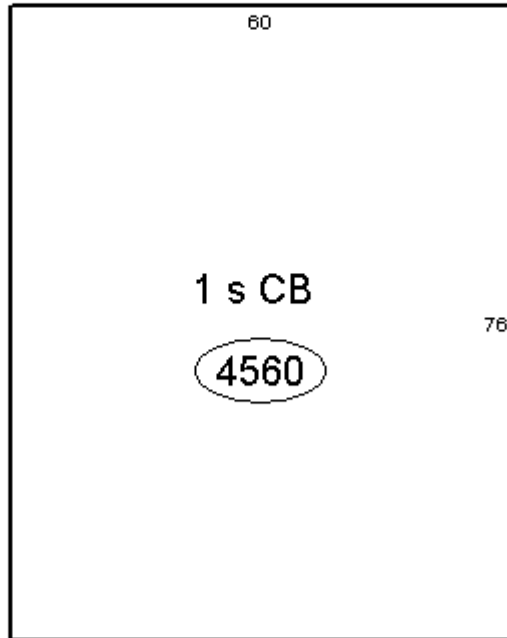

#### Other Improvements

Card Number	Key	Improvement	Width	Length	Area	Year Built
002	01	Paving - Concrete	0	0	13200	1983
002	02	Paving - Concrete	0	0	11900	1998
002	04	Truck Well	12	60	720	1983
002	05	Residential Shed - Small Util	10	21	210	1983