

### Summary

**Parcel Number** 0270603109000  
**Location Address** 30 E RALEIGH AVE  
 MANSFIELD OH 44907  
**Legal Description** OL 194 N PT E 60 FT OF W 226.5 60 X 101.39  
 (Note: Not to be used on legal documents.)  
**Property Class** R - RESIDENTIAL  
**Land Use** (510) R - SINGLE FAMILY DWELLING, PLATTED LOT  
**Neighborhood** 02706004  
**Tax District** 02706  
**Acres** 0  
**Sec/Twp/Rng** --  
**Township** MANSFIELD  
**School District** MANSFIELD CITY SD  
**Municipality** MANSFIELD  
**Topo** LEVEL  
**Utilities** ALL PUBLIC  
**Roads** PAVED  
**Traffic** LIGHT



027-06-031-09-000 05/03/2016

[View Map](#)

### Owners

**Owner**  
 MIDWEST HOME MANAGEMENT LLC A FLORIDA  
 LIMITED LIABILITY COMPANY  
**Mailing Address**  
 MIDWEEST HOME MANAGEMENT LLC  
 205 E CENTRAL BLVD STE 600  
 ORLANDO FL 32801

**Treasurer Code** FORECLOSURE FEE

### Valuation

Assessed Year	2019	2018
Land Value	\$2,320.00	\$2,320.00
Building Value	\$11,220.00	\$11,220.00
<b>Total Value (Assessed 35%)</b>	<b>\$13,540.00</b>	<b>\$13,540.00</b>
Land Value	\$6,620.00	\$6,620.00
Building Value	\$32,050.00	\$32,050.00
CAUV Value	\$0.00	\$0.00
<b>Total Value (Appraised 100%)</b>	<b>\$38,670.00</b>	<b>\$38,670.00</b>

### Taxes Due

Tax Year (click for detail)	1st Half Due	2nd Half Due	Delinquent	Total Due
<a href="#">2019</a>	\$485.62	\$441.47	\$3,675.64	\$4,602.73
<a href="#">2015</a>	\$0.00	\$0.00	\$0.00	\$0.00
<a href="#">2013</a>	\$0.00	\$0.00	\$0.00	\$0.00
<a href="#">2012</a>	\$0.00	\$0.00	\$0.00	\$0.00
<a href="#">2011</a>	\$0.00	\$0.00	\$0.00	\$0.00
<a href="#">2010</a>	\$0.00	\$0.00	\$0.00	\$0.00
<a href="#">2009</a>	\$0.00	\$0.00	\$0.00	\$0.00

### Land

Descr	P	LN	CD	Acres	Frontage	Depth	Base Size	Base Rate	Sq ft.	Incr / Decr	Land-Val
Regular Lot	F	1	1	0.139	60	101	100.00	120	6,060	60 / 120	6,620

**Total Acres:**  
 0.1391  
**Total Land-Value:**  
 6,620

### Residential Improvement Information

Card	1	Bathroom Remodeled	2
Stories	1	Kitchen Remodeled	2
Exterior Wall	AL/VINYL	Total Rooms	6
Style	RANCH	Bedrooms	3
Square Feet	1056	Full Baths	1
Basement	CRAWL	Half Baths	0
Heating Fuel Type	GAS	Family Rooms	0
Physical Condition		Additional Fixtures	2
Attic	NONE	Total Fixtures	5
Year Built	1953	WBFP Stacks	0
Effective Year	0	Fireplace Openings	0
Year Remodeled	0	Prefab Fireplace	0

### Other Dwelling Features

Card	1	Finished Basement (L x W)	
Masonry Trim (L x W)	24 x 5	Finished Basement Area	0
Masonry Trim Area	120	Finished Basement Value	\$0
Masonry Trim Value	\$1,400	Basement Garage	\$0
Unfin Trim (L x W)		# Cars	0
Unfin Trim Area	0	Misc Desc 1	
Unfin Trim Value	\$0	Note 1	
Rec Room (L x W)		Note 2	
Rec Room Area	0	Condo Level	0
Rec Room Value	\$0	Condo Type	

### Additions

Card 1

Line	Lower	First	Second	Third	Area	Value
0		Main Building			1056	0
1		13 - FR GR FRAME GARAGE			288	5,900
2		35 - STOOP STOOP			504	8,700

### Sales

Date	Book	Page	Grantor	Grantee	Price	Instr Type	Sale Validity	Qualified
2/4/2020			INGERSOLL FINANCIAL MIDWEST LAND TRUST	MIDWEST HOME MANAGEMENT LLC A FLORIDA	\$0	QC	RELATED INDIVIDUALS OR CORPORATIONS	Unqualified
2/2/2017			DMP HOLDINGS LLC A LIMITED LIABILITY	INGERSOLL FINANCIAL MIDWEST LAND TRUST	\$38,960	QC	NOT OPEN MARKET	Unqualified
2/2/2017			HARBOUR PORTFOLIO VI LP	DMP HOLDINGS LLC A LIMITED LIABILITY	\$38,960	QC	VALID SALE	Qualified
10/13/2010			FANNIE MAE AKA FEDERAL NATIONAL	HARBOUR PORTFOLIO VI LP	\$5,719	LD	BANK RESALE	Unqualified
4/29/2010				FANNIE MAE AKA FEDERAL NATIONAL	\$24,000	SD	SHERIFF SALE	Unqualified
6/1/1995			BAKER KENNETH J	FANNIE MAE AKA FEDERAL NATIONAL	\$51,000		VALID SALE	Qualified

### Recent Sales in Area

Sale date range:

From:

To:

**Pay Property Taxes**

Pay Property Tax

**Photos**



027-06-031-09-000 05/03/2016



027-06-031-09-000 04/12/2013

**Sketches**

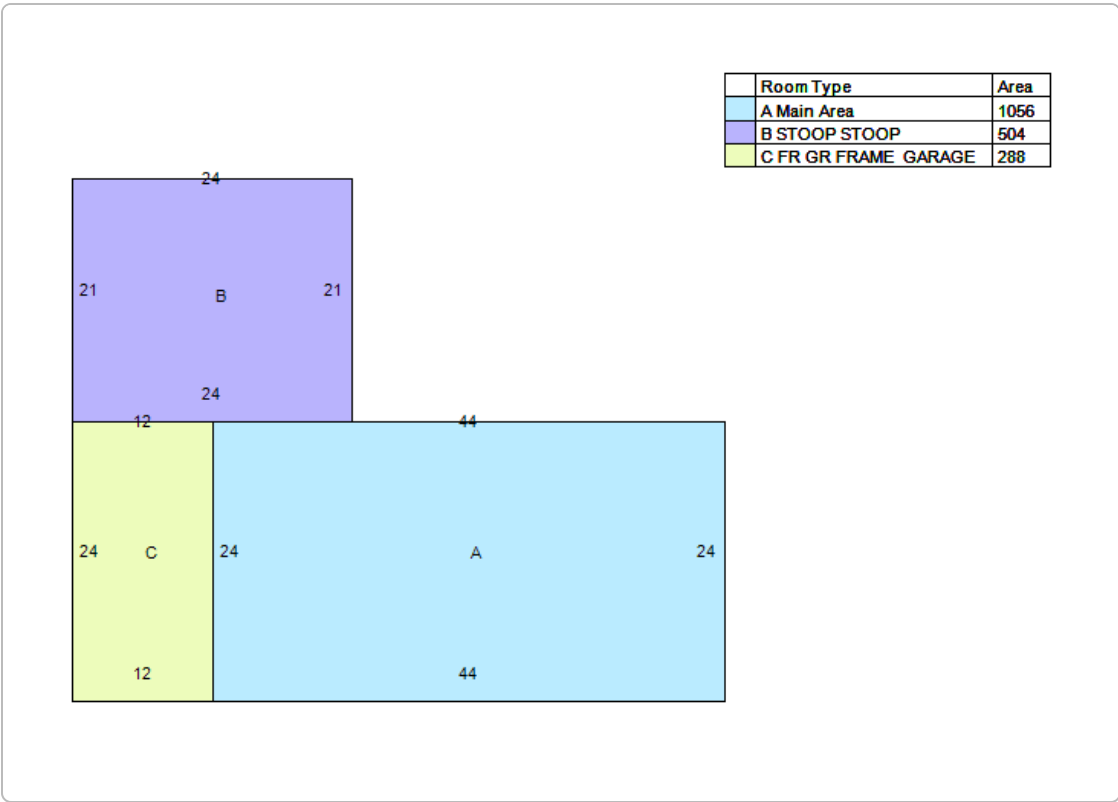

No data available for the following modules: Commercial Improvement Information, Interior/Exterior Information, Other Buildings & Yard Improvements, Other Features, Permits.

The information displayed on this map is taken from public records, and is intended to be used as a reference. Map information is believed to be accurate, but accuracy is not guaranteed. Richland County makes no warranties, express or implied, concerning the accuracy, completeness, or reliability of this information, and assumes no liability or any other legal responsibility for the information contained on this map. The map does not represent the official survey of the land.

[User Privacy Policy](#)  
[GDPR Privacy Notice](#)

Developed by  
 Schneider  
 GEOSPATIAL

Last Data Upload: 5/1/2020, 7:35:03 AM

Version 2.3.57