

Kanawha County Assessor
Full Summary for parcel "17 1401220000000"

Summary

Parcel ID (Account)	17 1401220000000	Legal Description 2	KANAWHA TERRACE 311
Tax Year	2018	Legal Description 3	
Neighborhood	403B	Year Built	1920
District	17 St. Albans Corp	Total Rooms	7
Map	14	Bed Rooms	4
Parcel	122	Full Baths	1
Sub Parcel		Half Baths	
Special Id		Additional Fixtures	3
Tax Class	Class 2	Total Fixtures	6
Land Use	101 Residential 1 Family	Heating	Central A/C
Calculated Acres	0.14	Heating Fuel Type	Gas
Property Class	Residential	Living Area (SF)	1688
Assessed Land	\$ 11,640.00	State	WV
Assessed Building	\$ 45,060.00	City	ST ALBANS
Mineral Value	\$ 0.00	Zip Code	25177
Homestead Value	\$ 0.00	Count	1
Total Assessed Value	\$ 56,700.00	Pricing Method	F
Owner's Name	MARTIN SUSAN L &	Total Acres	0.14
Owner's Mail Address	311 KANAWHA TE	Land Price	\$ 19,440.00
Owner's Mail Address		Last Sale Price	\$ 65,000.00
Location	311 Kanawha Ter	Last Sale Apr	
Deed Book	2566	Sales Ratio	
Location	311 KANAWHA TER	Sale Year	2002
Page	0325	Last Sale Date	12/01/2002
Homestead		Price per SqFt	\$ 38.51
Street Name	KANAWHA	Sales Ratio	0.87
Legal Description 1	LT 45X140 PT BK 59	Appraisal per SqFt	\$ 33.59



Print
Print
this
page
content
only
without
header
or side
menu

Sales Data List

Parcel ID (Account)	Seq	Tax Year	Owner's Name	Last Sale Date	Last Sale Price	Sale Type	Sale Validity	Deed Book	Page
17 1401220000000	0	2018		12/01/2002	\$ 65,000.00	Land & Buildings	Open Market / Valid Sale		
17 1401220000000	0	2018		10/01/1990	\$ 25,000.00	Land & Buildings	Not Open Market		
17 1401220000000	0	2018		03/01/1994	\$ 19,000.00	Land & Buildings	Liquidation / Foreclosure		

Search criteria: 'Parcel ID (Account)='17 1401220000000', 'Tax Year'='2018'



Sketch of District 17, Map 14, Parcel 122 for the Tax Year 2018

Back

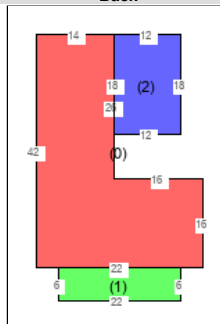

Front

Addition List

Line #	Lower	First	Second	Third	Area
0					844
1		OPF (Open Fram Porch)			132
2		Wood Deck			216
3					