

Seneca County, Ohio - Property Record Card

Parcel: C13000145040100 Card: 1

Owner ZIEGLER DEAN M & DIANE E
Address 6655 S TR 173
Land Use (511) R - SINGLE FAMILY, O-9.99 AC
Class RESIDENTIAL
Legal Description PT N1/2 SW1/4
Range Township Section 0-0-21

MAP



SKETCH

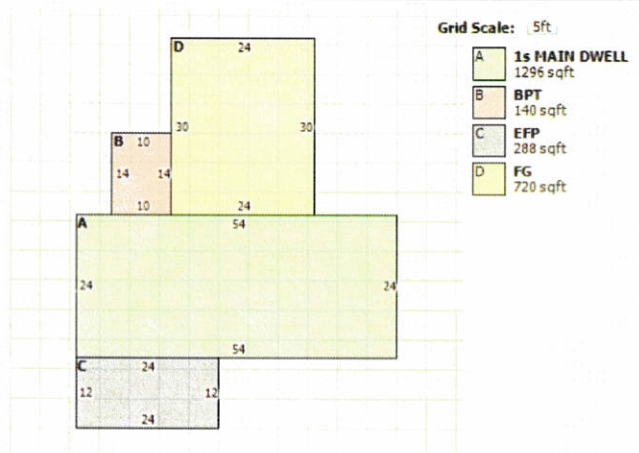

RESIDENTIAL

Building Style	RANCH	FullBaths	1
Sq.Ft.	1296	Half Baths	1
Year Built	1975	Basement	CRAWL
Stories	1	Basement Area	0
Exterior Wall	ALUMINUM/VINYL	Rec Room Area	0
Rooms	6	Heat Fuel Type	GAS
Bedrooms	3	Heat/Cool	CENTRAL AIR CONDITION
Family Rooms	0	Attic	NONE
Fireplace Openings(Stacks)	0(0)	Trim	0

LAND

Code	Frontage	Depth	Acreage	SqFt	Value
1	0	0	0.81	N/A	\$19,120.00

VALUATION

	Appraised	Assessed
Land Value	\$19,120.00	\$6,690.00
Building Value	\$78,350.00	\$27,420.00
Total Value	\$97,470.00	\$34,110.00
CAUV Value	\$0.00	
Taxable Value	\$34,110.00	

PERMITS

Number	Date	Purpose	Amount
7676	25-JAN-99	POLE BARN	
6702	14-MAR-95	12X24 POR	
0004989	01-JAN-88	24X30 ADD	

IMPROVEMENTS

Card	Description	Year Built	Dimensions	Value
1	AP1 - FOUR SIDE	1999	40x48	\$13,450.00
1	AS2 - CONCRETE	1965	20x50	\$760.00

SALES