

Seneca County, Ohio - Property Record Card

Parcel: L41000657040201 Card: 1

Owner BENNER JAMES R
Address 601 N SR 18
Land Use (111) A - CASH GRAIN OR GENERAL FARM
Class AGRICULTURAL
Legal Description PT SE1/4 NW1/4
Range Township Section 00-00-15

MAP



SKETCH

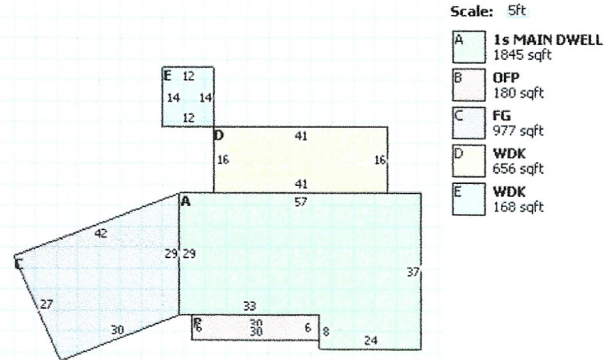

RESIDENTIAL

Building Style	RANCH	FullBaths	1
Sq.Ft.	1845	Half Baths	1
Year Built	1988	Basement	FULL
Stories	1	Basement Area	0
Exterial Wall	ALUMINUM/VINYL	Rec Room Area	0
Rooms	6	Heat Fuel Type	GAS
Bedrooms	3	Heat/Cool	CENTRAL AIR CONDITION
Family Rooms	0	Attic	NONE
Fireplace Openings(Stacks)	0(0)	Trim	520

LAND

Code	Frontage	Depth	Acreage	SqFt	Value
1	0	0	1	N/A	\$18,000.00
2	0	0	4.664	N/A	\$23,320.00
4	0	0	11.337	N/A	\$51,020.00
9	0	0	0.679	N/A	\$0.00
6	0	0	1	N/A	\$18,000.00

VALUATION

	Appraised	Assessed
Land Value	\$110,340.00	\$38,620.00
Building Value	\$171,240.00	\$59,930.00
Total Value	\$281,580.00	\$98,550.00
CAUV Value	\$37,240.00	
Taxable Value	\$72,960.00	

PERMITS

Number	Date	Purpose	Amount
7766	08-DEC-98	NC	
0004845	01-JUN-88	DWELLING	

IMPROVEMENTS

Card	Description	Year Built	Dimensions	Value
1	RG1 - FRAME OR CB	1989	32x64	\$14,110.00
1	RG1 - FRAME OR CB	1995	36x36	\$8,080.00
1	RG1 - FRAME OR CB	1997	38x64	\$16,350.00
1	AP2 - FOUR SIDE	1995	12x18	\$1,200.00
1	RC2 - CANOPY	1989	12x32	\$470.00
1	RC2 - CANOPY	1997	10x36	\$560.00

SALES

Date	Buyer	Seller	Price	Validity
5/21/1999	BENNER JAMES R	BENNER JAMES R	\$0.00	4 RELATED INDIV
12/19/1994	BENNER JAMES R	BENNER JAMES R	\$0.00	4 RELATED INDIV
6/1/1988			\$5,400.00	3 CHANGED AFTER