



DAYTON

RIVERSIDE

33

10
13.3170
ACROSS
E FOR ACREAGE

Huberville Ave

Pleasant St

Wake Ave

Springfield St

53
(2.000)
1.679

54
53231

1528 8

1518 10

1531 40

1530 43

1526 43

1522 43

1520 47

1514 47

1527 21

1523 20

1519 19

1515 18

1522 29

1518 29

1514 28

1519 32

1515 33

5401 31

5405 32

5409 33

17
0.477

16
(1.085)
0.580

346.19'

339.96'

226.7'

20.67'

350.82'

Unnamed Priv
Unnamed Priv

10

447.00' 0.490

11

5509

50 50

48 49

5421

5417

5409

5405

5401

5417

5421

5421

5421

5421

5421

11 - Map

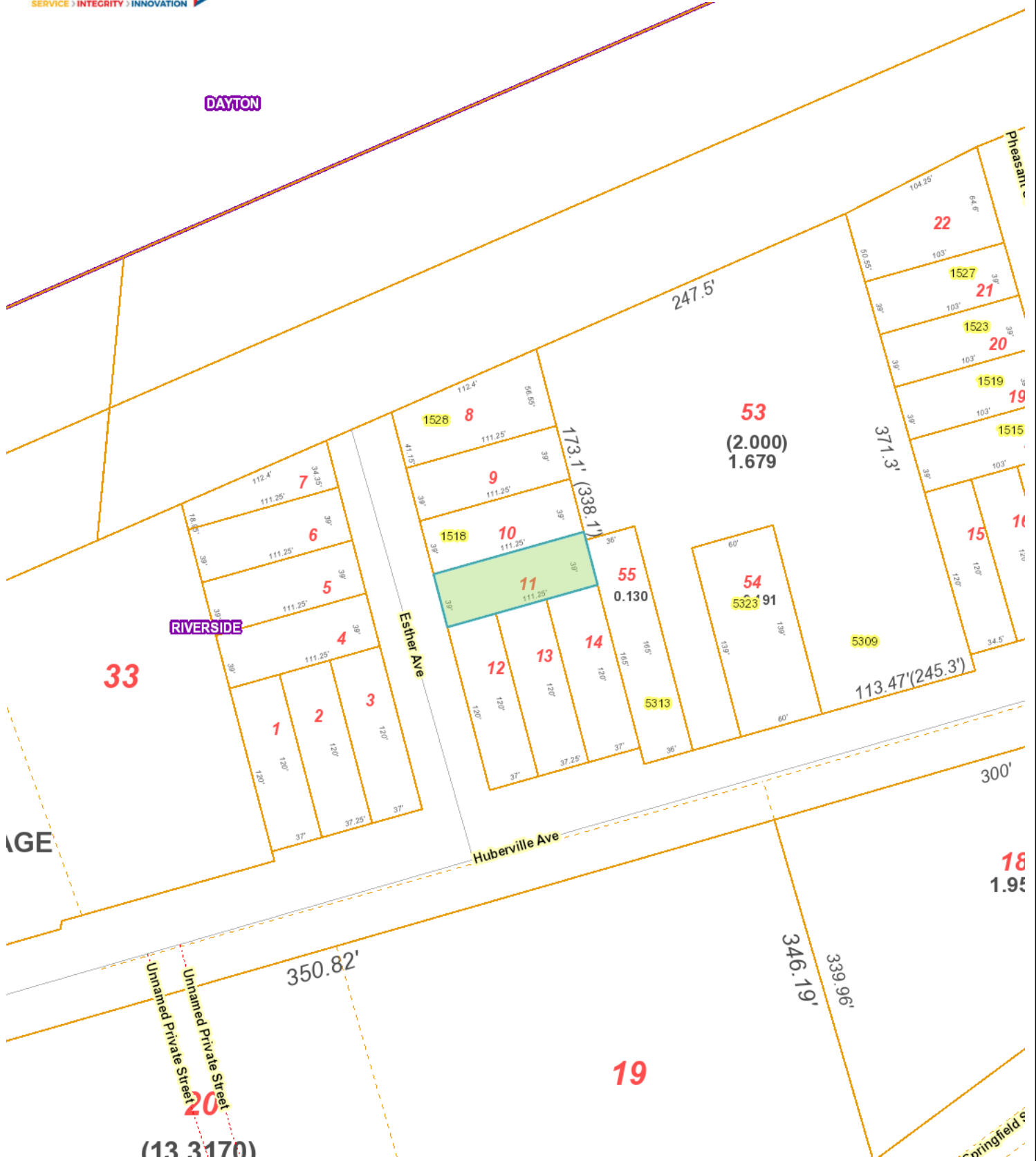

DISCLAIMER:
 This map is a visual presentation of data to be used as a public resource of general information and is provided strictly as a courtesy. The Montgomery County Auditors Office makes no warranty, representation, or guaranty as to the content, accuracy, timeliness, or completeness of any information provided herein.

- Furthermore The Montgomery County Auditors Office shall assume no liability for:
1. Any errors, omissions, or inaccuracies in the information provided regardless of how caused; or
 2. Any decision made or action taken or not taken by the reader in reliance upon any information furnished hereunder.

Note: Exact property boundaries must be derived by a legal survey of the property.

100 ft

GIS DEPARTMENT



14 - Map

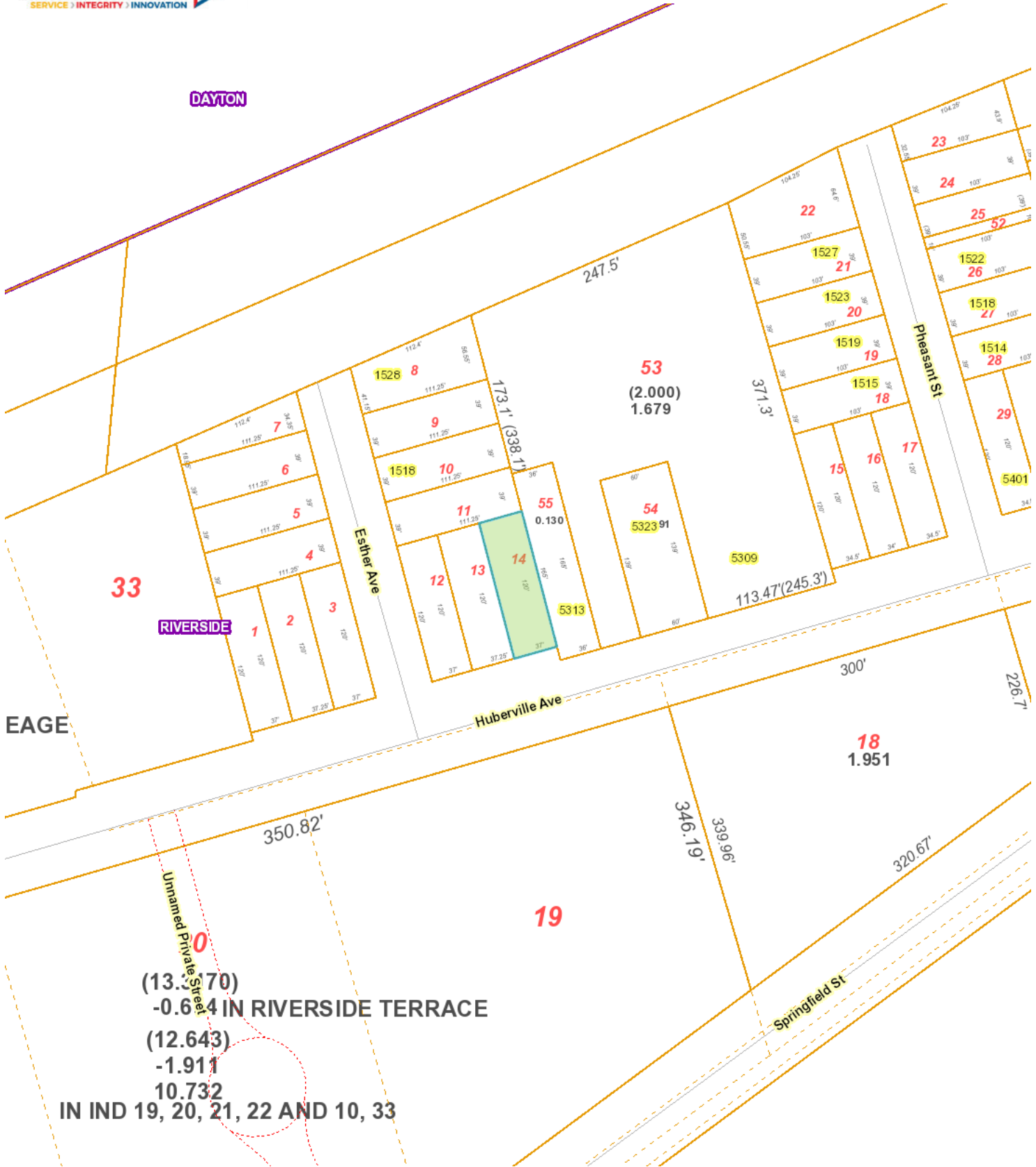

DAYTON

RIVERSIDE

EAGE

0
 (13.3170)
 -0.64 IN RIVERSIDE TERRACE
 (12.643)
 -1.911
 10.732
 IN IND 19, 20, 21, 22 AND 10, 33

DISCLAIMER:
 This map is a visual presentation of data to be used as a public resource of general information and is provided strictly as a courtesy. The Montgomery County Auditors Office makes no warranty, representation, or guaranty as to the content, accuracy, timeliness, or completeness of any information provided herein. Furthermore The Montgomery County Auditors Office shall assume no liability for:
 1. Any errors, omissions, or inaccuracies in the information provided regardless of how caused; or
 2. Any decision made or action taken or not taken by the reader in reliance upon any information furnished hereunder.

Note: Exact property boundaries must be derived by a legal survey of the property.

121 ft



GIS DEPARTMENT

PARID: I39 00107 0053
PARCEL LOCATION: 5309 HUBERVILLE AVE

NBHD CODE: 34000000

[Click here to view neighborhood map](#)

Owner

Name

LYNNE LEIGH PROPERTIES LLC

Mailing

Name	LYNNE LEIGH PROPERTIES LLC
Mailing Address	5165 MAD RIVER
City, State, Zip	DAYTON, OH 45429 241

Legal

Legal Description	7-2-18
Land Use Description	R - SINGLE FAMILY DWELLING, PLATTED LOT
Acres	1.672
Deed	1999-00017D001
Tax District Name	RIVERSIDE CORP-MAD RIVER LSD

Sales

Date	Sale Price	Deed Reference	Seller	Buyer
02-MAR-99	\$100,000		PATTEN LOREN II	FRITZSCHE JACK AND BARBARA
16-MAR-17		201700016689	FRITZSCHE JACK AND BARBARA	LYNNE LEIGH PROPERTIES LLC

Board of Revision

Tax Year	Case Number:	BTA/CPC	Result
2016	1115		No Change in Value

Values

	35%	100%
Land	11,690	33,400
Improvements	8,270	23,620
CAUV	0	0
Total	19,960	57,020

Building

Exterior Wall Material	FRAME
Building Style	OLD STYLE
Number of Stories	2
Year Built	1923
Total Rms/Bedrms/Baths/Half Baths	5/3/1/0
Square Feet of Living Area	1,888
Finished Basemt Living Area (Sq. Ft.)	0
Rec Room (Sq. Ft.)	0
Total Square Footage	1,888
Basement	FULL
Central Heat/Air Cond	CENTRAL HEAT

Heating System Type
 Heating Fuel Type GAS
 Number of Fireplaces(Masonry) 0
 Number of Fireplaces(Prefab)

Current Year Special Assessments

41100-MCD/AP MCD/AQUIFER PRES SUBD	\$1.00
11777-APC FEE	\$303.75

Current Year Rollback Summary

Non Business Credit	-\$155.14
Owner Occupancy Credit	\$0.00
Homestead	\$0.00
City of Dayton Credit	\$0.00
Reduction Factor	-\$538.34

Tax Summary

Year	Prior Year	Prior Year Payments	1st Half Due 2/15/2019	1st Half Payments	2nd Half Due 7/19/2019	2nd Half Payments	Total Currently Due
2018	\$0.00	\$0.00	\$889.86	-\$889.86	\$888.85	\$0.00	\$888.85

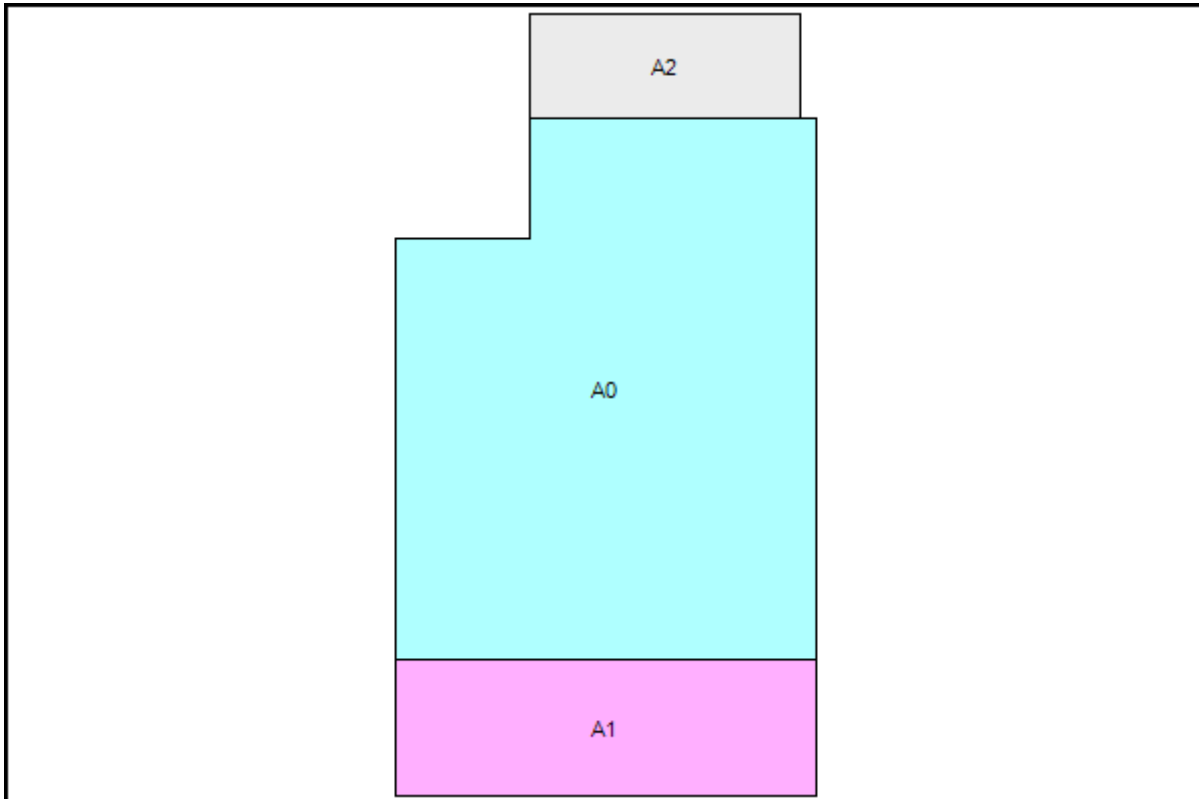

PARID: I39 00107 0053
PARCEL LOCATION: 5309 HUBERVILLE AVE

NBHD CODE: 34000000

Residential Property Data

Building Style	OLD STYLE
Exterior Wall Material	FRAME
Number of Stories	2
Year Built	1923
Total Rooms	5
Bedrms	3
Baths	1
Half Baths	0
Square Feet of Living Area	1,888
Finished Basement Sq. Ft.	0
Rec. Room Sq. Ft.	0
Total Square Footage	1,888
Basement	FULL
Central Heat/Air Cond	CENTRAL HEAT
Heat System	
Heating Fuel Type	GAS
Number of Fireplaces(Stacked)	0
Number of Fireplaces(Prefab)	

PARID: I39 00107 0053
PARCEL LOCATION: 5309 HUBERVILLE AVE

NBHD CODE: 34000000

Tax Year	Total Value
2000	107,650
2001	107,650
2002	102,280
2003	102,280
2004	102,280
2005	112,460
2006	112,460
2007	112,460
2008	94,900
2009	94,900
2010	94,900
2011	87,060
2012	87,060
2013	87,060
2014	57,480
2015	57,480
2016	57,480
2017	57,020
2018	57,020
2019	57,020 *** TENTATIVE VALUES CURRENTLY UPDATING ***

PARID: I39 00107 0011
PARCEL LOCATION: 5309 HUBERVILLE AVE

NBHD CODE: 34000000

[Click here to view neighborhood map](#)

Owner

Name
LYNNE LEIGH PROPERTIES LLC

Mailing

Name: LYNNE LEIGH PROPERTIES LLC
Mailing Address: 5165 MAD RIVER
City, State, Zip: DAYTON, OH 45429 241

Legal

Legal Description: 11 RIVERSIDE TER
TIF PENDING
Land Use Description: R - RESIDENTIAL, 0-9.999 AC
Acres: .0994
Deed:
Tax District Name: RIVERSIDE CORP-MAD RIVER LSD

Sales

Date	Sale Price	Deed Reference	Seller	Buyer
02-MAR-99	\$100,000		PATTEN LOREN II	FRITZSCHE JACK AND BARBARA
09-MAR-05		SF/D-05-022291	FRITZSCHE JACK AND BARBARA	SECRETARY OF HUD
09-MAR-05			SECRETARY OF HUD	FRIZSCHE JACK AND
16-MAR-17		201700016689	FRIZSCHE JACK AND	LYNNE LEIGH PROPERTIES LLC

Board of Revision

Tax Year	Case Number:	BTA/CPC	Result
2016	1115		No Change in Value

Values

	35%	100%
Land	2,160	6,160
Improvements	0	0
CAUV	0	0
Total	2,160	6,160

Current Year Special Assessments

41100-MCD/AP MCD/AQUIFER PRES SUBD \$1.00

Current Year Rollback Summary

Non Business Credit -\$16.80
Owner Occupancy Credit \$0.00
Homestead \$0.00
City of Dayton Credit \$0.00

Reduction Factor - \$58.24

Tax Summary

Year	Prior Year	Prior Year Payments	1st Half Due 2/15/2019	1st Half Payments	2nd Half Due 7/19/2019	2nd Half Payments	Total Currently Due
2018	\$0.00	\$0.00	\$80.75	-\$80.75	\$79.75	\$0.00	\$79.75



Sorry, no sketch available for this record

PARID: I39 00107 0011
PARCEL LOCATION: 5309 HUBERVILLE AVE

NBHD CODE: 34000000

Tax Year	Total Value
2000	5,090
2001	5,090
2002	10,010
2003	10,010
2004	10,010
2005	11,010
2006	11,010
2007	11,010
2008	10,010
2009	10,010
2010	10,010
2011	10,010
2012	10,010
2013	10,010
2014	6,160
2015	6,160
2016	6,160
2017	6,160
2018	6,160
2019	6,160 *** TENTATIVE VALUES CURRENTLY UPDATING ***

PARID: I39 00107 0014
PARCEL LOCATION: 5309 HUBERVILLE AVE

NBHD CODE: C3300000

[Click here to view neighborhood map](#)

Owner

Name

LYNNE LEIGH PROPERTIES LLC

Mailing

Name LYNNE LEIGH PROPERTIES LLC
Mailing Address 5165 MAD RIVER
City, State, Zip DAYTON, OH 45429 241

Legal

Legal Description 14 RIVERSIDE TER
Land Use Description C - COMMERCIAL VACANT LAND
Acres .1019
Deed 1999-00017D001
Tax District Name RIVERSIDE CORP-MAD RIVER LSD

Sales

Date	Sale Price	Deed Reference	Seller	Buyer
02-MAR-99	\$100,000		PATTEN LOREN II	FRITZSCHE JACK AND BARBARA
16-MAR-17		201700016689	FRITZSCHE JACK AND BARBARA	LYNNE LEIGH PROPERTIES LLC

Board of Revision

Tax Year	Case Number:	BTA/CPC	Result
2016	1115		No Change in Value

Values

	35%	100%
Land	1,670	4,770
Improvements	0	0
CAUV	0	0
Total	1,670	4,770

Current Year Special Assessments

11777-APC FEE	\$21.50
41100-MCD/AP MCD/AQUIFER PRES SUBD	\$1.00

Current Year Rollback Summary

Non Business Credit	\$0.00
Owner Occupancy Credit	\$0.00
Homestead	\$0.00
City of Dayton Credit	\$0.00
Reduction Factor	-\$23.86

Tax Summary

Year	Prior Year	Prior Year Payments	1st Half Due 2/15/2019	1st Half Payments	2nd Half Due 7/19/2019	2nd Half Payments	Total Currently Due
2018	\$0.00	\$0.00	\$90.50	-\$90.50	\$89.50	\$0.00	\$89.50



Sorry, no sketch available
for this record

PARID: I39 00107 0014
PARCEL LOCATION: 5309 HUBERVILLE AVE

NBHD CODE: C3300000

Tax Year	Total Value
2000	2,780
2001	2,780
2002	2,220
2003	2,220
2004	2,220
2005	2,220
2006	2,220
2007	2,220
2008	5,300
2009	5,300
2010	5,300
2011	4,930
2012	4,930
2013	4,930
2014	4,770
2015	4,770
2016	4,770
2017	4,770
2018	4,770
2019	4,770 *** TENTATIVE VALUES CURRENTLY UPDATING ***