

Washington County, Ohio - Property Record Card, Page 1
Parcel: 090043307000

GENERAL PARCEL INFORMATION

Owner	HUNTINGTON BANK SUCCESSOR MERGE R TO ADVANTAGE BANK
Property Address	38 TURKEY HOLLOW RD
Mailing Address	5555 CLEVELAND AVE GW1W42
Owner Address	R TO ADVANTAGE BANK TWP RD 111
Land Use	560 PLAT TR/MH AFFX
Legal Description	LOT 21 DECATUR SUBD 158.9 4X558.32X150X607.52

VALUATION

	Appraised	Assessed
Land Value	\$9,940.00	\$3,480.00
Improvements Value	\$71,340.00	\$24,970.00
Total Value	\$81,280.00	\$28,450.00
CAUV Value	\$0.00	\$0.00
Taxable Value	\$28,450.00	

LAND

Description	Acreage	Front	Effective	Depth	Depth Factor	Actual Value
HOMESITE	1		0	0	0	5350
TILL/PASTURE	1.06		0	0	0	1650

SALES

Sale Number	Sale Date	Sale Price	Sale Type	Buyer
950	10/19/2017	50324	1SH	HUNTINGTON BANK
	8/12/2014	0	1QC	KNAPP JOSHUA K
0001006	9/5/2002	12700	1WD	PHILLIPS AMY R & KNAPP
0000806	8/6/1999	0	6QC	ADAMS WAYNE E JR
0000263	3/17/1999	1200	4WD	ADAMS WAYNE E JR &
0000898	8/21/1998	0	4WD	SETTLE LEE R
0000798	7/20/1998	0	4QC	PARKER PATRICIA J
0000410	4/10/1996	0	4WD	PARKER PATRICIA J &
0000616	6/16/1995	0	4ED	PARKER PATRICIA J
0000450	5/12/1995	42000	4WD	PARKER HAROLD Z &

MAP



AGRICULTURAL

Soil Code	Acreage
-----------	---------

TAX

Gross Charge	\$1,543.50
Reduction Factor	(\$299.14)
10% Rollback	(\$108.72)
2.5% Homesite Rollback	\$0.00
Homestead Reduction	\$0.00
Penalties And Adjustments	\$0.00
Net Annual Tax	\$1,135.64

Washington County, Ohio - Property Record Card, Page 2

Parcel: 090043307000

Card: 0

GENERAL PARCEL INFORMATION	
Owner	HUNTINGTON BANK SUCCESSOR MERGE R TO ADVANTAGE BANK
Property Address	38 TURKEY HOLLOW RD
Mailing Address	5555 CLEVELAND AVE GW1W42
Owner Address	R TO ADVANTAGE BANK TWP RD 111
Land Use	560 PLAT TR/MH AFFX
Legal Description	LOT 21 DECATUR SUBD 158.9 4X558.32X150X607.52

VALUATION		
	Appraised	Assessed
Land Value	\$9,940.00	\$3,480.00
Improvements Value	\$71,340.00	\$24,970.00
Total Value	\$81,280.00	\$28,450.00
CAUV Value	\$0.00	\$0.00
Taxable Value	\$28,450.00	

IMPROVEMENTS						
Building Type	SHB	Area	Rate	Grade	Year Built	Value
MH/RE	1 C F	1104	0	C	2002	\$71,340.00
PP/SHED	+NV F	144	0		2002	\$0.00

RESIDENTIAL	
Year Built	2002
Number of Stories	1
Total Living Area	1104
Total Rooms:	6
Total Bedrooms	3
Total Baths	2
Total Family Rooms	0

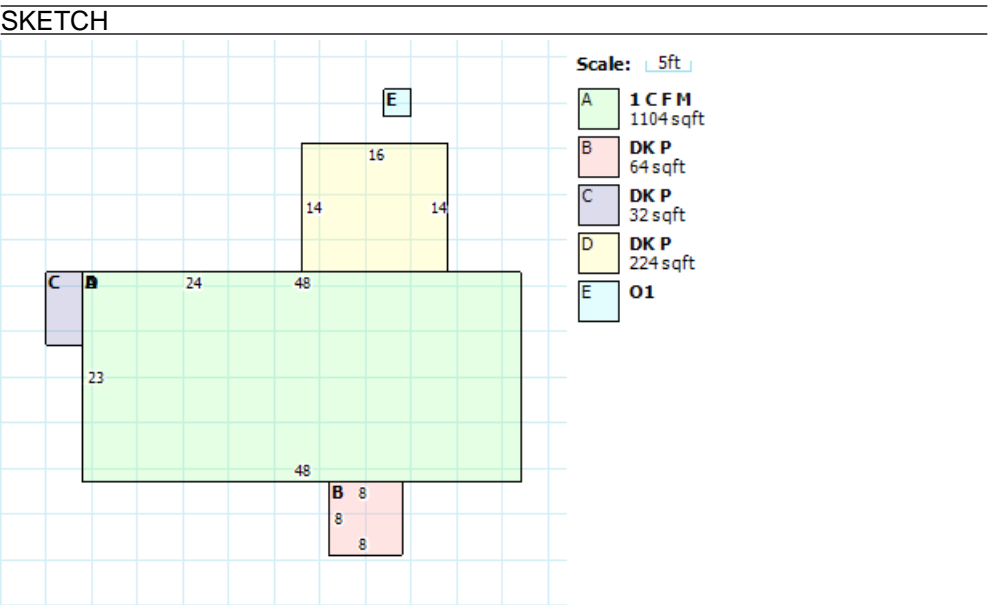

RESIDENTIAL DETAIL					
	Basement	First Fl	Partial Upper Fl	Full Upper Fl	Attic
Area (F/Un)	0/0	1104	0	0	0/0
Value	\$5,300.00	\$53,600.00	\$0.00	\$0.00	\$0.00
Plaster/Drywall		X			
Paneling					
Fiberboard					
Unfinished					
Wood Joist					
Fire-Resist					
Fire-Proof					
Hardwood					
Pine					
Carpet					
Concrete					
Tile/Linoleum					
Rooms	0	6	0	0	0
Bedrooms	0	3	0	0	0
Family Rooms	0	0	0	0	0
Dining Rooms	0	0	0	0	0
Insulation					
Central Air	A				
Heat Pump					
Central Heat	A				
Plumbing	0	1	0	0	0