

Property Information		
Property Number	26-03295.000	Property Address: 64811 NELAN RD Tax Payer Address: HUNTINGTON NATIONAL BANK 5555 CLEVELAND AVE COLUMBUS OH 43231 USA
Owner Name	HUNTINGTON NATIONAL BANK	
Owner Address	5555 CLEVELAND COLUMBUS OH 43231	
Tax Set	26 PULTNEY TWP - BELLAIRE LSD	
School District	702 BELLAIRE LSD	
Neighborhood	60000 BELLAIRE SCHOOL DISTRICTS	
Use Code	511 1-family unplatted 0-09.99 acs.	
Acres	.86000	
Description		
R3 T5 S6 NW NE NEW SURVEY .8629AC		

		Current Value		Recent Transfer	
Board of Revision	N	Mkt Land Value	\$9,040	Valid Sale	N
Homestead/Disability	Y	CAUV	\$0	# Parcels	1
2.5% Reduction	Y	Mkt Impr Value	\$91,780	Deed Type	119
Divided Property	N	Total	\$100,820	Amount	\$21,333
New Construction	N	Current Tax		Sale Date	1/3/2018
Foreclosure	N	Annual Tax *	\$1,162.70	Conveyance/Deed	17
Other Assessments	Y	Paid **	\$584.04	Map #	13.00
Front Ft.	0	Delq	\$0.00		

<< Previous Card Card 1 of 1 Next Card >>

Dwelling Information					
Sq Ft Finished	2036	Room Count	8	Fireplace(s)	0
1st Floor Area	2036	Story Height	1	Year Built	2007
Upper Floor Area	0	# Bedrooms	5	Year Remodeled	0
Half Story Area	0	Full Baths	2	Grade	D-5
Attic Area	0	Half Baths	0	Style	Modular
Finished Basement	0	Heating	Forced Air	Ext Walls	VIN/ALUM - FRAME
Basement Type	Crawl	Air Cond	Central Air		

Land								
Land Type	Acres	Square Ft.	Actual Frontage	Eff. Frontage	Depth	No Of Units	Adjusted Rate	Value
FAFractional Acreage [FRACT]	0.86	0	0.00	0.00		0	\$9,520	\$8,220

CAUV Land Lines

No CAUV Land On This Parcel

Card - 1

Improvements				
IMPR Type	Description	Area	Year Built	Value
Addition	DECK DECK	270 SQ FT		\$4,600

Card - 1

Property Sketch -- Card 1

Property Sketch

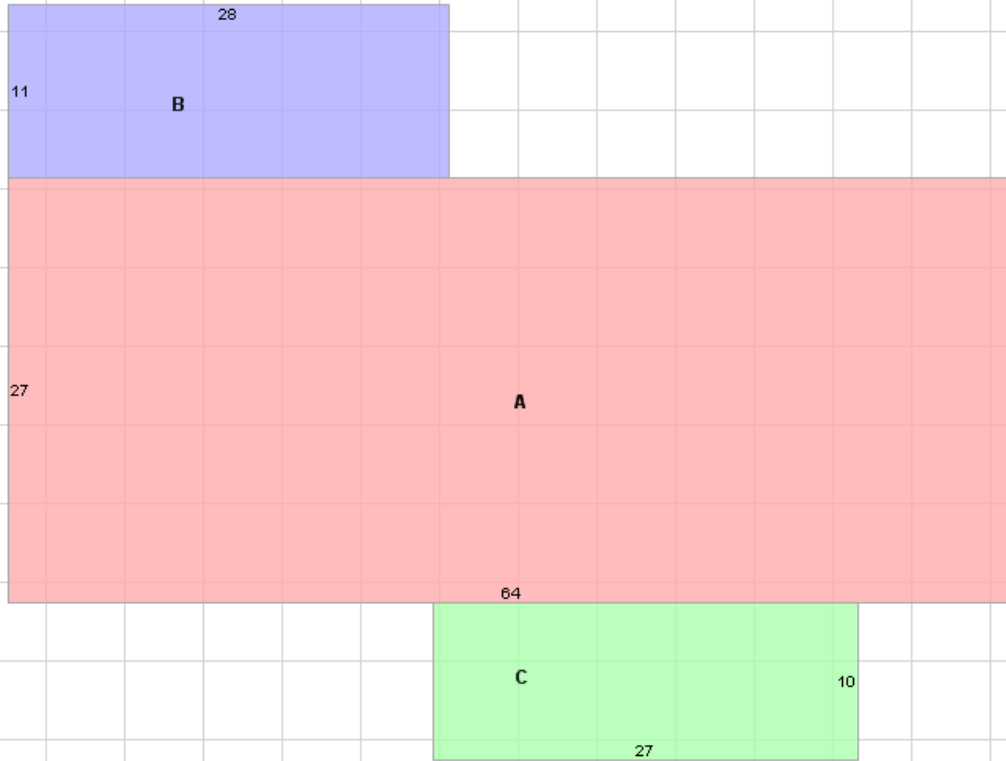

0.062s

Scale: 5 ft

ID	Label	Area	Perimeter	Dimension
A	$\frac{1 s Fr}{C}$	1728	182	N/A
B	$\frac{1 s Fr}{C}$	308	78	N/A
C	DECK	270	74	N/A

Print Version