

**Owner** G&Z DEVELOPMENT, LLC.  
**Address** 425 E 264 ST  
 EUCLID, OH. 44132  
**Land Use** (5100) R - 1-FAMILY PLATTED LOT  
**Legal Description** 20 EUCSHORE 0047 ALL  
**Neighborhood Code** 14103

### SKETCH

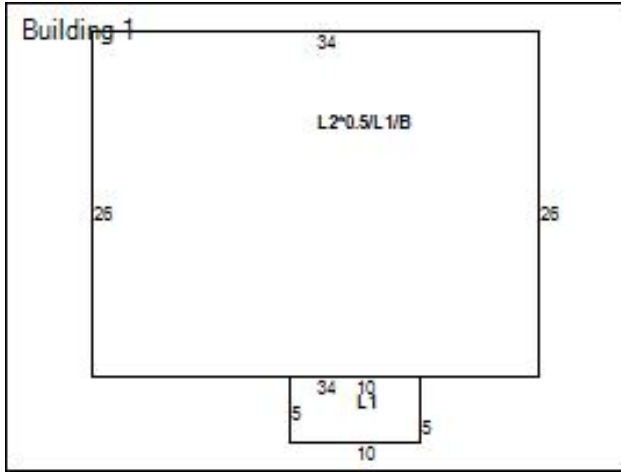

### MAP VIEW



### BUILDING INFORMATION

Building Record Number	1	Occupancy	1-FAMILY	Story Height	1.5
Style	CAPE COD	Year Built	1950	Exterior Walls	ALUM/VINYL
Condition	AVERAGE	Construction Quality	C+ / AVERAGE+	Roof Type	GABLE
Roof Material	ASPH-SHINGLE	Heat Type	FORCED-AIR	Air Conditioning	NONE
Attic Type	NONE	Basement Type	BASEMENT	Basement Square Feet	884
Basement Finished	No	Rooms	6	Bedrooms	2
Bathrooms (Full/Half)	1/0	Garage Type	DETACHED	Garage Capacity	1
Year Garage Built	1950	Garage Size	280	Living Area Basement	
Living Area 1	934	Living Area 2	442	Living Area Upper	
Living Area Total	1,376	Floor Location		Party Wall	

### LAND

Code	Frontage	Depth	Acreage	Sq Ft
PRM	50	100	0.12	5,000

### VALUATION

2017 Values	Taxable Market Value	Exempt Market Value	Abated Market Value	Assessed Taxable Value
Land Value	\$12,100	\$0	\$0	\$4,240
Building Value	\$56,500	\$0	\$0	\$19,780
Total Value	\$68,600	\$0	\$0	\$24,020
Land Use	5100			SINGLE FAMILY DWELLING

### PERMITS

Tax Year	Reason	Tax Change	Exempt Change	Percent Complete	Reinspect	Notes
----------	--------	------------	---------------	------------------	-----------	-------

### IMPROVEMENTS

Type	Description	Size	Height Depth
------	-------------	------	--------------

### SALES

Date	Buyer	Seller	Price
4/22/2010	G&Z DEVELOPMENT, LLC.	FANNIE MAE	\$31,000
11/4/2009	FANNIE MAE	Mars, Michael T.	\$18,000
6/18/2002	Mars, Michael T.	Gregor, Florence E.	\$95,000
5/5/1997	Gregor, Florence E.	Crowley, Jeannette E.	\$0
6/17/1994	Crowley, Jeannette E.	Petrovic Louis J	\$77,000
10/26/1992	Petrovic Louis J	Petrovic, Mary	\$0
8/19/1992	Petrovic, Mary	Petrovic Louis & Mary	\$0
7/30/1975	Petrovic Louis & Mary	Petrovic Louis & Mary	\$0
1/1/1975	Petrovic Louis & Mary		\$0

### Taxes

2017 Taxes	Charges	Payments	Balance Due
Tax Balance Summary	\$22,471.86	\$0.00	\$22,471.86

