

Wood County, Ohio - Property Record Card, Page 1

Parcel: Q61-000-903107050000

GENERAL PARCEL INFORMATION

Owner LUTZ GILBERT E & ELIDA
Property Address 980 MAPLE ST
Mailing Address 2637 CRAWFORD AVE
 EVANSTON IL 60201
Land Use 510 - SINGLE FAMILY DWLG
Neighborhood 59031
School District PERRYSBURG EVSD
Total Acres 0.4371
Legal Description OUTLOT 128 N'LY 70' S'LY 490'

VALUATION

	Appraised	Assessed
Land Value	\$36,200.00	\$12,670.00
Improvements Value	\$99,300.00	\$34,760.00
CAUV Value	\$0.00	\$0.00
Taxable Value	\$47,430.00	

LAND

Land Type	Acreeage	Depth	Frontage	Depth Factor	Value
L1 - Regular Lot	0.4371	272	70	115	36230

AGRICULTURAL

Land Type	Land Usage	Soil Type	Acres	Value

TAX

	1st Half	2nd Half
Charge:	\$2,352.05	\$2,352.05
Credit:	(\$835.73)	(\$835.73)
Rollback:	(\$140.83)	(\$140.83)
Reduction:	(\$34.67)	(\$34.67)
Homestead:	(\$247.26)	(\$247.26)
Sales Credit:	\$0.00	\$0.00
CAUV Recoupment:	\$0.00	\$0.00
Special Assessments:	\$12.06	\$12.05
Penalties/Adjustments:	\$0.00	\$0.00
Delinquencies:	\$0.00	\$0.00
Net Owed:		\$2,135.51
Net Paid:		(\$1,105.62)
Net Due:		\$1,029.89

PAYMENTS

Payment Date	Prior Paid	First Half Paid	Second Half
2/1/2018	\$0.00	\$1.55	\$0.00
2/1/2018	\$0.00	\$1,093.56	\$0.00
2/1/2018	\$0.00	\$0.05	\$0.00
2/1/2018	\$0.00	\$0.06	\$0.00
2/1/2018	\$0.00	\$5.58	\$0.00
2/1/2018	\$0.00	\$0.02	\$0.00
2/1/2018	\$0.00	\$4.80	\$0.00
6/26/2017	\$0.00	\$0.00	\$0.05
6/26/2017	\$0.00	\$0.00	\$0.02
6/26/2017	\$0.00	\$0.00	\$0.06
6/26/2017	\$0.00	\$0.00	\$5.88

MAP



SALES

Date	Buyer	Seller	Price
6/7/1976	LUTZ GILBERT E		\$23,500.00

Wood County, Ohio - Property Record Card, Page 2

Parcel: Q61-000-903107050000

Card: 1

GENERAL PARCEL INFORMATION

Owner LUTZ GILBERT E & ELIDA
 Property Address 980 MAPLE ST
 Mailing Address 2637 CRAWFORD AVE
 EVANSTON IL 60201
 Land Use 510 - SINGLE FAMILY DWLG
 Neighborhood 59031
 School District PERRYSBURG EVSD
 Total Acres 0.4371
 Legal Description OUTLOT 128 N'LY 70' S'LY 490'

RESIDENTIAL

Building Style BI-LEVEL
 Year Built 1960
 Stories 2
 Finished Area 2080
 First Floor Area 1040
 Half Floor Area 0
 Upper Floor Area 1040
 Rooms 9
 Bedrooms 3
 Family Rooms 1
 Full Baths 2
 Half Baths 0
 Basement NONE
 Finished Basement Area 0
 Heating BASE
 Cooling NONE
 Exterior Wall SIDING W/MASONRY 1
 Attic NONE
 Number of Fireplace Openings 0
 Number of Fireplace Stacks 0

COMMERCIAL

SKETCH

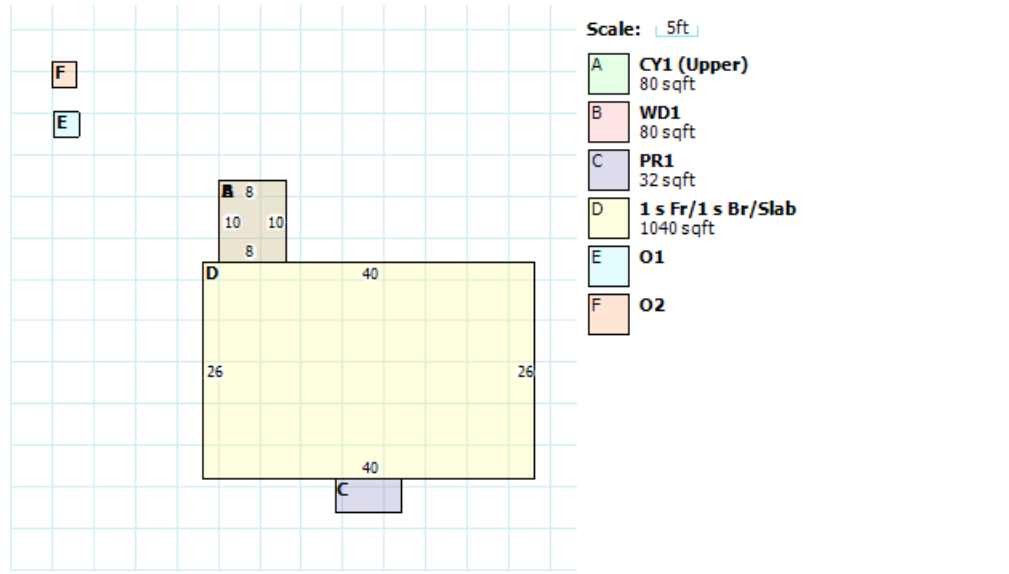

IMPROVEMENTS

Description	Year Built	Dimensions	Area	Value
Garage Frame - 1	2003	28x26	728	\$11,450.00
Garage Frame - 1	1960	22x22	484	\$2,070.00

ADDITIONS

Description	Area	Year Built	Value
WD1 - Wood Deck	80	0	\$1,600.00
PR1 - Porch Frame - Open	32	0	\$1,470.00
CY1 - Canopy Frame	80	0	\$680.00