

Owner IMARS, CHARLES J.
 Address 13200 COUNTY LINE RD
 HUNTING VALLEY, OH. 44022
 Land Use (5100) R - 1-FAMILY PLATTED LOT
 Legal Description 1 9 0002
 Neighborhood Code 11201

SKETCH

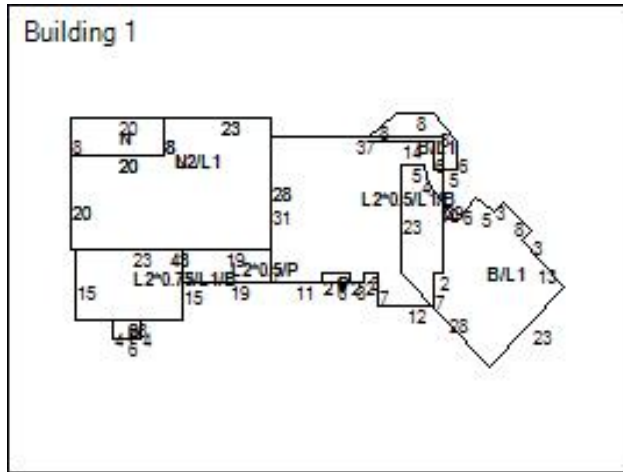

MAP VIEW



BUILDING INFORMATION

Building Record Number	1	Occupancy	1-FAMILY	Story Height	2
Style	COLONIAL	Year Built	1995	Exterior Walls	BRICK
Condition	EXCELLENT	Construction Quality	AA / EXCELLENT+	Roof Type	GABLE
Roof Material	SLATE	Heat Type	FORCED-AIR	Air Conditioning	CENTRAL
Attic Type	NONE	Basement Type	BASEMENT	Basement Square Feet	1,299
Basement Finished	N/A	Rooms	8	Bedrooms	3
Bathrooms (Full/Half)	3/1	Garage Type	BASEMENT	Garage Capacity	4
Year Garage Built	1995	Garage Size	1,204	Living Area Basement	
Living Area 1	3,502	Living Area 2	1,960	Living Area Upper	
Living Area Total	5,462	Floor Location		Party Wall	N

LAND

Code	Frontage	Depth	Acreage	Sq Ft
WET	483	600	4.17	181,649

VALUATION

2017 Values	Taxable Market Value	Exempt Market Value	Abated Market Value	Assessed Taxable Value

PERMITS

Tax Year	Reason	Tax Change	Exempt Change	Percent Complete	Reinspect	Notes

IMPROVEMENTS

Type	Description	Size	Height Depth

SALES

Date	Buyer	Seller	Price
12/1/2006	IMARS, CHARLES J.	DUNN, GEORGE J SUC-TRS	\$0
3/12/2003	DUNN, GEORGE J SUC-TRS	Ward, Helene M Trustee	\$0
12/1/2000	Ward, Helene M Trustee	Ward, Helen I	\$0
1/1/1995	Ward, Helen I		\$0

Taxes

2017 Taxes	Charges	Payments	Balance Due
Tax Balance Summary	\$108.58	\$0.00	\$108.58