

Clark County, Ohio - Property Record Card

Parcel: 3400700033200002 Card: 1

Owner TRITLE GERALD & JENNIFER,
Address 115 RICE ST SPRINGFIELD 45505
Tax/School District 340 / SPRINGFIELD CSD
Land Use (520) TWO FAMILY, PLATTED LOT
Class RESIDENTIAL
Legal Description THOMAS CASTILLO ASSIGNEE E END 6854

MAP



SKETCH

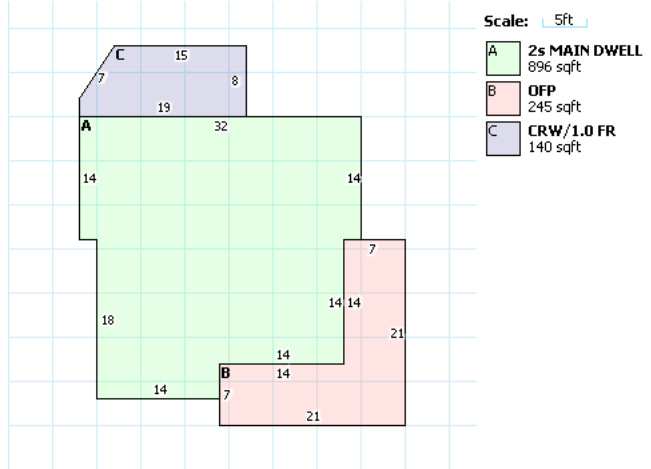

RESIDENTIAL

Building Style	DUPLEX	FullBaths	2	Owner/Occupied Credit:	NO
Total Living Area	1932	Half Baths	0	Homestead Credit:	NO
Year Built	1905	Basement	FULL	Special Assessment:	NO
Stories	2	Finished Basement Area	0		
Exterial Wall	FRAME	Rec Room Area	0		
Rooms	8	Heat Fuel Type	GAS		
Bedrooms	3	Heat/Cool	CENTRAL		
Family Rooms	0	Attic	NONE		
Fireplace Openings(Stacks)	0(0)	Trim	0		

LAND

Code	Frontage	Depth	Acreage	SqFt	Value
1	40	50	N/A	N/A	\$1,440.00

VALUATION

	Appraised	Assessed
Land Value	\$1,440.00	\$500.00
Building Value	\$20,170.00	\$7,060.00
Total Value	\$21,610.00	\$7,560.00
CAUV Value		\$0.00
Taxable Value		\$7,560.00
Net Annual Tax		\$443.70

PERMITS

IMPROVEMENTS

SALES

Date	Buyer	Seller	Price	Validity
7/31/2002	TRITLE GERALD & JENNIFER	MC NAMARA JAMES E & CYNTHIA A	\$28,000.00	
7/31/2002			\$13,000.00	

