

Clark County, Ohio - Property Record Card

Parcel: 0100600033000009 Card: 1

Owner DARBYSHIRE DURAND L & LARRY D,
Address 623 S TECUMSEH RD SPRINGFIELD 45506
Tax/School District 010 / TECUMSEH LSD
Land Use (511) SINGLE FAMILY, 0-9.999 AC UNPLATTE
Class RESIDENTIAL
Legal Description PT N W QR SEC 27 & N E QR SEC 33 (LOT 5)

MAP



SKETCH

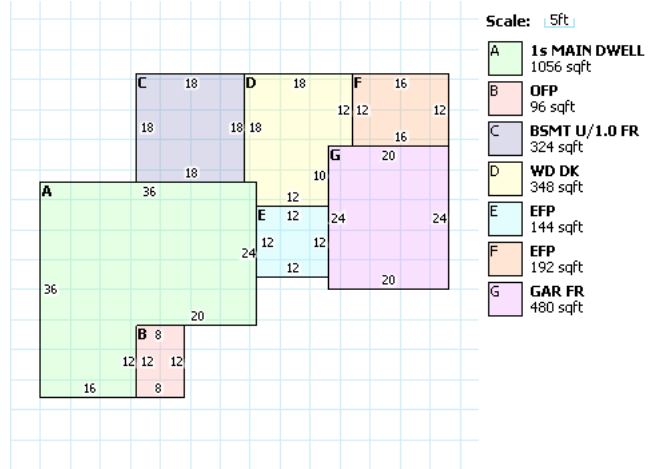

RESIDENTIAL

Building Style	RANCH	FullBaths	1	Owner/Occupied Credit:	YES
Total Living Area	1380	Half Baths	0	Homestead Credit:	NO
Year Built	1953	Basement	FULL	Special Assessment:	NO
Stories	1	Finished Basement Area	0		
Exterial Wall	ALUMINUM/VINYL	Rec Room Area	0		
Rooms	5	Heat Fuel Type	GAS		
Bedrooms	2	Heat/Cool	CENTRAL		
Family Rooms	1	Attic	NONE		
Fireplace Openings(Stacks)	0(0)	Trim	0		

LAND

Code	Frontage	Depth	Acreage	SqFt	Value
1	0	0	0.63	N/A	\$21,580.0
9	0	0	0.06	N/A	\$0.00

VALUATION

	Appraised	Assessed
Land Value	\$21,580.00	\$7,550.00
Building Value	\$76,070.00	\$26,620.00
Total Value	\$97,650.00	\$34,170.00
CAUV Value		\$0.00
Taxable Value		\$34,170.00
Net Annual Tax		\$1,899.12

PERMITS

IMPROVEMENTS

Card	Description	Year Built	Dimensions	Value
1	RG1 - FRAME	1953	24x20	\$2,790.00
1	PR2 - PORCH,	1953	12x16	\$2,110.00

SALES

Date	Buyer	Seller	Price	Validity
1/27/2016	DARBYSHIRE DURAND L & LARRY D	DARBYSHIRE ROBERT L & MELVA K	\$0.00	
1/1/1986	DARBYSHIRE ROBERT L & MELVA K	TAYLOR EDWARD W	\$47,500.00	
12/1/1983			\$0.00	

