

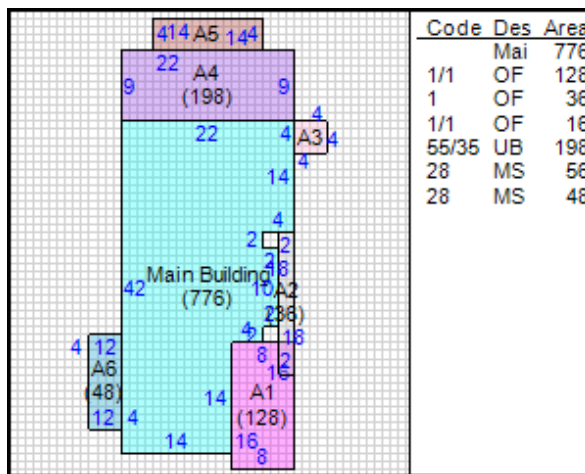

Clark County GIS - John S. Federer
 (937) 521-1860 - gis@clarkcountyohio.gov

Report generated: Tuesday, February 20, 2018

Parcel Report



Base Data

Parcel Number: 3400600004104014
Owner Name: MCWHORTER GERARD
Property Address: 1238-1238 1/2 W HIGH ST,
 SPRINGFIELD 45506

Legal

Neighborhood: 340R0007 **Legal Acres:** 0.00
Legal Description: N SI HIGH 25 E OF ISABELLA **Land Use:** 520
Map Number: 0004-01
Property Class: R

Valuation

	Appraised	Assessed (35%)
Land Value:	\$4,180.00	\$1,460.00
Building Value:	\$4,660.00	\$1,630.00
Total Value:	\$8,840.00	\$3,090.00
CAUV Value:	\$0.00	
Taxable Value:	\$3,090.00	

Tax Credits

Homestead Exemption: No
2.5% Reduction: No

Land

Description	Effective Lot Size	Act. Frontage	Acres	Sq. Foot	Value
REGULAR LOT	37 * 111	39.5	0.094	4,107	\$4,180.00

Land Totals

Effective Total Acres 0.094
Effective Total Square Footage 4,107
Total Value \$4,180.00

Valuation

	Appraised	Assessed (35%)
Land Value:	\$4,180.00	\$1,460.00
Building Value:	\$4,660.00	\$1,630.00
Total Value:	\$8,840.00	\$3,090.00
CAUV Value:	\$0.00	
Taxable Value:	\$3,090.00	

Sales

Sale Date	Sale Price	Seller	Buyer	Current Deed	Number of Parcels
01/26/2015	\$7,000.00	LAGOS PROPERTIES INC	MCWHORTER GERARD	340/5171	1
10/17/2011	\$1,000.00	GRAUL WILLIAM	LAGOS PROPERTIES INC	340/5171	1
02/01/2007	\$4,000.00	G B RENTAL PROPERTIES	GRAUL WILLIAM	340/5171	
07/01/1984	\$500.00	LAGOS HARRY	G B RENTAL PROPERTIES	340/5171	
05/01/1983	\$3,300.00				

Residential

Card: 1
Number of Stories: 2
Style: Duplex
Year Built: 1891
Year Remodeled:
Total Number of Rooms: 8
Number of Bedrooms: 4
Number of Full Baths: 2
Number of Half Baths:
Number of Family Rooms: 0
Basement: Full BSMT
Exterior Wall: FRAME
Heating System Type: HOT AIR
Heat: CENTRAL HEAT
Attic: None
Heating Fuel Type: GAS
Grade: D
Ground Floor Area: 974
Total Living Area: 1,750
Unfinished Area:
Recreation Room Area:
Finished Basement Area:
Brick/Stone Trim:
Fireplace Stacks:
Fireplace Openings:
PreFab Fireplaces:
Percent Complete:

Photos



Sketches

